

**NOTE:**  
 Substrate to comply with current  
 Viking Roofspec Masterspec  
 specification  
 Substrate Checksheet available  
 from [www.vikingroofspec.co.nz](http://www.vikingroofspec.co.nz)

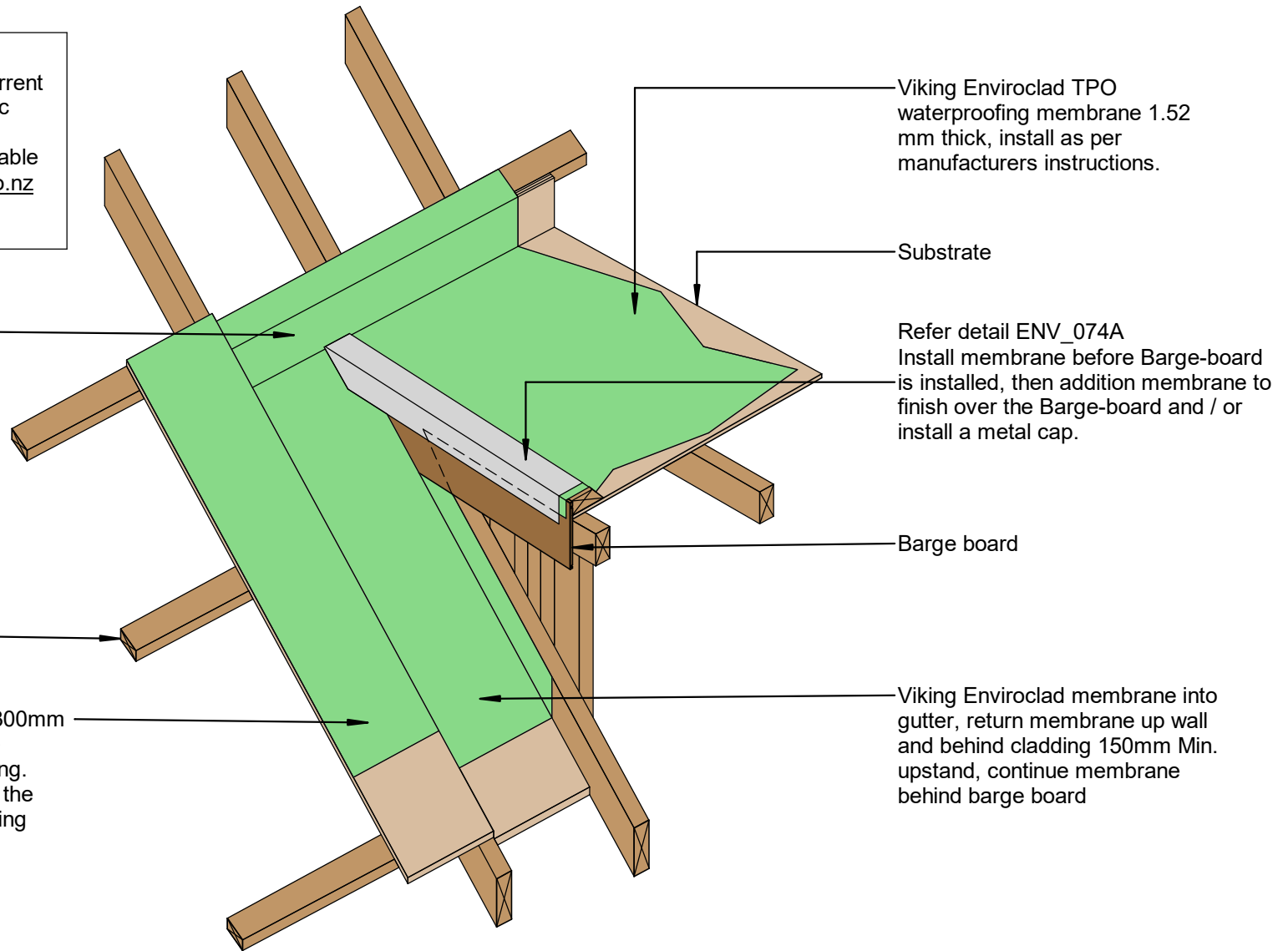

Refer detail ENV\_070

Viking Enviroclad TPO  
 waterproofing membrane 1.52  
 mm thick, install as per  
 manufacturers instructions.

Substrate

Refer detail ENV\_074A  
 Install membrane before Barge-board  
 is installed, then addition membrane to  
 finish over the Barge-board and / or  
 install a metal cap.

Barge board

Purlin over trusses

Continue membrane onto a 300mm  
 wide flood-board down to the  
 bottom drip-edge and Spouting.  
 Form a hemmed edge along the  
 membrane, under metal roofing

Viking Enviroclad membrane into  
 gutter, return membrane up wall  
 and behind cladding 150mm Min.  
 upstand, continue membrane  
 behind barge board

DRAWING TITLE

Viking Enviroclad  
 Roof Junction\_Dormer ISO

NOTES:

\* Angle fillets are not required at  
 upstands for Enviroclad  
 \* All fixings, cladding and structure are  
 indicative only unless notated



Enviroclad  
 systems are  
 CodeMarked

DRAWING

INFORMATION ONLY

Scale:	Date:	Drawn:	Viking
Not to Scale	23/11/2020		

Detail Ref: **VIK\_ENV\_074\_RJUNDORM**