

**STEP 1**

Apply Viking SMT076V Laptape to corner as shown.

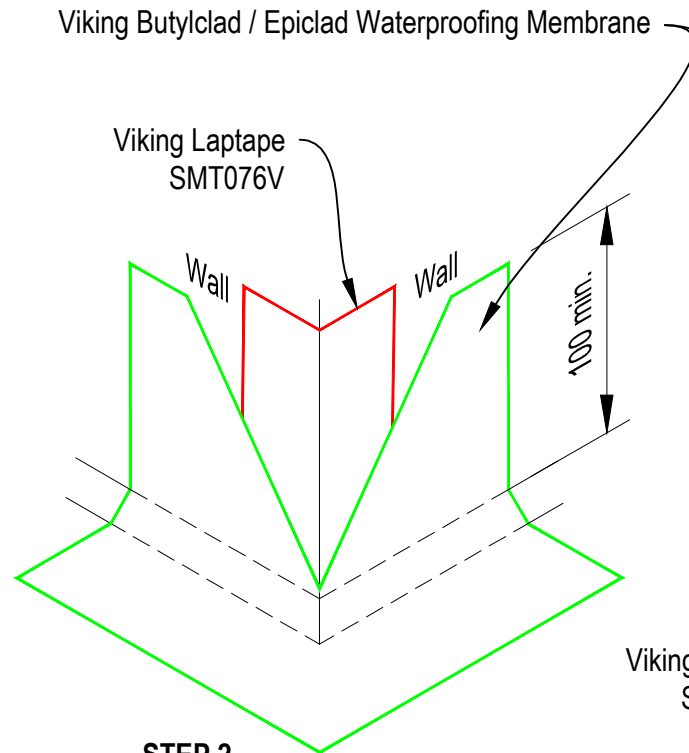

**STEP 2**

Take membrane up wall min. 100mm and cut on 45° angle to corner (above the fillet)

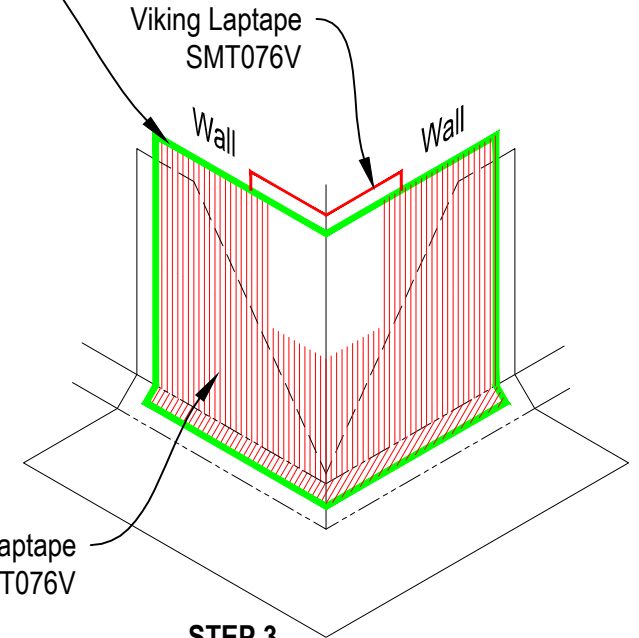

**STEP 3**

Flash over with a piece of same membrane using SMT076 Laptape to join rubber to rubber

**NOTE:**

As per E2/AS1 Figure 57



DRAWING TITLE
BE15 Butylclad / Epiclad External Corner

NOTES:
1/ Substrate Indicative Only 2/ All external corners / edges require 5mm min. radius

DRAWING STATUS		
INFORMATION ONLY		
Not to Scale	DATE 29/3/2016	Detail Ref.
DRAWN	Viking	BE15      A
SERIES	1.10	