

NOTE:
Sheet laps may also run in the direction of fall

Head to Toe Lap

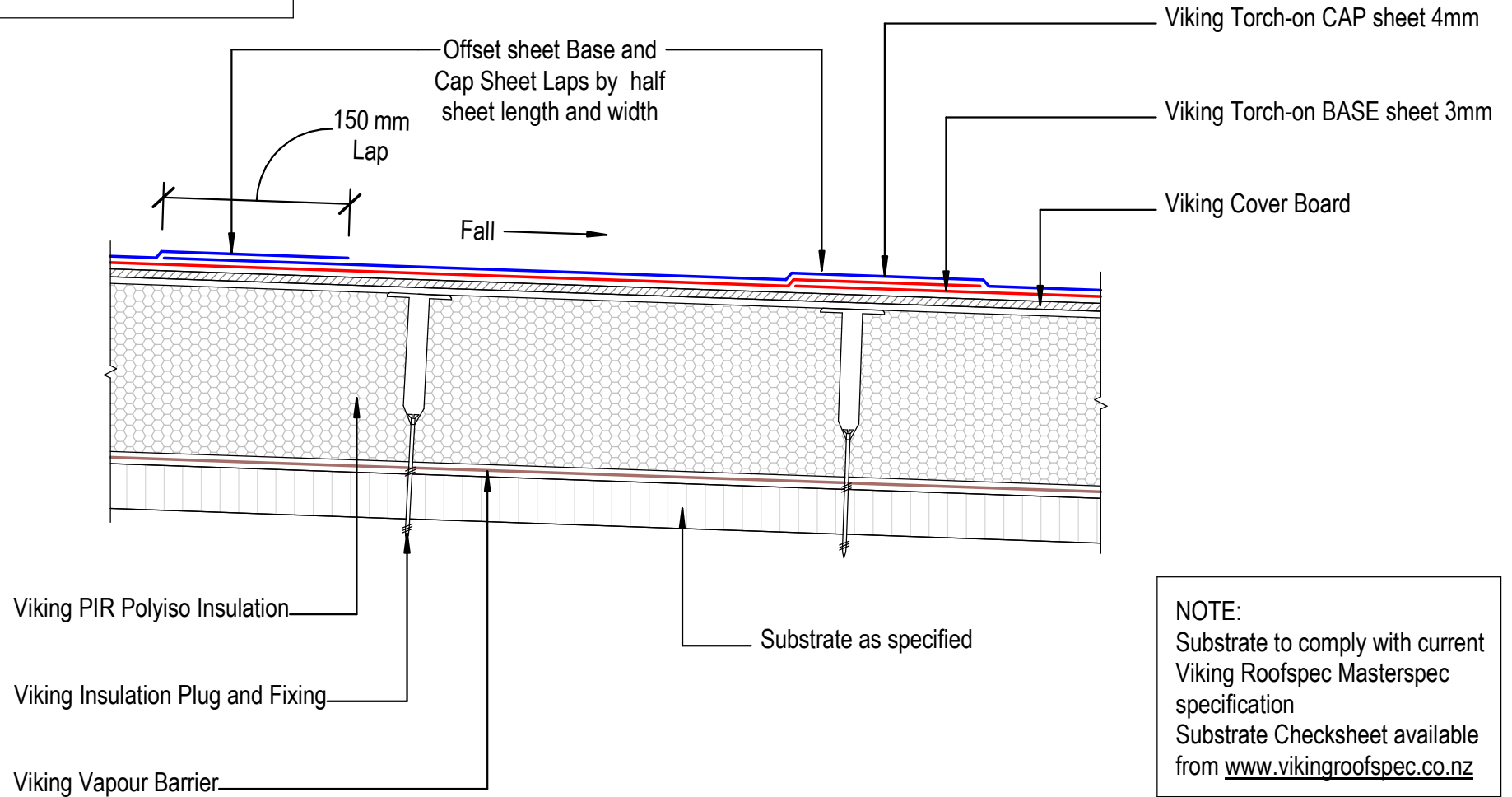

NOTE:
Substrate to comply with current Viking Roofspec Masterspec specification
Substrate Checksheet available from www.vikingroofspec.co.nz

DRAWING TITLE

Viking WS2 - Torch-On
Intersection_Sheet Lap

NOTES:

*Viking Waterproof Membrane as notated can be Viking Gemini, Lybra, Phoenix Super or Halley P.
*All details to be read in conjunction with Viking Specifications.

Substrate and structure are indicative only

DRAWING STATUS

INFORMATION ONLY

Scale: Not to Scale	Date: 01/10/2022	Drawn: Viking
Detail Ref: VIK_WS2_TOR_066_INTSSHEL		

