

Viking Torch-On  
2 Layer Membrane System

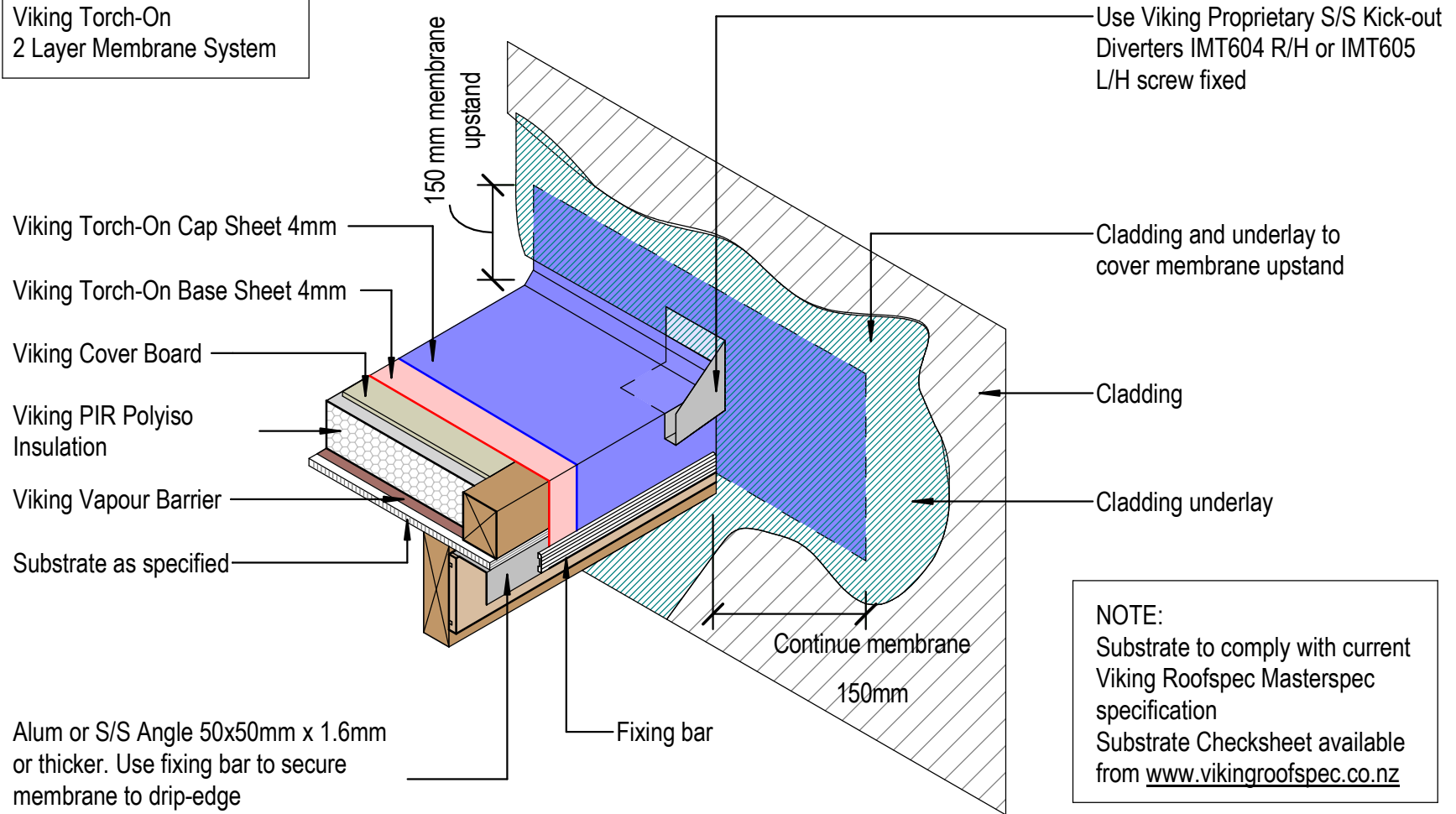

**NOTE:**  
Substrate to comply with current Viking Roofspec Masterspec specification  
Substrate Checksheet available from [www.vikingroofspec.co.nz](http://www.vikingroofspec.co.nz)

DRAWING TITLE

Viking WS2 - Torch-On  
Verge\_edge with wall continuing, Diverter for cladding

NOTES:

\*Viking Waterproof Membrane as notated can be Viking Gemini, Lybra, Phoenix Super or Halley P.  
\*All details to be read in conjunction with Viking Specifications.

Substrate and structure are indicative only

DRAWING STATUS

INFORMATION ONLY

Scale: Not to Scale	Date: 01/10/2022	Drawn: Viking
Detail Ref: <b>VIK_WS2_TOR_033_VERGEDGE</b>		