

**NOTE:**  
 Substrate to comply with current  
 Viking Roofspec Masterspec  
 specification  
 Substrate Checksheet available  
 from [www.vikingroofspec.co.nz](http://www.vikingroofspec.co.nz)

Viking Enviroclad TPO  
 waterproofing membrane 1.52  
 mm thick, install as per  
 manufacturers instructions

Viking 200x80mm TPO overflow  
 scupper STP604, installed as per  
 manufacturers instructions.

Viking PIR Polyiso Insulation

Viking Vapour Barrier, install as  
 per manufacturers instructions

Substrate

Insulation to close off  
 thermal break 300mm

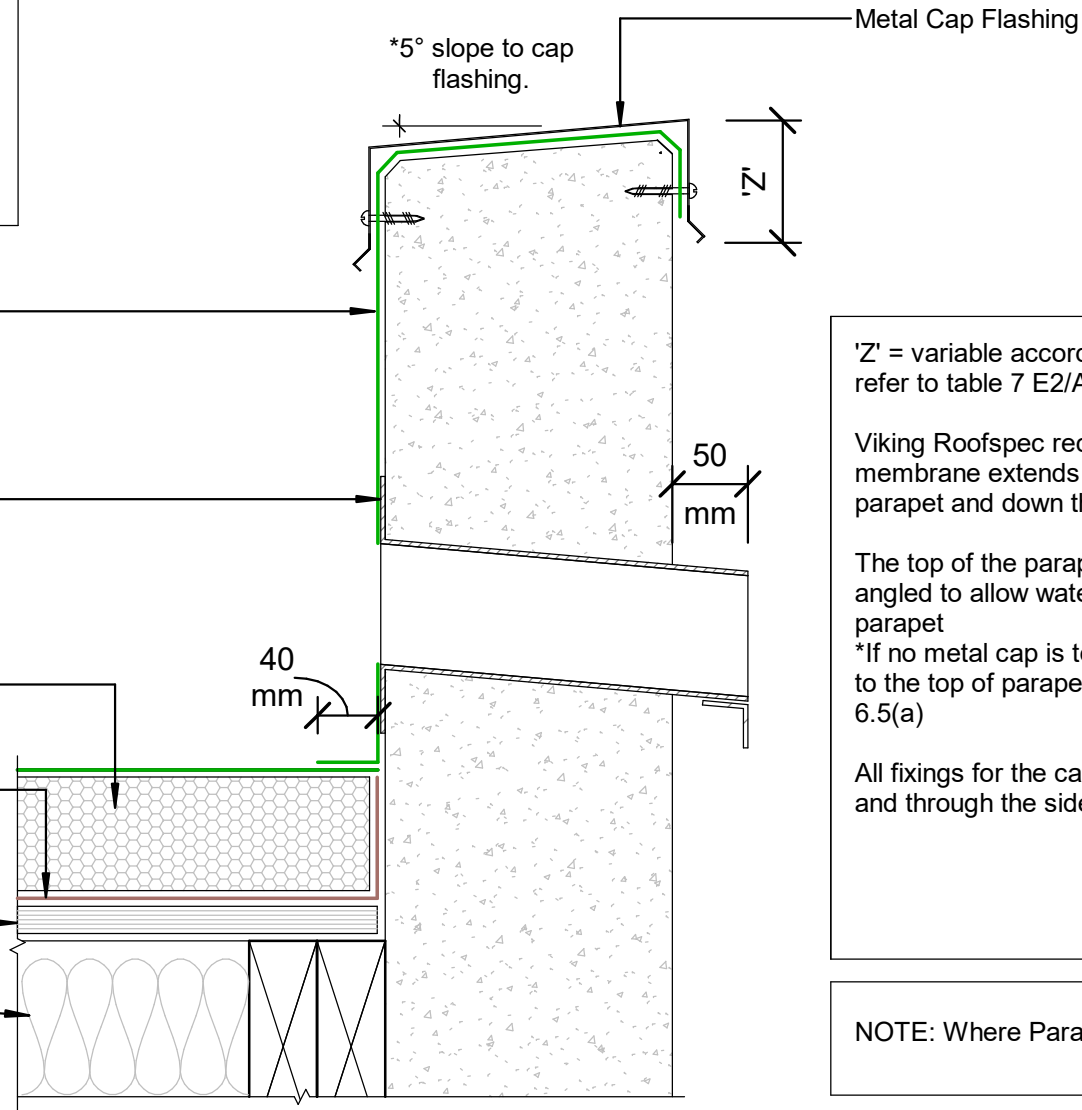

'Z' = variable according to wind zone, please  
 refer to table 7 E2/AS1

Viking Roofspec recommend that the  
 membrane extends across the top of the  
 parapet and down the front face of the cladding

The top of the parapet substrate, must be  
 angled to allow water to run off the top of the  
 parapet  
 \*If no metal cap is to be used, then a 10°  
 slope to the top of parapet is required. Refer  
 E2/AS1 6.5(a)

All fixings for the cap flashing, must be sealed  
 and through the side of the flashing.

**NOTE:** Where Parapet meets wall refer WRE\_40A

DRAWING TITLE

Viking WarmRoof - Enviroclad  
 Parapet\_with overflow

NOTES:

- \* Angle fillets are not required at upstands for Enviroclad
- \* All fixings, cladding and structure are indicative only unless noted
- \* All details to be read in conjunction with Viking Specifications

WarmRoof System is Branz  
 Appraised - 713

DRAWING

INFORMATION ONLY

Scale:	Date:	Drawn:	Viking
Not to Scale	01/03/2022		
Detail Ref: <b>VIK_WRE_042_PARAOVER</b>			

**Viking**  
 Roofspec  
 Taking care of detail