

*Weight allowance for wet growth medium
100kg per M2 of 100mm of soil depth

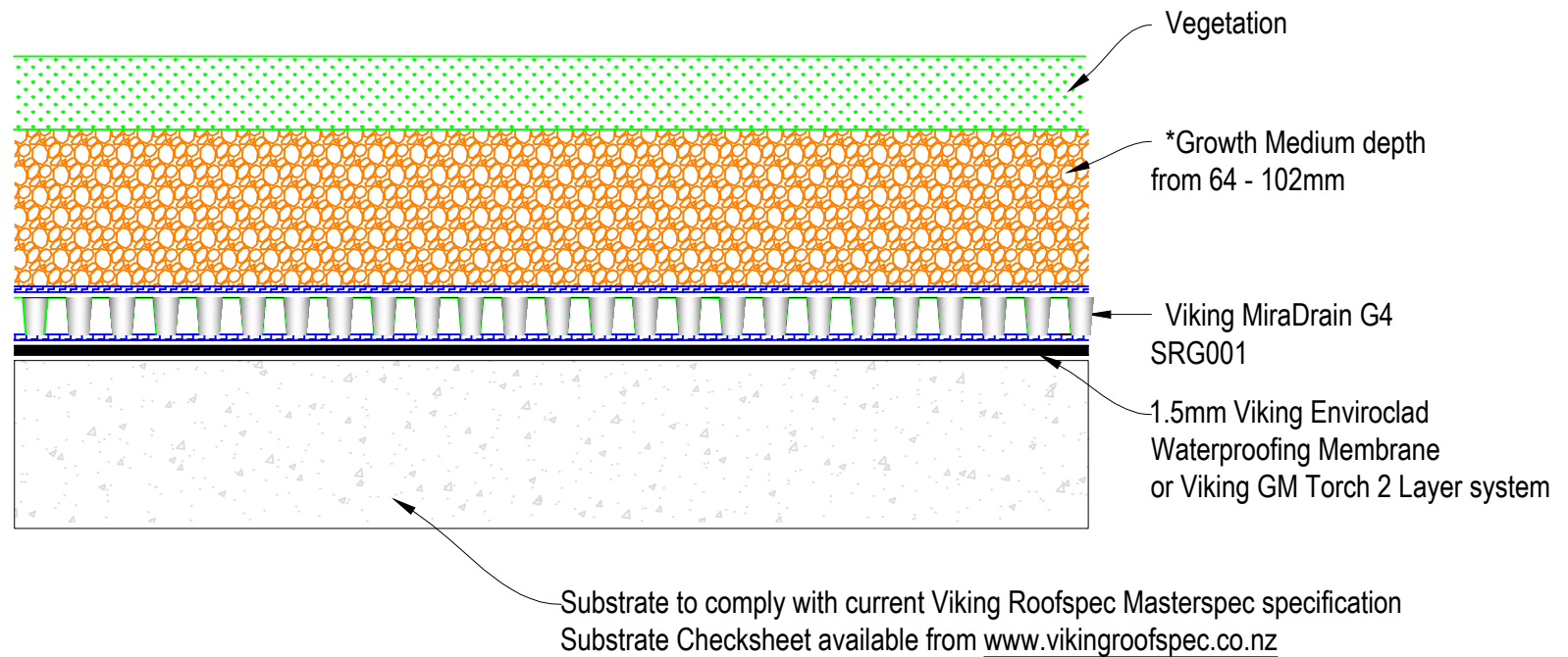

*Weight allowance for wet growth medium
100kg per M2 of 100mm of soil depth

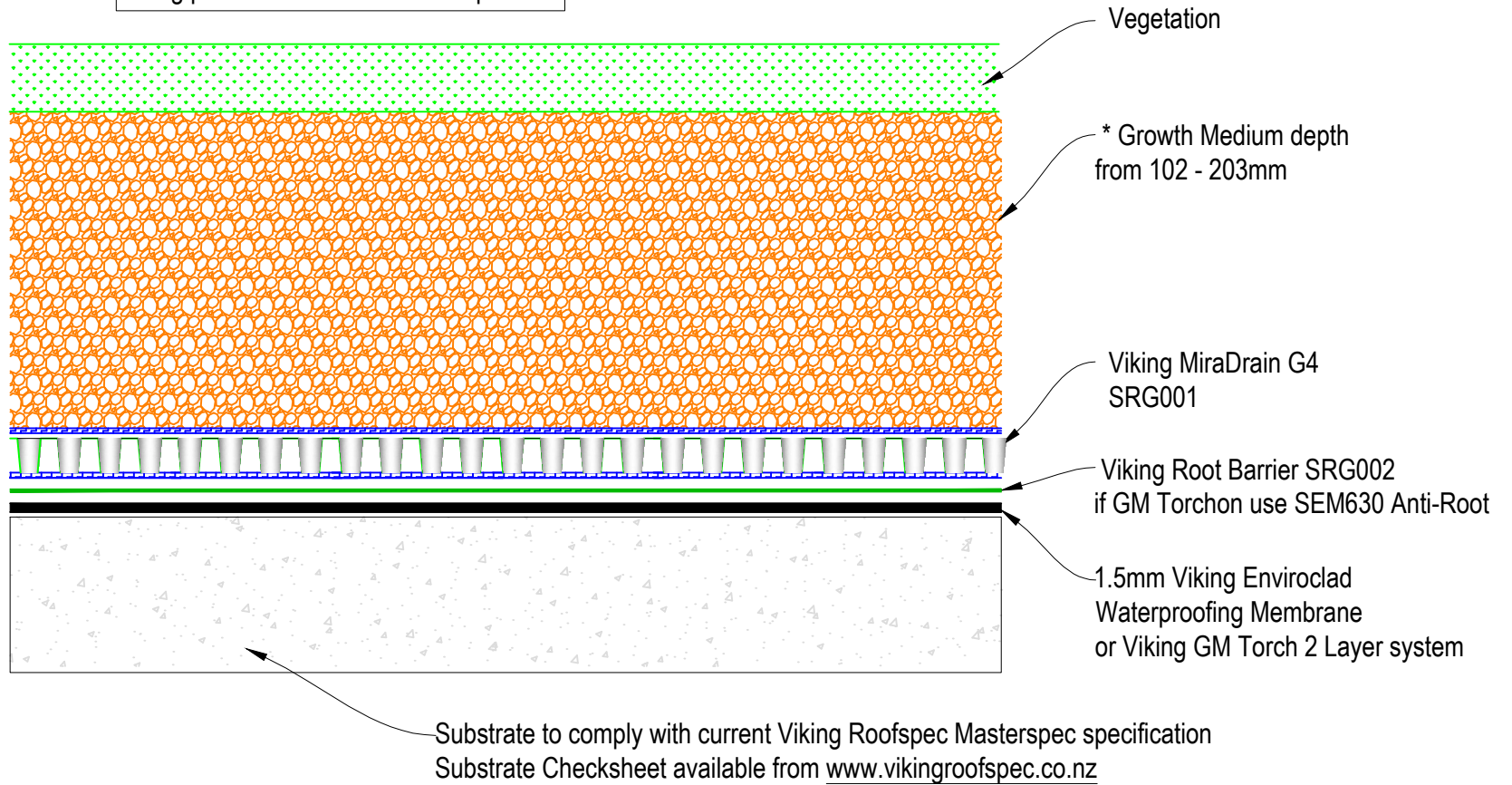

DRAWING TITLE
Viking Roof Garden System Medium Roof Garden Assembly 102 - 203mm

NOTES:
Substrate Indicative Only

DRAWING STATUS			
INFORMATION ONLY			
Not to Scale	DATE 14/04/2018	Detail Ref.	ISSUE
DRAWN	Viking	RG02	A

*Weight allowance for wet growth medium
100kg per M2 of 100mm of soil depth

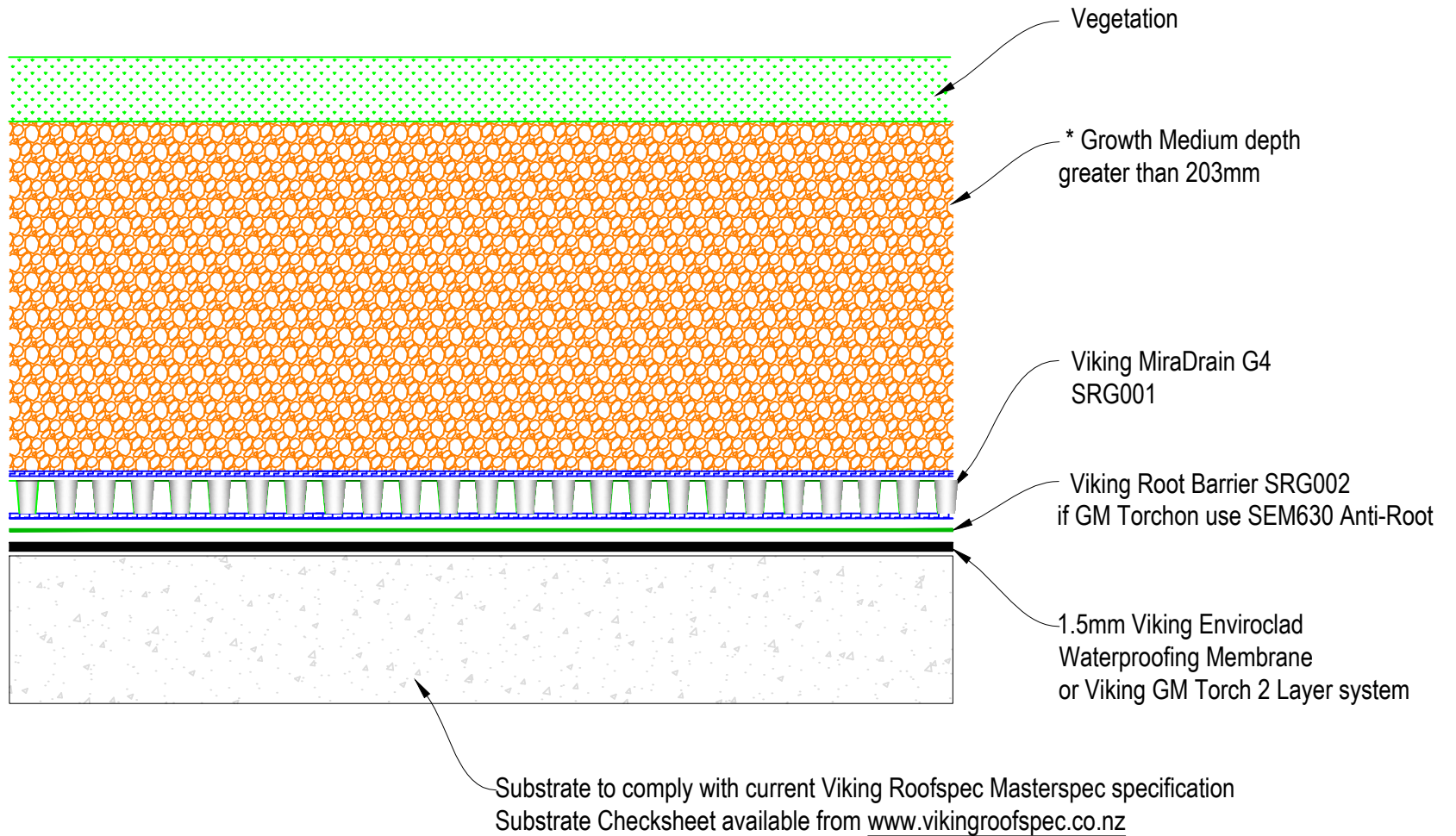

*Weight allowance for wet growth medium
100kg per M2 of 100mm of soil depth

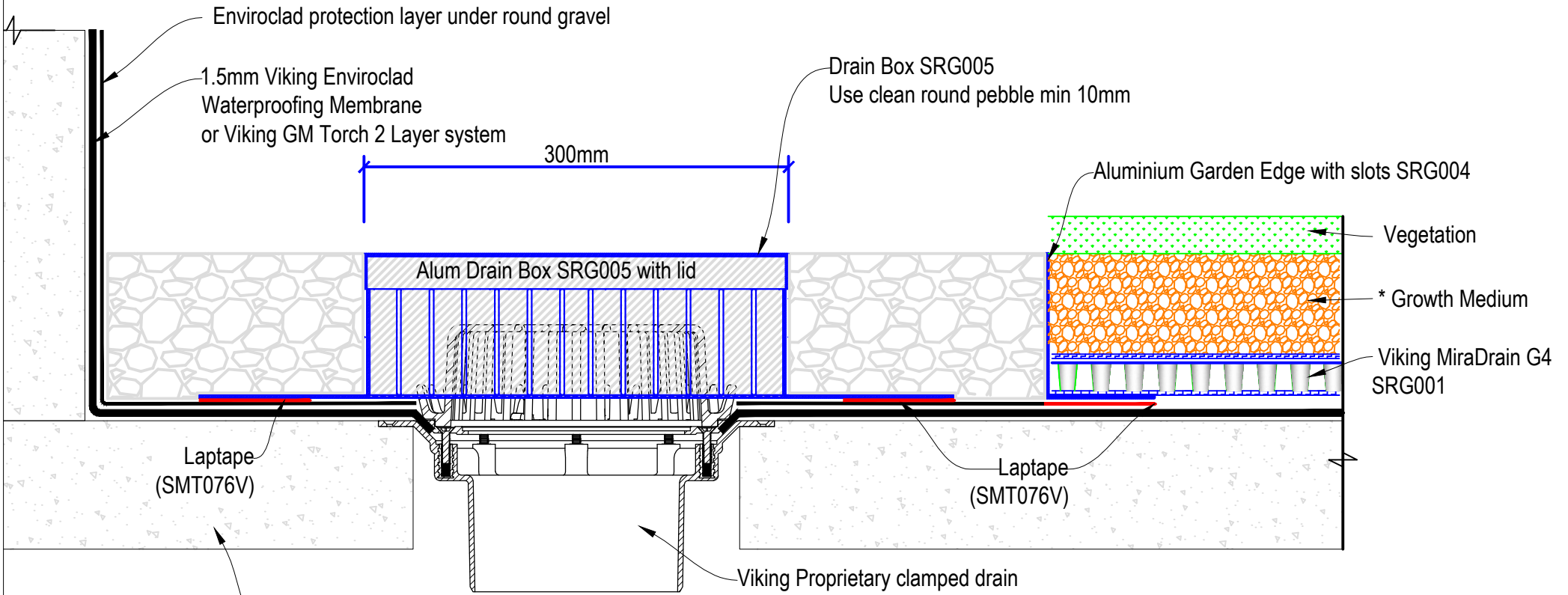

Substrate to comply with current Viking Roofspec Masterspec specification
Substrate Checksheet available from www.vikingroofspec.co.nz



DRAWING TITLE
Viking Roof Garden System Aluminium Drain Box SRG005 300 x 300mm

NOTES:
Substrate Indicative Only

DRAWING STATUS			
INFORMATION ONLY			
Not to Scale	DATE 14/04/2018	Detail Ref.	ISSUE
DRAWN	Viking	RG04	A

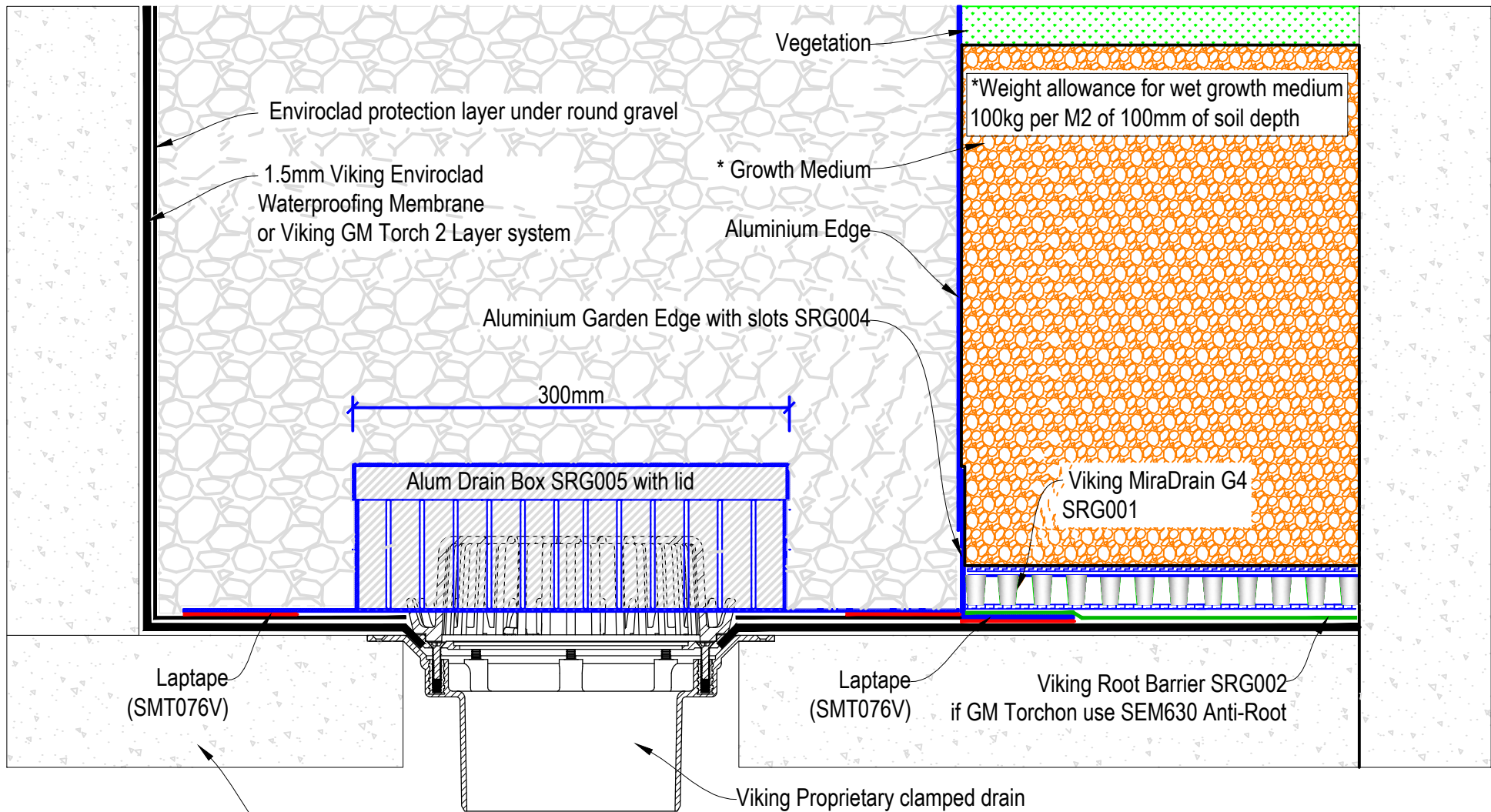

Substrate to comply with current Viking Roofspec Masterspec specification
Substrate Checksheet available from www.vikingroofspec.co.nz

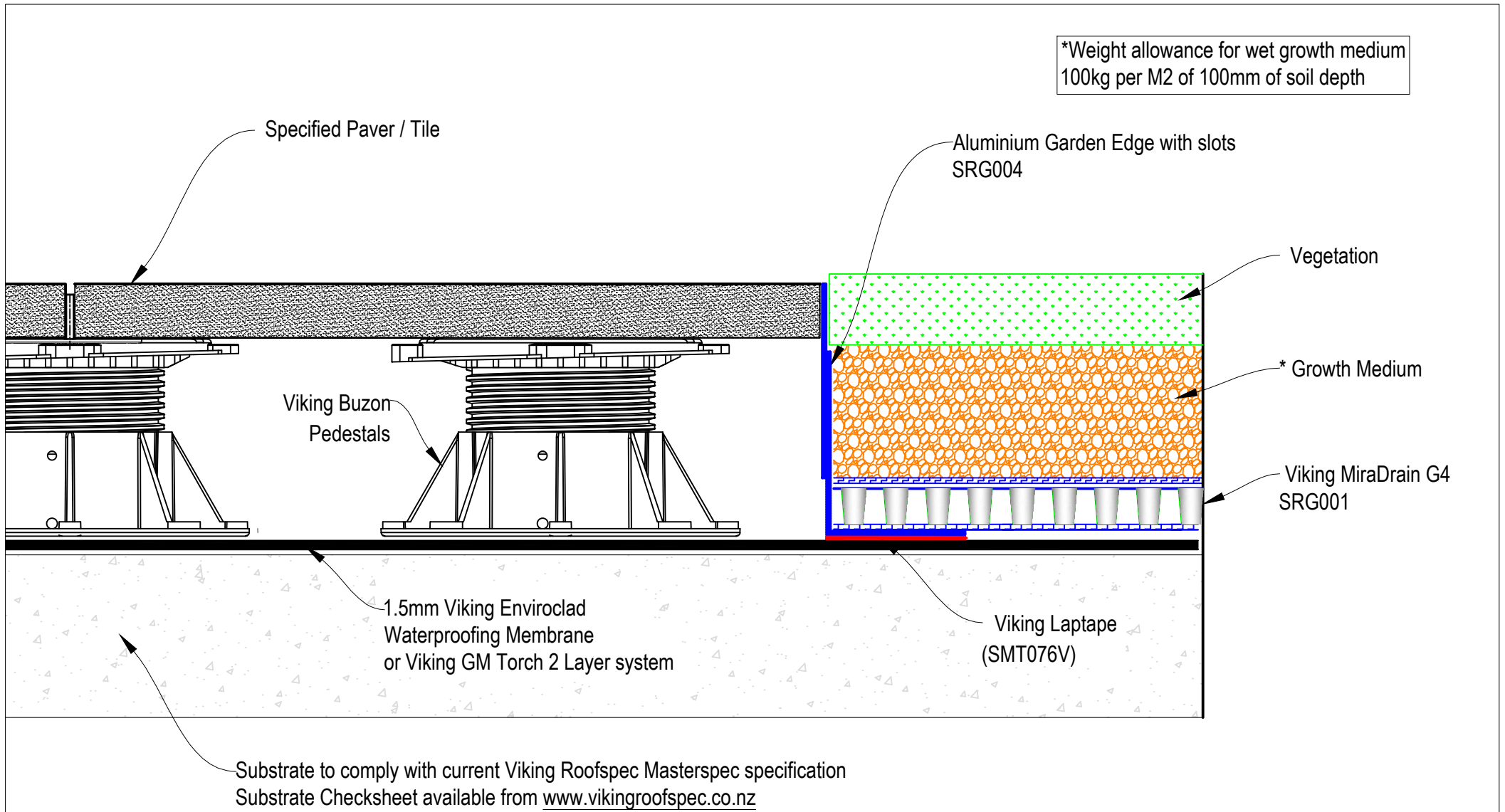

DRAWING TITLE
Viking Roof Garden System Buzon Pedestal supports to Roof Garden edge

NOTES:
Substrate Indicative Only

DRAWING STATUS			
INFORMATION ONLY			
Not to Scale	DATE 14/04/2018	Detail Ref.	ISSUE
DRAWN	Viking	RG06	A

*Weight allowance for wet growth medium
120kg per M2 of 100mm of soil depth

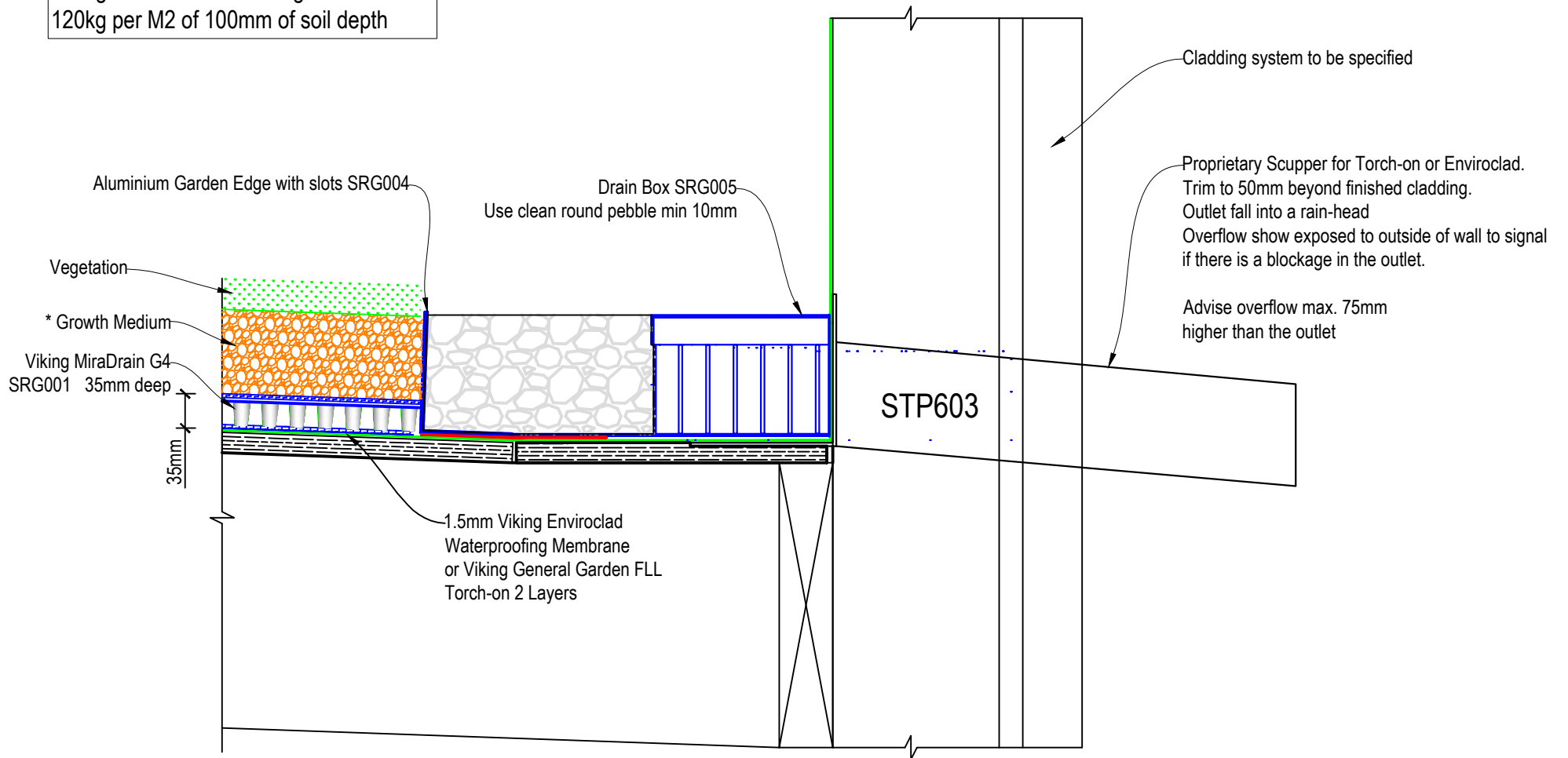

DRAWING TITLE
Viking Roof Garden System Scupper Outlet or Overflow to Shallow Roof Garden Parapet

NOTES:
Substrate Indicative Only

DRAWING STATUS			
INFORMATION ONLY			
Not to Scale	DATE 14/04/2018	Detail Ref.	ISSUE
DRAWN	Viking	RG07	A

*Weight allowance for wet growth medium
120kg per M2 of 100mm of soil depth

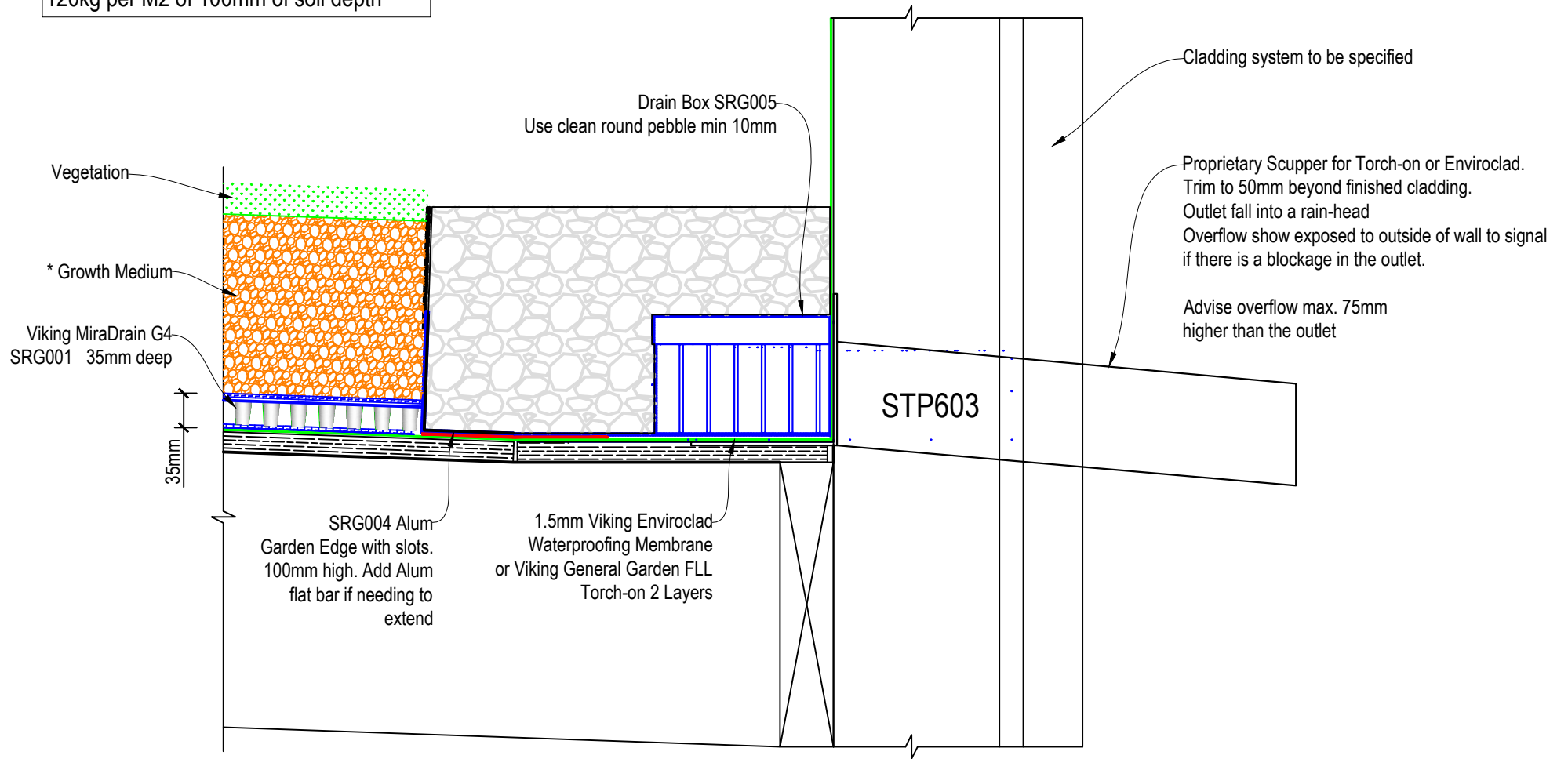

DRAWING TITLE
Viking Roof Garden System Scupper Outlet or Overflow to Deep Roof Garden Parapet

NOTES:
Substrate Indicative Only

DRAWING STATUS			
INFORMATION ONLY			
Not to Scale	DATE 14/04/2018	Detail Ref.	ISSUE
DRAWN	Viking	RG07A	A

*Weight allowance for wet growth medium
120kg per M2 of 100mm of soil depth

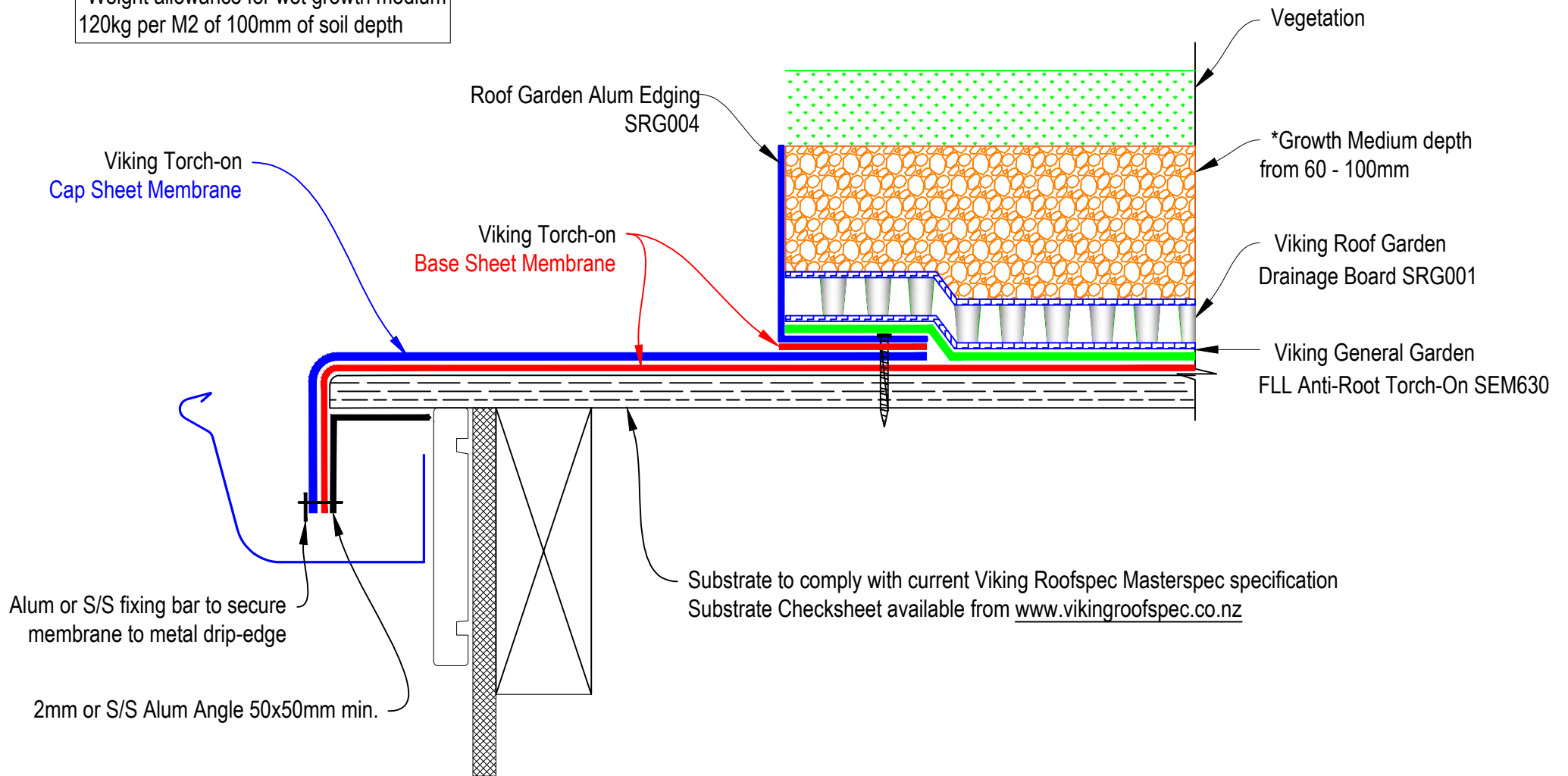

DRAWING TITLE	
Viking Roof Garden System Roof Garden to External Spouting Drip-edge	

NOTES:
Substrate Indicative Only

DRAWING STATUS			
INFORMATION ONLY			
Not to Scale	DATE 14/04/2018	Detail Ref.	ISSUE
DRAWN	Viking	RG08	A