

Viking Roofspec Torch-on
2 Layer Membrane System

Viking Torch-on CAP sheet 4mm
thick, install as per manufacturers
instructions

Viking Torch-on BASE sheet 3mm
thick, install as per manufacturers
instructions

Substrate

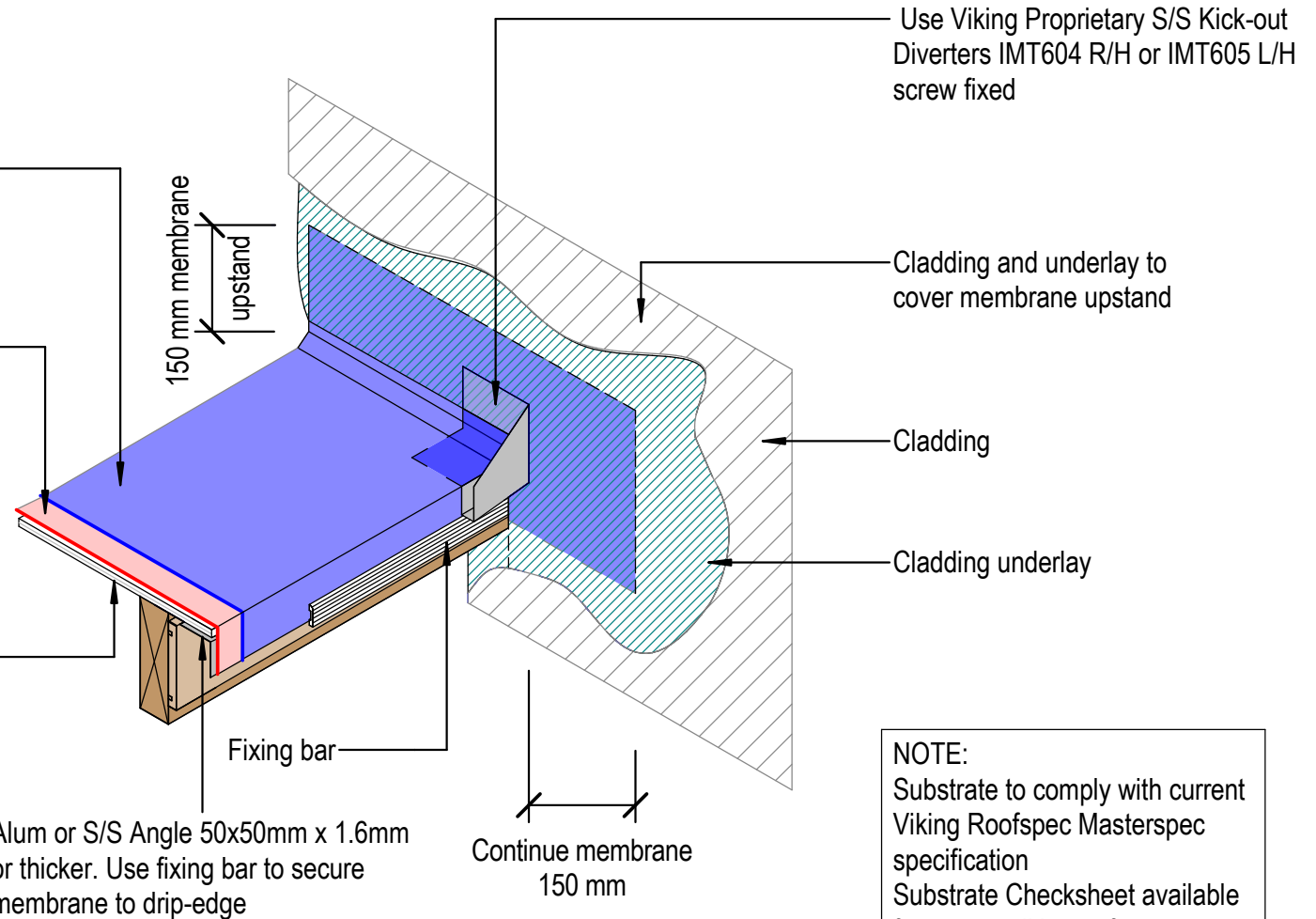

NOTE:
Substrate to comply with current
Viking Roofspec Masterspec
specification
Substrate Checksheet available
from www.vikingroofspec.co.nz

DRAWING TITLE

Viking Torch-On
Verge_edge with wall continuing, Diverter for cladding

NOTES:

- Viking Waterproof Membrane as notated can be Viking Gemini, Lybra or Phoenix Super.
- All fixings, cladding and structure are indicative only unless notated.

CodeMark

Cert # GM-CMNZ30092

Cert # BV-CMNZ70171

Viking Torch-On systems are CodeMarked

DRAWING

INFORMATION ONLY

Scale: Not to Scale Date: 23/11/2020 Drawn: Viking

Detail Ref: **VIK_TOR_033_VERGEDGE**

Viking Roofspec
Taking care of detail