

**NOTE:**  
 Substrate to comply with current Viking Roofspec Masterspec specification  
 Substrate Checksheet available from [www.vikingroofspec.co.nz](http://www.vikingroofspec.co.nz)

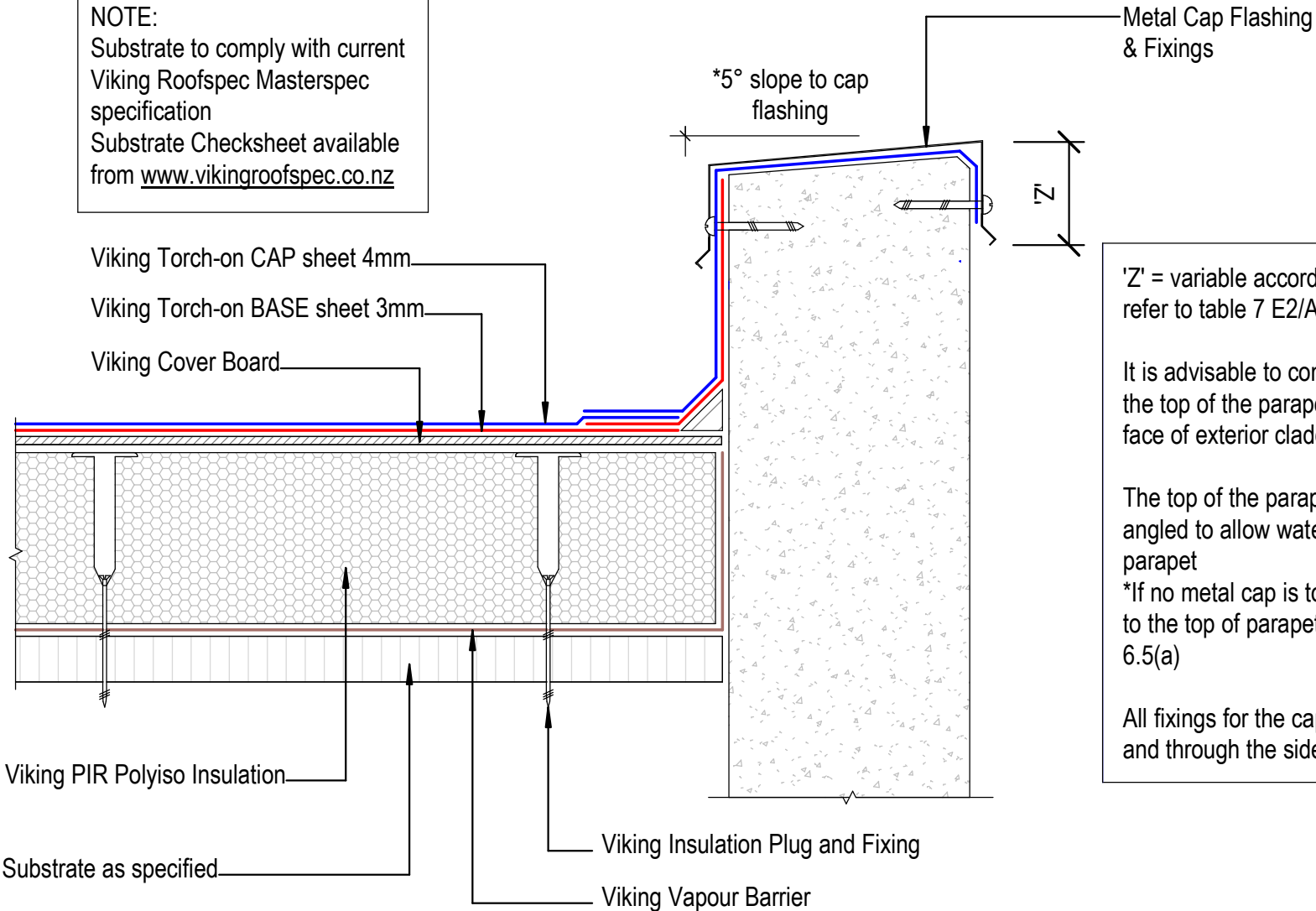

'Z' = variable according to wind zone, please refer to table 7 E2/AS1

It is advisable to continue the membrane over the top of the parapet and finish over the front face of exterior cladding

The top of the parapet substrate, must be angled to allow water to run off the top of the parapet  
 \*If no metal cap is to be used, then a 10° slope to the top of parapet is required. Refer E2/AS1 6.5(a)

All fixings for the cap flashing, must be sealed and through the side of the flashing.

DRAWING TITLE

Viking WS2 - Torch-On  
 Parapet\_with Cap concrete wall

NOTES:

\*Viking Waterproof Membrane as notated can be Viking Gemini, Lybra, Phoenix Super or Halley P.  
 \*All details to be read in conjunction with Viking Specifications.

Substrate and structure are indicative only

DRAWING STATUS

INFORMATION ONLY

|  |                     |        |        |
|--|---------------------|--------|--------|
| Scale:<br>Not to Scale                     | Date:<br>01/10/2022 | Drawn: | Viking |
| Detail Ref: <b>VIK_WS2_TOR_040_PARACAP</b> |                     |        |        |