

Viking Enviroclad TPO waterproofing membrane 1.52 mm thick, install as per manufacturers instructions.

Substrate

**NOTE:**  
 Substrate to comply with current Viking Roofspec Masterspec specification  
 Substrate Checksheet available from [www.vikingroofspec.co.nz](http://www.vikingroofspec.co.nz)

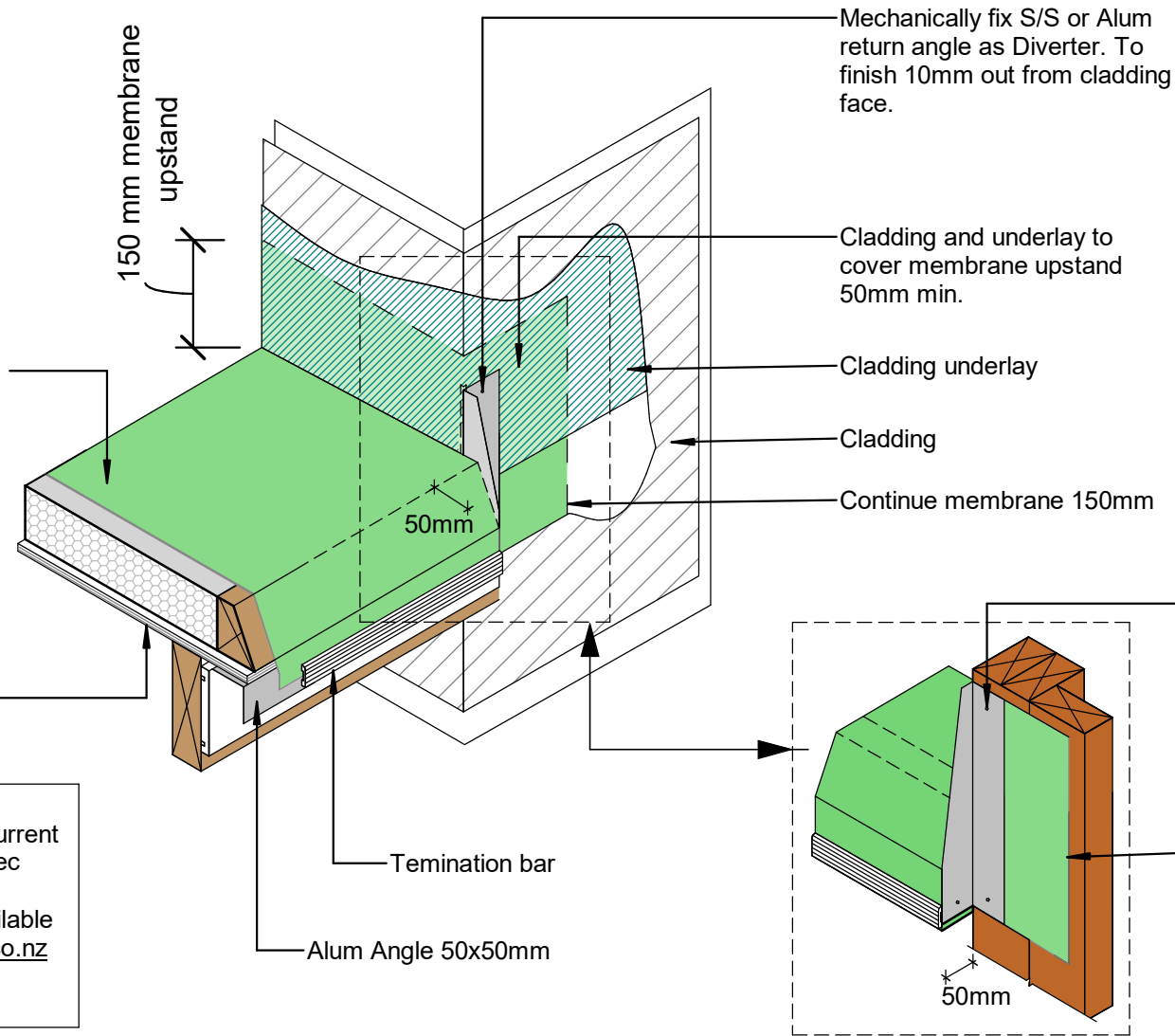

Mechanically fix S/S or Alum return angle as Diverter. To finish 10mm out from cladding face.

Cladding and underlay to cover membrane upstand 50mm min.

Cladding underlay

Cladding

Continue membrane 150mm

Termination bar

Alum Angle 50x50mm

Mechanically fix S/S or Alum return angle as Diverter. To finish 10mm out from cladding face.

Continue Membrane 150mm

50mm

DRAWING TITLE

Viking WarmRoof - Enviroclad  
 Verge\_edge with wall returning, Diverter for cladding

NOTES:

- \* Angle fillets are not required at upstands for Enviroclad
- \* All fixings, cladding and structure are indicative only unless noted
- \* All details to be read in conjunction with Viking Specifications

WarmRoof System is Branz Appraised - 713

DRAWING

INFORMATION ONLY

Scale:	Date:	Drawn:	Viking
Not to Scale	01/03/2022		

Detail Ref: VIK\_WRE\_033A\_VERGEDGE