

NOTE:
Sheet laps may also run in
the direction of fall

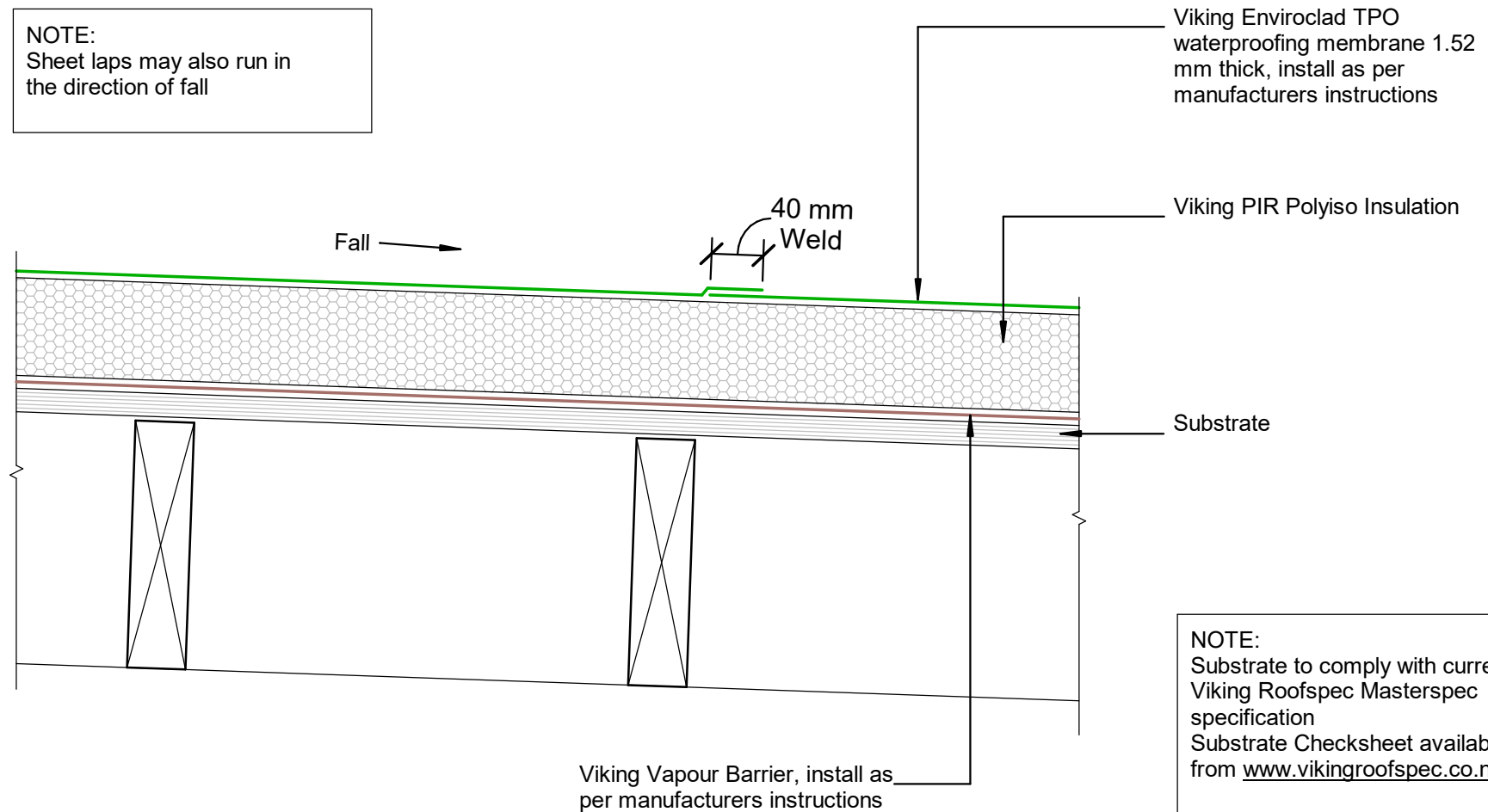

NOTE:
Substrate to comply with current
Viking Roofspec Masterspec
specification
Substrate Checksheet available
from www.vikingroofspec.co.nz

DRAWING TITLE

Viking WarmRoof - Enviroclad
Intersection_Sheet Lap

NOTES:

- * Angle fillets are not required at upstands for Enviroclad
- * All fixings, cladding and structure are indicative only unless noted
- * All details to be read in conjunction with Viking Specifications

WarmRoof System is Branz
Appraised - 713

DRAWING

INFORMATION ONLY

Scale:	Date:	Drawn:	Viking
Not to Scale	01/03/2022		
Detail Ref:			

VIK_WRE_066_INTSSHEL

Viking Roofspec
Taking care of detail