

NOTE: Substrate to comply with current Viking Roofspec Masterspec specification Substrate Checksheet available from www.vikingroofspec.co.nz

NOTE: Refer Viking Roofspec's correct Below Ground Tanking Methodology

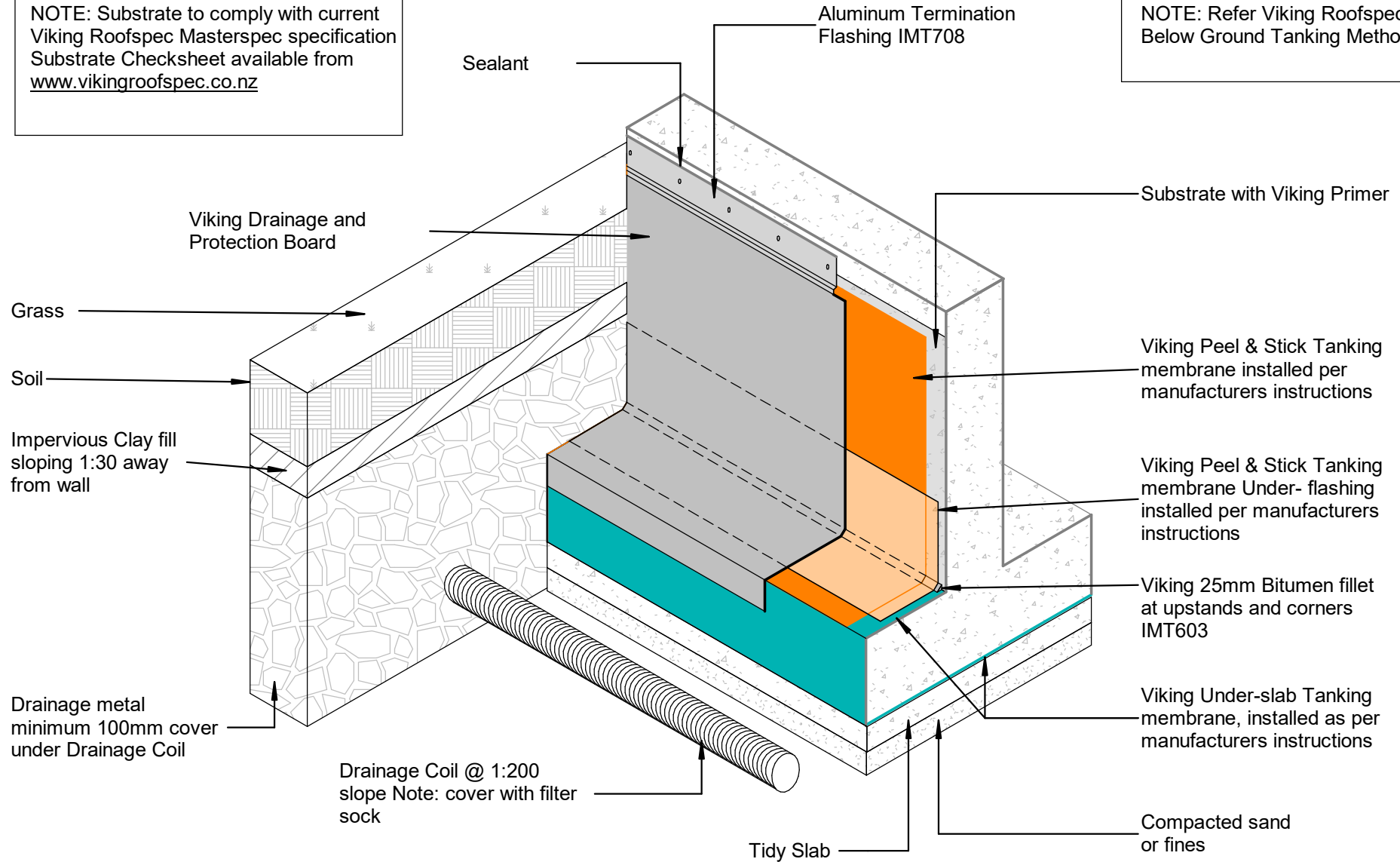

Viking Tanking - Peel & Stick Junction_Wall to Slab Iso

DRAWING TITLE

NOTES:

- * All fixings, cladding and structure are indicative only unless notated
- * Drawings to be read with Viking Specifications

INFORMATION

Viking Tanking systems are BRANZ Appraised - 826

DRAWING INFORMATION ONLY			
Scale:	Date:	Drawn:	Viking
Not to Scale	01/03/2022		
Detail Ref:			VIK_BGT_PS_01