

NOTE:

Substrate to comply with current Viking Roofspec Masterspec specification
Substrate Checksheet available from www.vikingroofspec.co.nz

NOTE:

Consider Viking Detail WS2_011 as a better option for supporting Mechanical Plant on membrane roofs. Viking Roofspec do not recommend fixing posts or plant through the top of Membrane roofs or decks. If this is required, then use of a plinth ensures the fixings by other trades are kept off the main deck flood area. Viking Roofspec recommend that any fixing of plant is kept independent of the membrane roof ideally through vertical surfaces such as parapets. All fixings must be sealed.

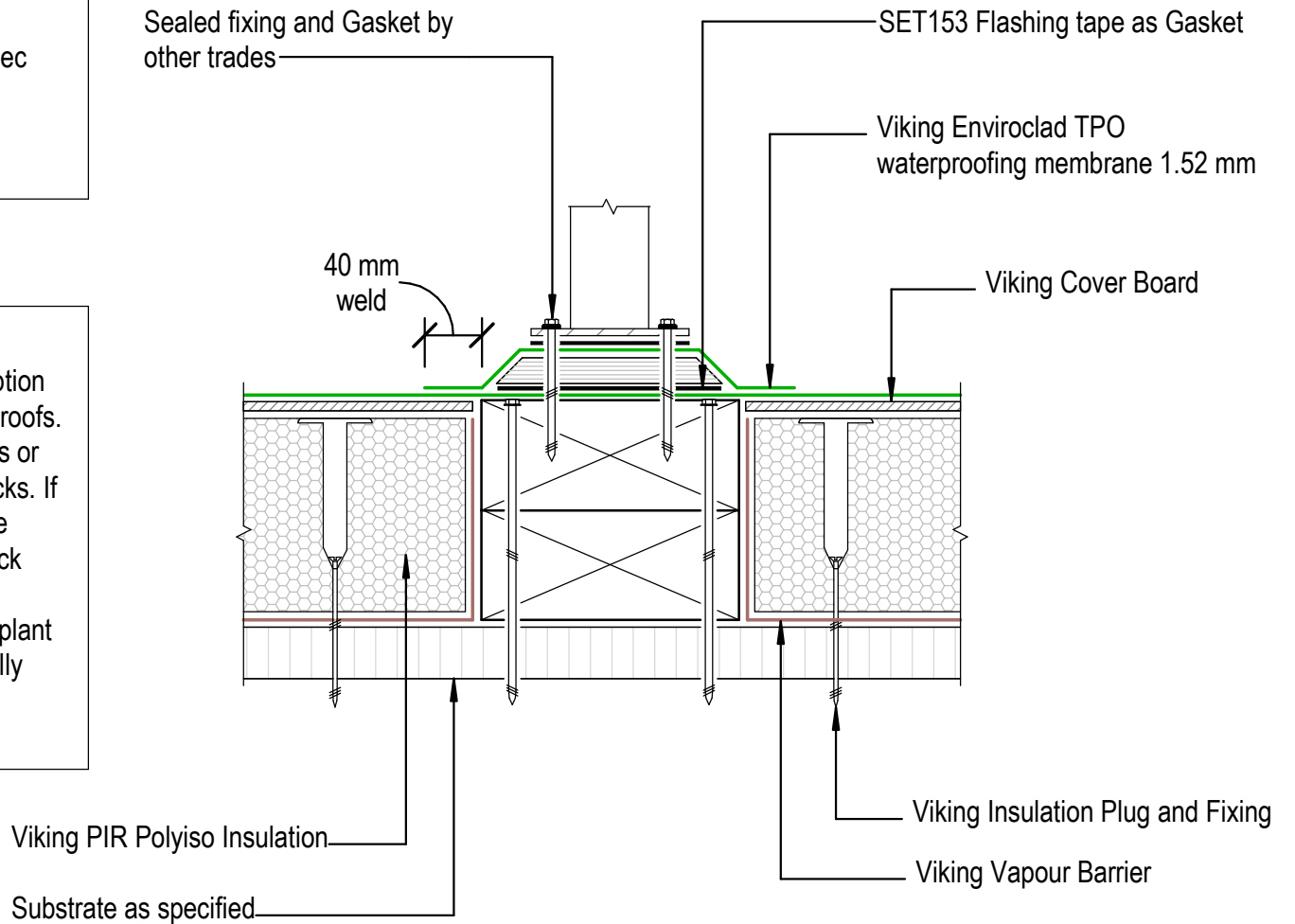

DRAWING TITLE

Viking WS2 - Enviroclad
Penetration_Plinth base for Balustrade

NOTES:

- * Angle fillets are not required at upstands for Enviroclad
- * All fixings, cladding and structure are indicative only unless noted
- * All details to be read in conjunction with Viking Specifications

Substrate and structure are indicative only

DRAWING STATUS

INFORMATION ONLY

| | | |
|---|---------------------|------------------|
| Scale: Not to Scale | Date: 01/10/2022 | Drawn: Viking |
| Detail Ref: VIK_WS2_ENV_012_PENEPLIN | | |