

Viking Enviroclad TPO waterproofing membrane 1.52 mm thick, install as per manufacturers instructions

.55g Metal Angle with Hemmed edges to create solid edge for Viking PIR

Viking PIR Polyiso Insulation

40 mm  
Weld

Cladding to Overlap membrane by a minimum 50mm

Overflow level  
(Max.high-point of deck)

A  
B

Membrane continues a further 100mm beyond Internal floor level as per E2/AS1 Fig 62(b,d)

100mm threshold from high-point of deck to Internal floor level or 150mm for roof to wall upstand. Refer E2/A1 Fig 64(b)

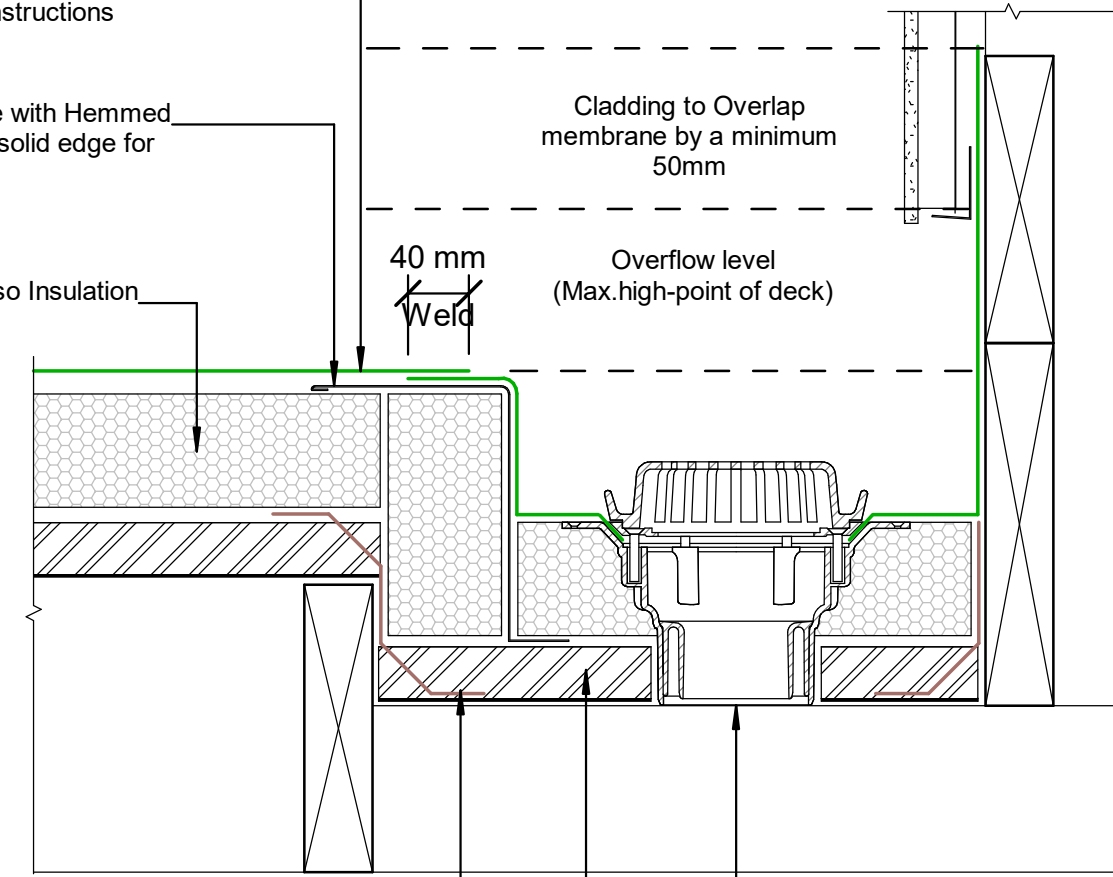

Viking Vapour Barrier, install as per manufacturers instructions

Substrate

Viking 80mmØ clamped drain SDM049 with 304 S/S domed grate, installed as per manufacturers instructions.

**NOTE:**  
Substrate to comply with current Viking Roofspec Masterspec specification Substrate Checksheet available from [www.vikingroofspec.co.nz](http://www.vikingroofspec.co.nz)

DRAWING TITLE

Viking WarmSpan - Enviroclad  
Internal Gutter\_to Wall

NOTES:

- \* Angle fillets are not required at upstands for Enviroclad
- \* All fixings, cladding and structure are indicative only unless notated
- \* All details to be read in conjunction with Viking Specifications

WarmSpan System is Branz Appraised - 713

DRAWING

INFORMATION ONLY

Scale:	Date:	Drawn:	Viking
Not to Scale	01/03/2022		

Detail Ref: **VIK\_WSE\_051\_GUTTWALL**