

NOTE:
 Substrate to comply with current
 Viking Roofspec Masterspec
 specification
 Substrate Checksheet available
 from www.vikingroofspec.co.nz

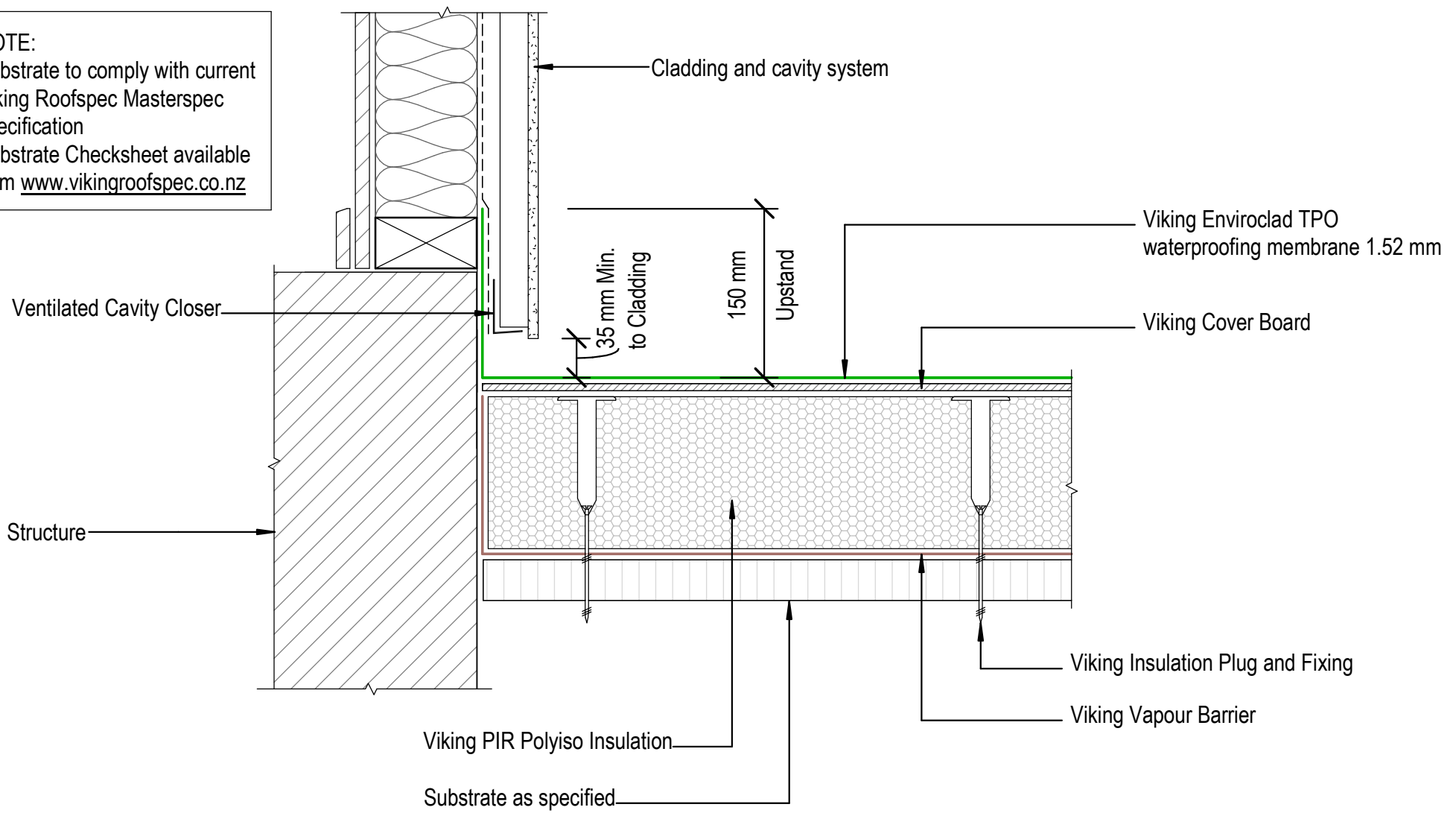

DRAWING TITLE

Viking WS2 - Enviroclad
 Apron_Upstand behind cladding

NOTES:

- * Angle fillets are not required at upstands for Enviroclad
- * All fixings, cladding and structure are indicative only unless noted
- * All details to be read in conjunction with Viking Specifications

Substrate and structure are indicative only

DRAWING STATUS

INFORMATION ONLY			
Scale: Not to Scale	Date: 01/10/2022	Drawn:	Viking
Detail Ref: VIK_WS2_ENV_080_APRNUPST			

