

NOTE:
TPO Weldable Rib to be Welded directly to Enviroclad TPO membrane, with no penetrations. Ribs can be placed at any point along the roof as long as they don't inhibit watershed

NOTE:
Substrate to comply with current Viking Roofspec Masterspec specification
Substrate Checksheet available from www.vikingroofspec.co.nz

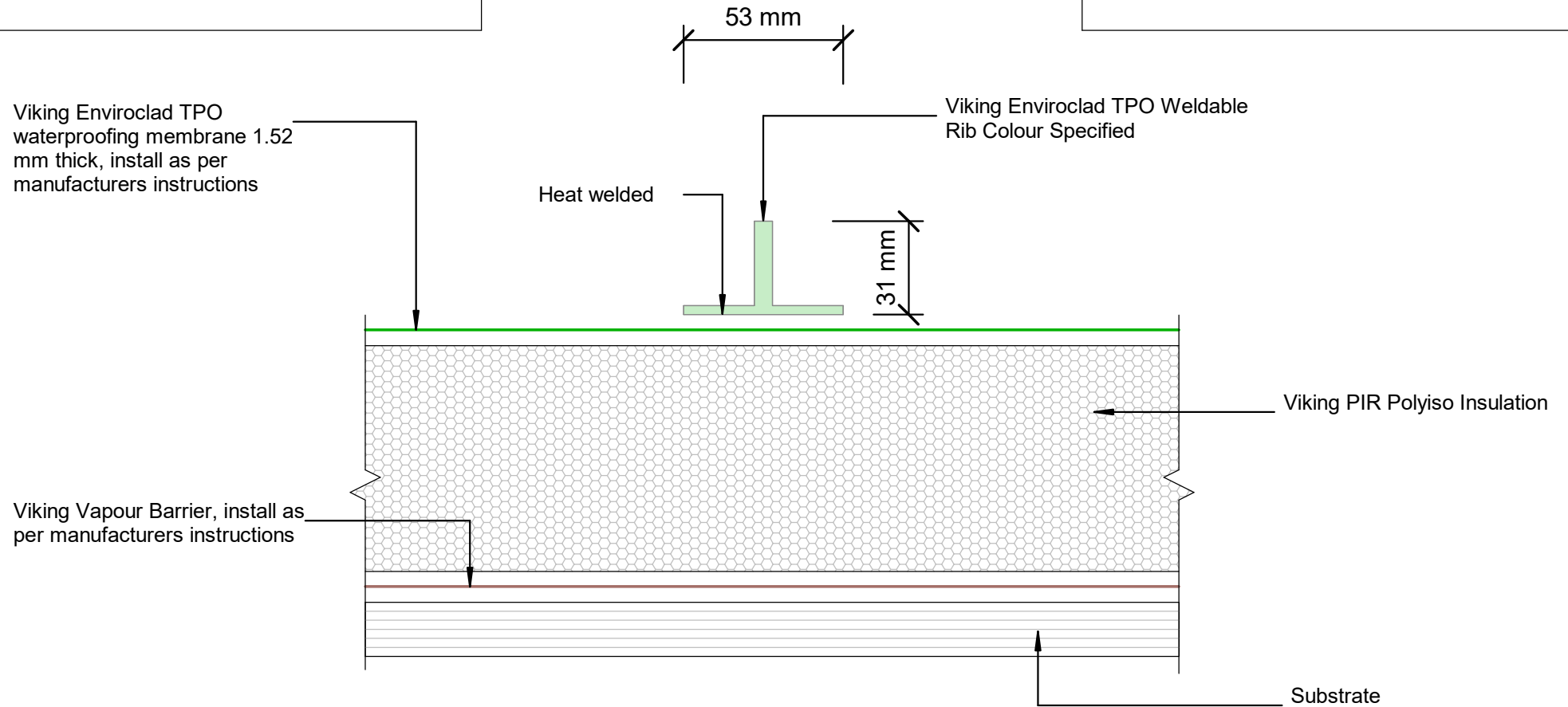

DRAWING TITLE

Viking WarmRoof - Enviroclad
Accessories_Enviroclad TPO Weldable Rib

NOTES:

- * Angle fillets are not required at upstands for Enviroclad
- * All fixings, cladding and structure are indicative only unless noted
- * All details to be read in conjunction with Viking Specifications

WarmRoof System is Branz
Appraised - 713

DRAWING

INFORMATION ONLY

Scale:	Date:	Drawn:	Viking
Not to Scale	01/03/2022		
Detail Ref: VIK_WRE_120_ACCTPOWR			