

NOTE:
Sheet laps may also run in the direction of fall

Head to Toe Lap

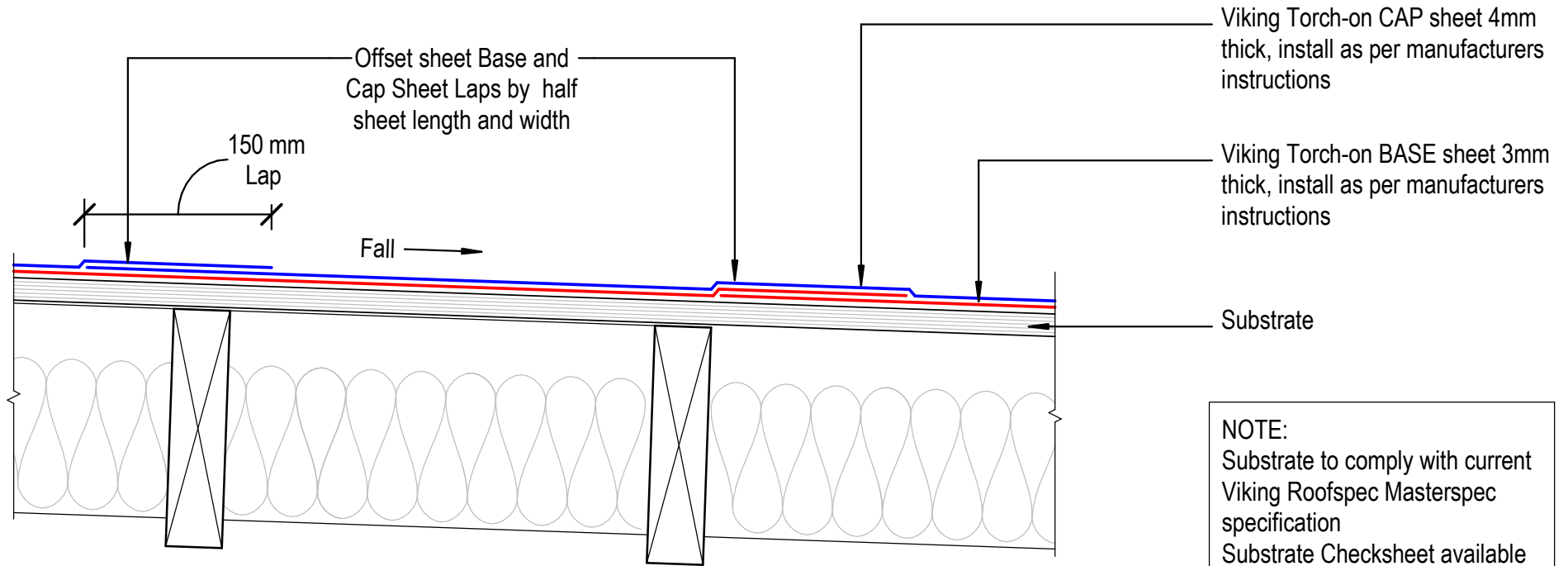

NOTE:
Substrate to comply with current Viking Roofspec Masterspec specification
Substrate Checksheet available from www.vikingroofspec.co.nz

DRAWING TITLE

Viking Torch-On
Intersection_Sheet Lap

NOTES:

- Viking Waterproof Membrane as notated can be Viking Gemini, Lybra or Phoenix Super.
- All fixings, cladding and structure are indicative only unless notated.

CodeMark

Cert # GM-CMNZ30092

Cert # BV-CMNZ70171

Viking Torch-On systems are CodeMarked

DRAWING

INFORMATION ONLY

Scale:
Not to Scale

Date:
23/11/2020

Drawn: Viking

Detail Ref:

VIK_TOR_066_INTSSHEL

Roofspec
Viking
Taking care of detail