

Viking Drainage Protection Board

Viking Peel & Stick Tanking membrane installed per manufacturers instructions

Substrate with Viking Primer

Viking Peel & Stick Tanking membrane under-flashed 300mm wide min. with Bitumen Fillet IMT603

Drainage aggregate as specified

Drainage Pipe with filter fabric as specified

Viking Under-slab Tanking membrane, installed as per manufacturers instructions

NOTE:  
Substrate to comply with current Viking Roofspec Masterspec specification  
Substrate Checksheet available from [www.vikingroofspec.co.nz](http://www.vikingroofspec.co.nz)

NOTE:  
Precast concrete with no voids  
Blockwork requires a flush finish to side of tanking

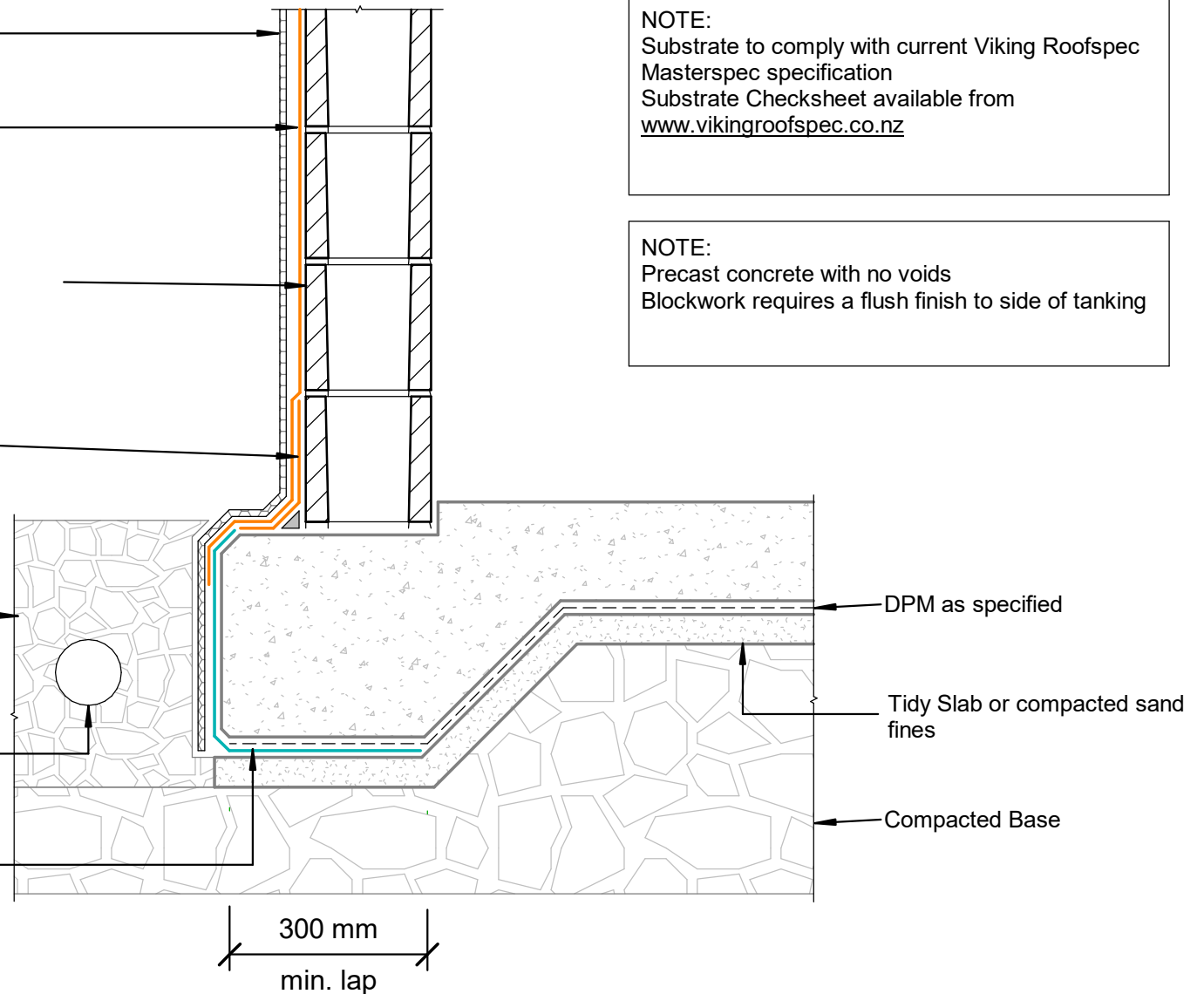

DRAWING TITLE

Viking Tanking - Peel & Stick  
Junction\_Wall to Slab with DPM

NOTES:

\* All fixings, cladding and structure are indicative only unless notated

\* Drawings to be read with Viking Specifications

INFORMATION

Viking Tanking systems are BRANZ Appraised - 826

DRAWING

INFORMATION ONLY

Scale:	Date:	Drawn:	Viking
Not to Scale	01/03/2022		

Detail Ref:

**VIK\_BGT\_PS\_03**