

Finish Membrane 100mm
min. up framing at ends.
Width to suit joinery and
cladding. Refer E2/AS1
FIG62(b)(d)

Finished Floor Level

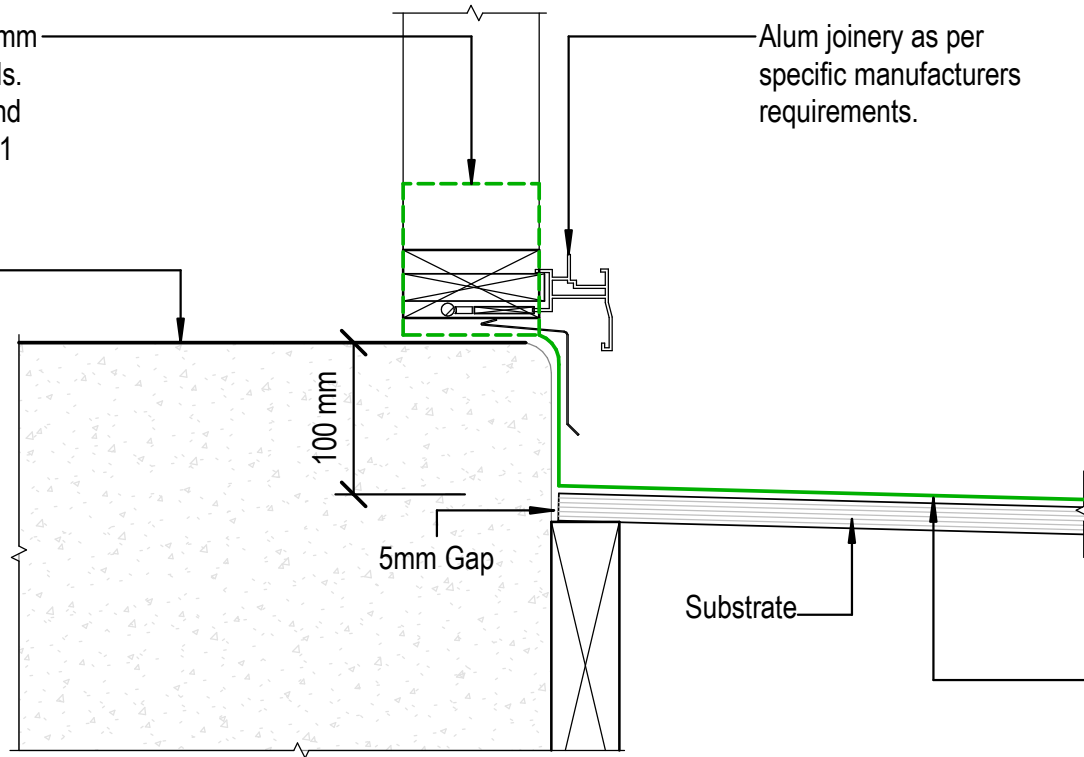

Alum joinery as per
specific manufacturers
requirements.

NOTE:
Substrate to comply with current
Viking Roofspec Masterspec
specification
Substrate Checksheet available
from www.vikingroofspec.co.nz

Substrate

Viking Enviroclad TPO
waterproofing membrane 1.52 mm
thick, install as per manufacturers
instructions

DRAWING TITLE

Viking Enviroclad
Threshold_Door

NOTES:

- * Angle fillets are not required at upstands for Enviroclad
- * All fixings, cladding and structure are indicative only unless notated

CodeMark

Cert # GM-CMNZ30058

Cert # BV-CMNZ70176

Enviroclad systems are CodeMarked

DRAWING

INFORMATION ONLY

Scale:	Date:	Drawn:	Viking
Not to Scale	23/11/2020		
Detail Ref:			VIK_ENV_090_DOORTHRS

Viking Roofspec
Taking care of detail