

Although Viking Roofspec do not recommend fixing posts or plant through the top of Membrane roofs or decks if this is required then use of a plinth detail provides that fixings by other trades are keep off the main deck area. Viking Roofspec recommend that any fixing of posts or plant is kept independent of the membrane roof/deck ideally through vertical surfaces such as parapets or deck edges. All fixings should be sealed and shrouded. Note: Viking Roofspec or our Approved Applicators do not warranty fixings installed by other trades.

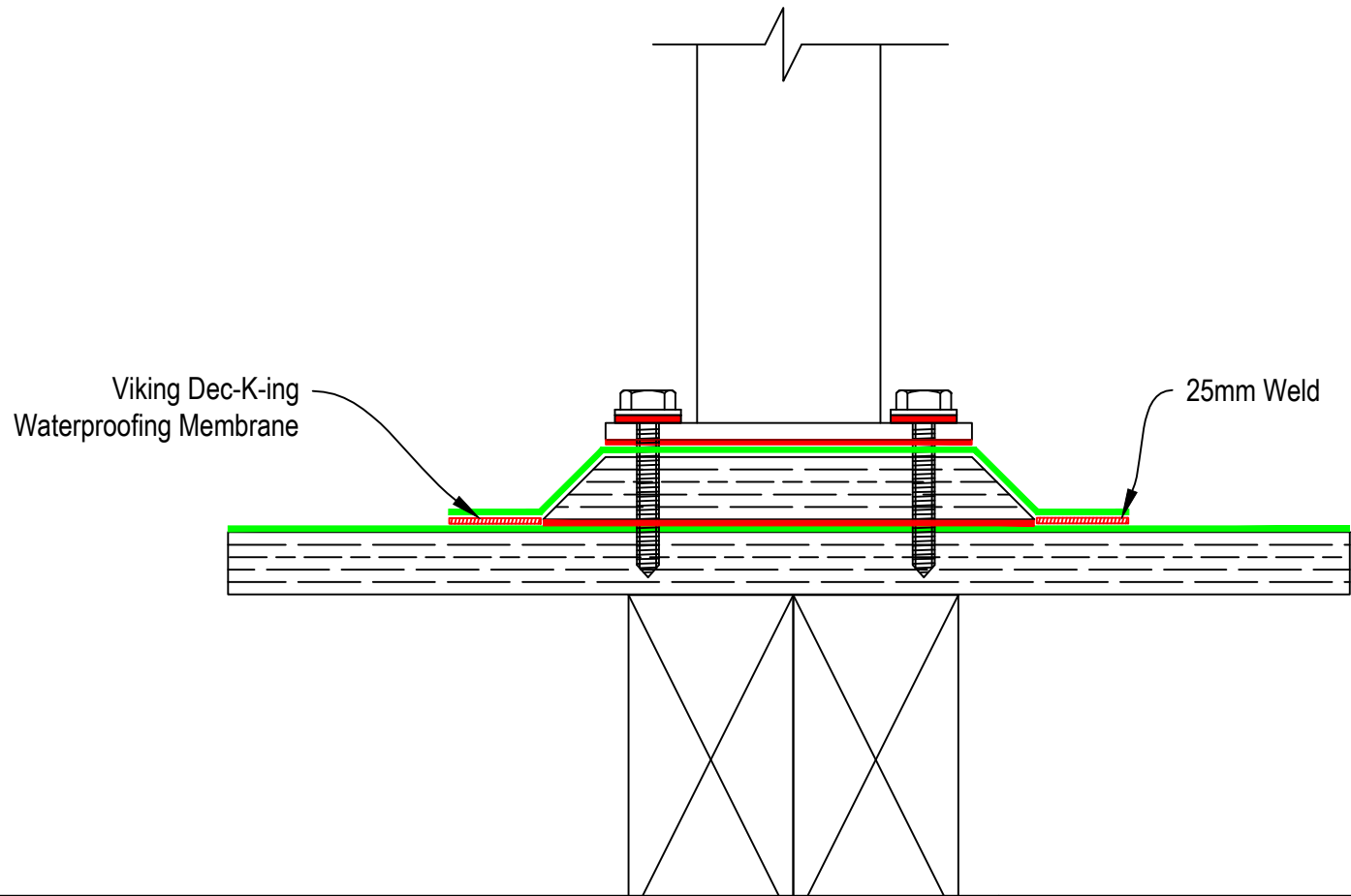

DRAWING TITLE
DK14 Dec-K-ing Plinth

NOTES:
1/ Substrate Indicative Only 2/ No fillets required at upstands for Dec-K-ing

DRAWING STATUS		
INFORMATION ONLY		
Not to Scale	DATE 29/4/2015	Detail Ref.
DRAWN	Viking	DK14 A
SERIES	1.10	