

NOTE:

Substrate to comply with current Viking Roofspec Masterspec specification
Substrate Checksheet available from www.vikingroofspec.co.nz

NOTE:

A 5° fall is recommended for pipe penetrations

Any Wire or conduit must be feed through a PVC pipe with a 90 degree downturn

Pipe work must be firmly supported to the substrate prior to tanking commencing

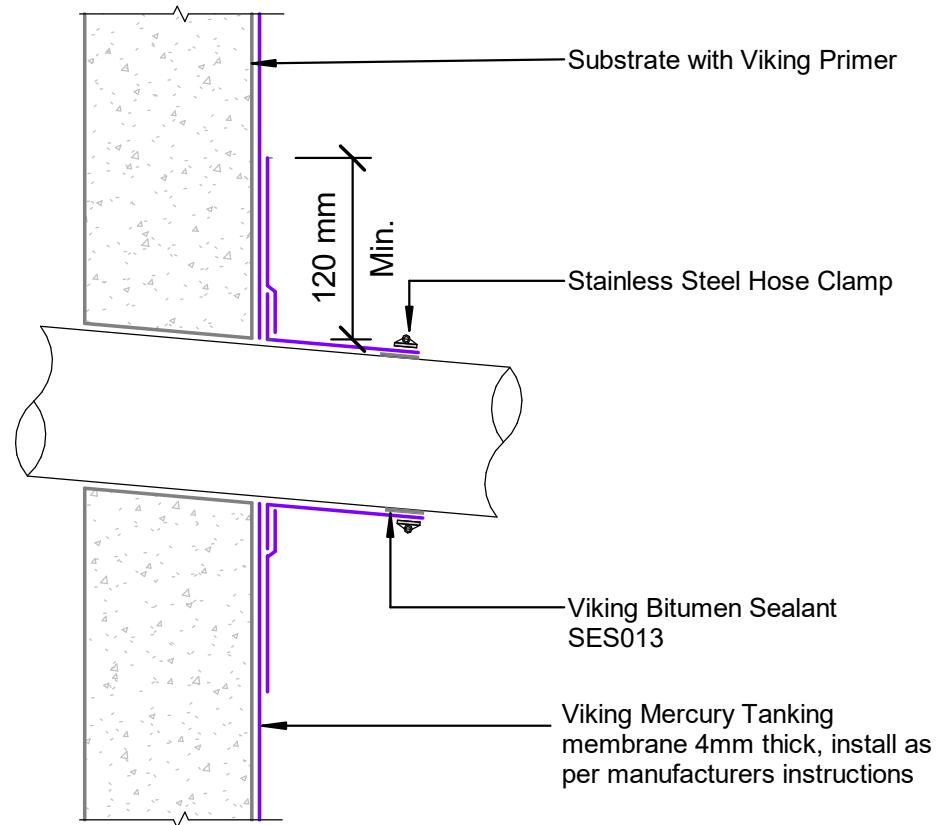

DRAWING TITLE

Viking Below Ground Tanking - Torch -On
Penetration_Horizontal Pipe

NOTES:

* All fixings, cladding and structure are
indicative only unless notated

* Drawings to be read with Viking
Specifications

INFORMATION

Viking Tanking systems are
BRANZ Appraised - 864

DRAWING

INFORMATION ONLY

Scale: Not to Scale Date: 01/03/2022 Drawn: Viking

Detail Ref:

VIK_BGT_TO_22

Viking Roofspec
Taking care of detail