

Note: For floating trafficable decks install Viking Cover-board between PIR insulation and membrane.

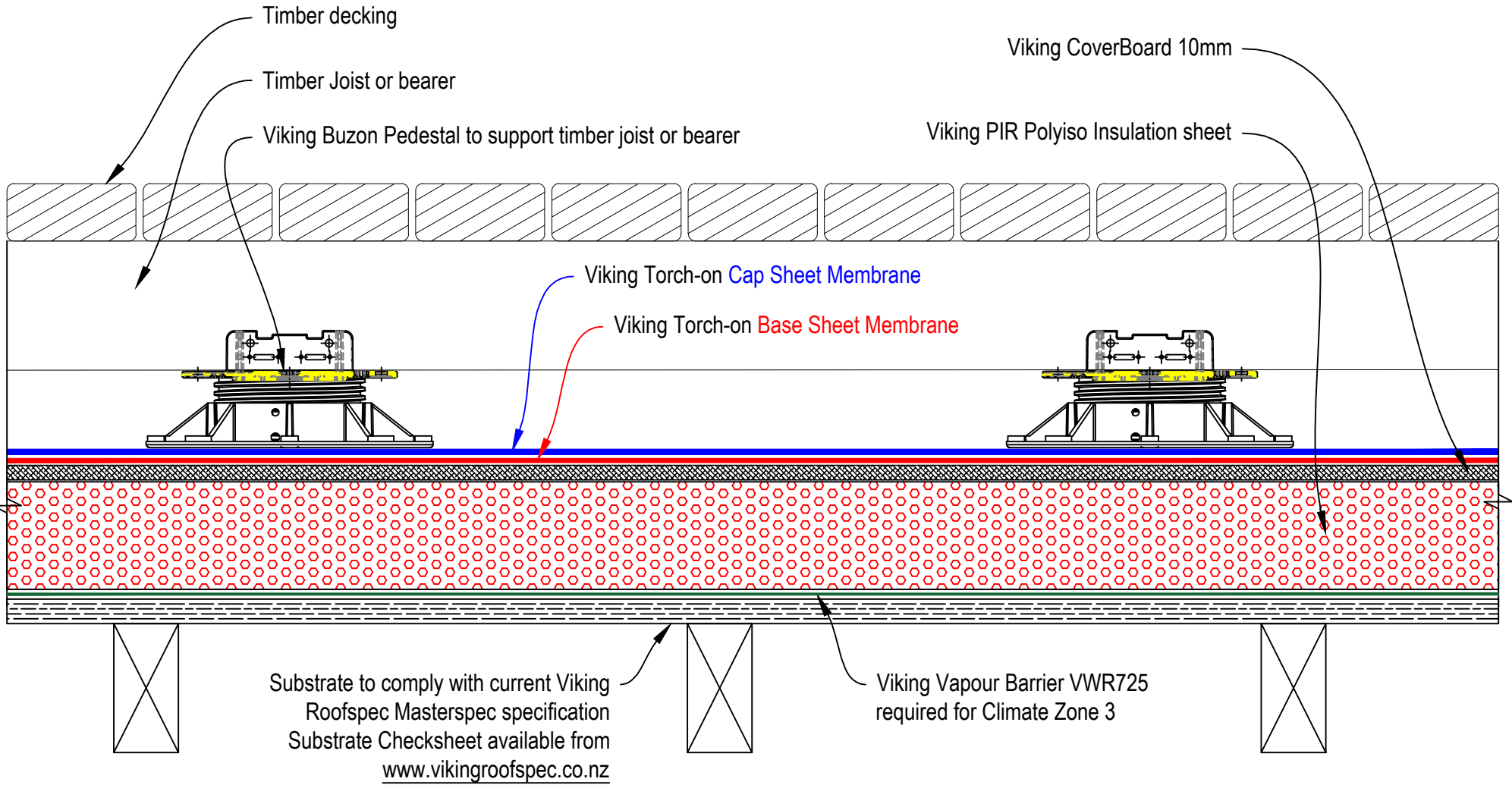

Substrate to comply with current Viking
Roofspec Masterspec specification
Substrate Checksheet available from
www.vikingroofspec.co.nz

Viking Vapour Barrier VWR725
required for Climate Zone 3



DRAWING TITLE
Viking WarmRoof with Viking Torch-on 2 layer membrane System Pedestal system over WarmRoof with Timber Deck

NOTES:
1/ Substrate is Indicative Only. 2/ Refer Viking Torch-on details for further waterproofing info.

DRAWING STATUS		
INFORMATION ONLY		
Not to Scale	DATE 28/5/2018	Detail Ref.
DRAWN	Viking Roofspec	VWR13VT
SERIES	1.10	