

**NOTE:**  
 Substrate to comply with current Viking Roofspec Masterspec specification  
 Substrate Checksheet available from [www.vikingroofspec.co.nz](http://www.vikingroofspec.co.nz)

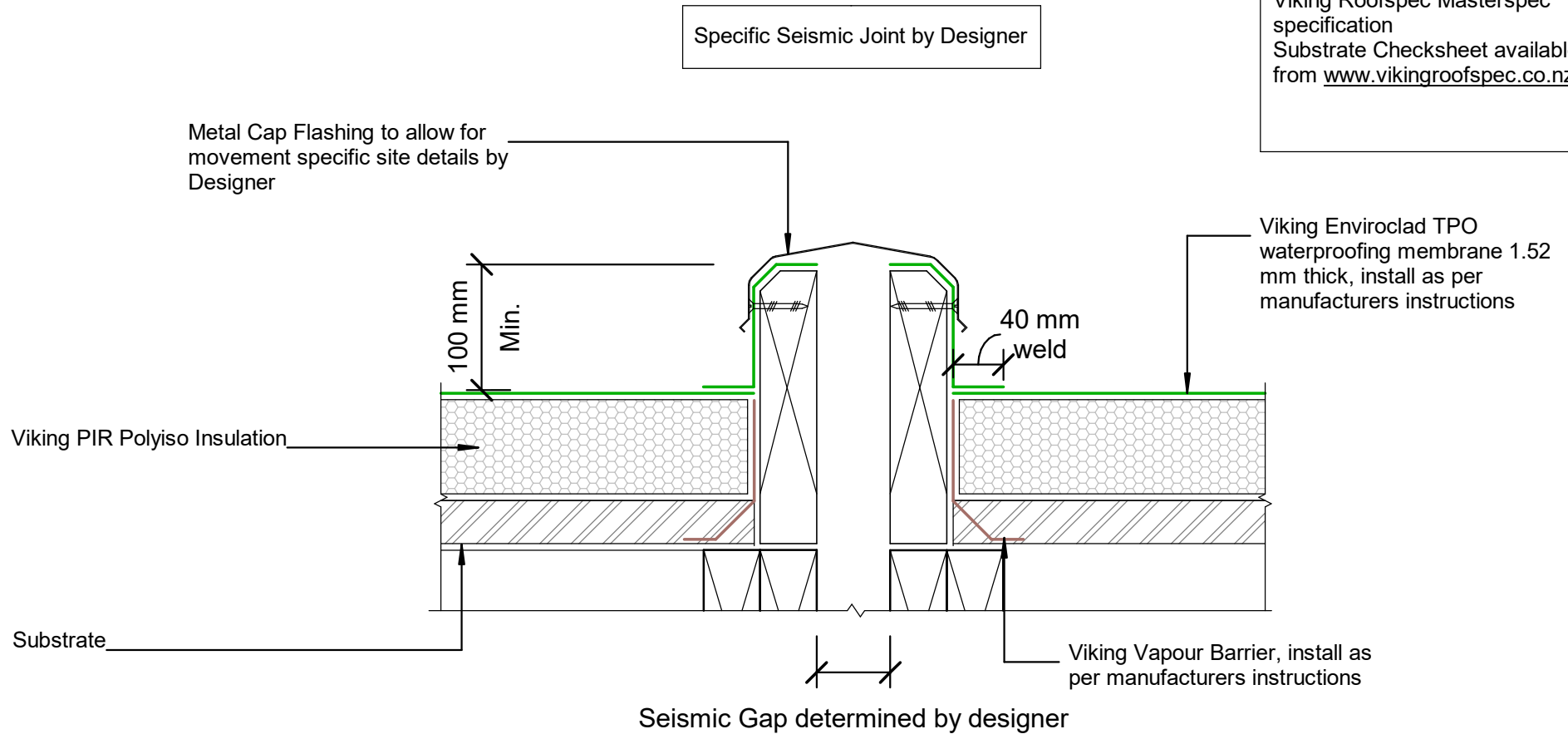

DRAWING TITLE  
**Viking WarmSpan - Enviroclad Intersection\_Seismic Gap Generic**

NOTES:  
 \* Angle fillets are not required at upstands for Enviroclad  
 \* All fixings, cladding and structure are indicative only unless notated  
 \* All details to be read in conjunction with Viking Specifications

WarmSpan System is Branz Appraised - 713

DRAWING INFORMATION ONLY			
Scale:	Date:	Drawn:	Viking
Not to Scale	01/03/2022		
Detail Ref: <b>VIK_WSE_063_INTSSEIS</b>			