

**NOTE:**  
 Substrate to comply with current  
 Viking Roofspec Masterspec  
 specification  
 Substrate Checksheet available  
 from [www.vikingroofspec.co.nz](http://www.vikingroofspec.co.nz)

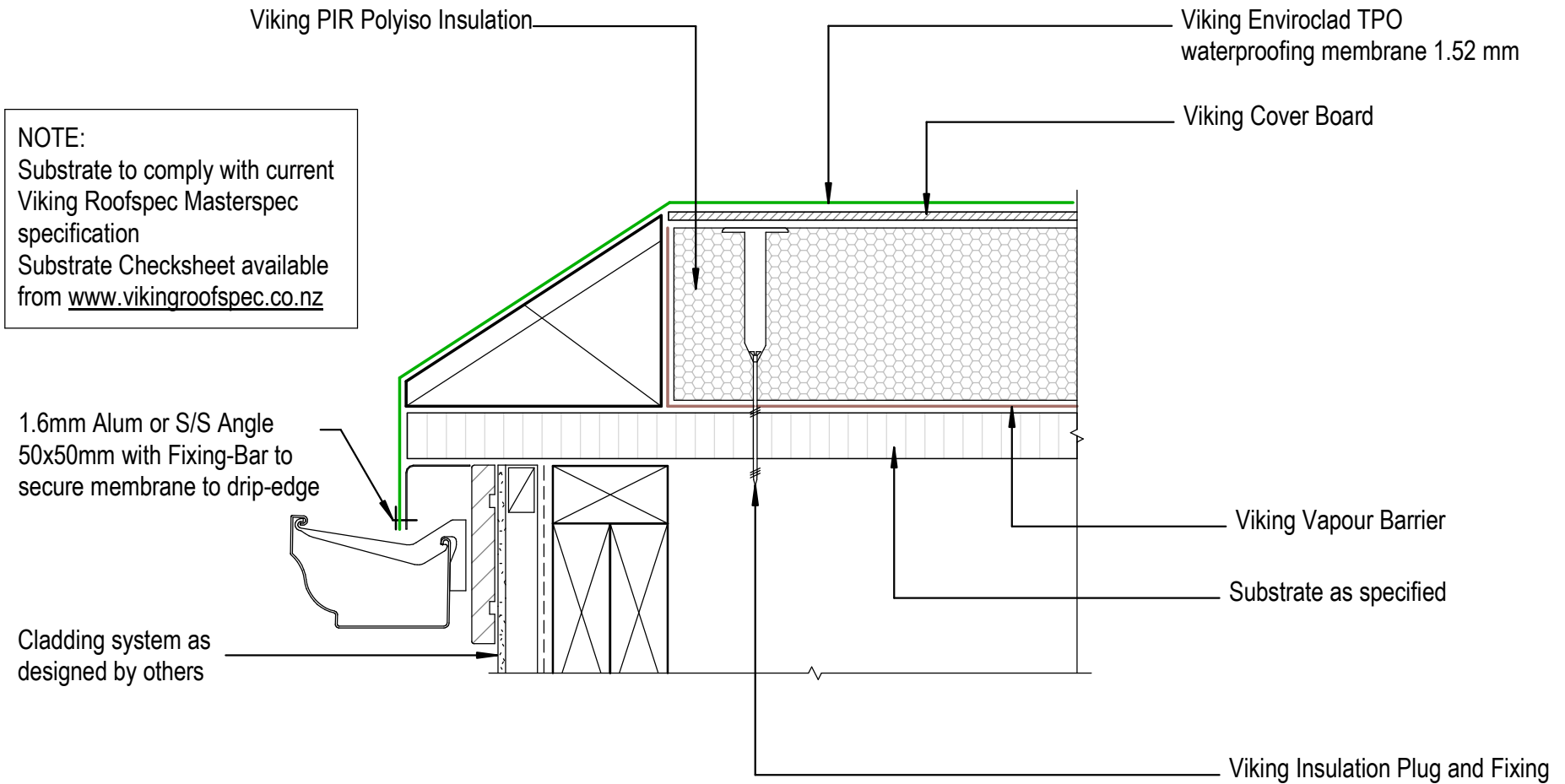

DRAWING TITLE

Viking WS2 - Enviroclad  
 Verge\_Drip edge to External Spouting

NOTES:

- \* Angle fillets are not required at upstands for Enviroclad
- \* All fixings, cladding and structure are indicative only unless noted
- \* All details to be read in conjunction with Viking Specifications

Substrate and structure are indicative only

DRAWING STATUS

INFORMATION ONLY

Scale: Not to Scale	Date: 01/10/2022	Drawn:	Viking
Detail Ref: <b>VIK_WS2_ENV_032_VERGDRIP</b>			