

NOTE:
 This detail is to show a methodology for Saddle-flashings and kick-out diverters at junctions.
 These Saddle-flashings are not supplied by Viking Roofspec as they are fabricated for specific junctions by others to fit various junctions and cladding needs.

NOTE: 2
 Refer Viking Typical details for vented apron details etc.

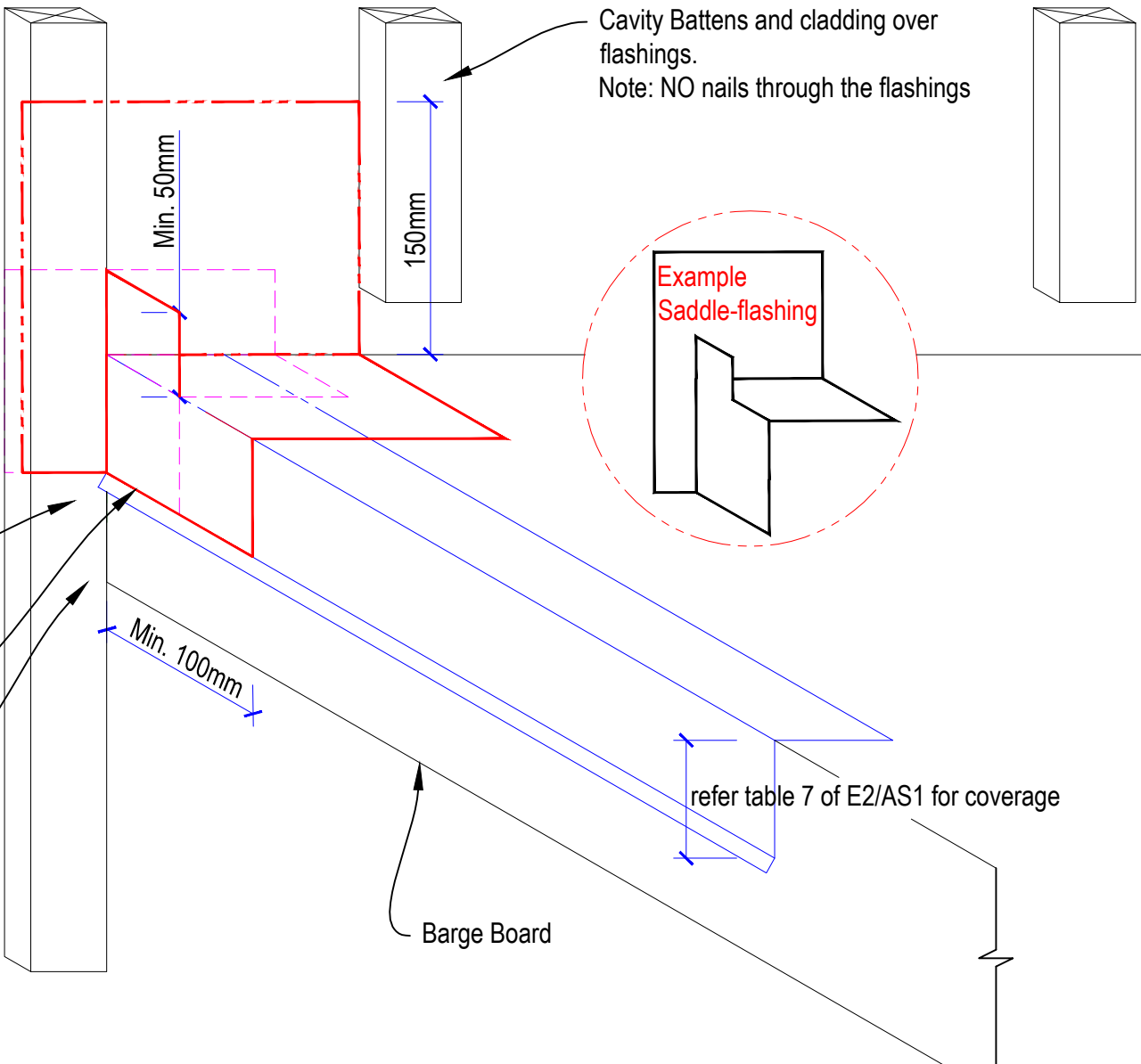

Stage 1 Flexible Flashing tape adhered to wall underlay at rear of cavity minimum 50mm to all surfaces

Barge Flashing

Step 3
 Fabricated Saddle-flashing fitted over flexible flashing tape behind the cavity.
 Size & depth of diverter to suit specified cladding preventing water ingress entering behind cladding and cavity

Cavity Battens and cladding over flashings.
 Note: NO nails through the flashings

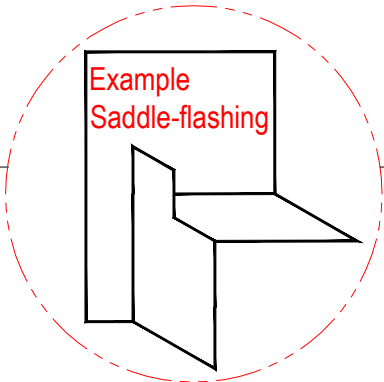

refer table 7 of E2/AS1 for coverage

Barge Board



DRAWING TITLE	
Viking CertainTeed Shingles Saddle-flashing Methodology CT21	

NOTES:
Substrate Indicative Only

DRAWING STATUS			
INFORMATION ONLY			
Not to Scale	DATE 17/11/2016	Detail Ref.	ISSUE
DRAWN	Viking	CT21	A