

Metal Cap Flashing to allow for movement specific site details by Designer

Specific Seismic Joint by Designer

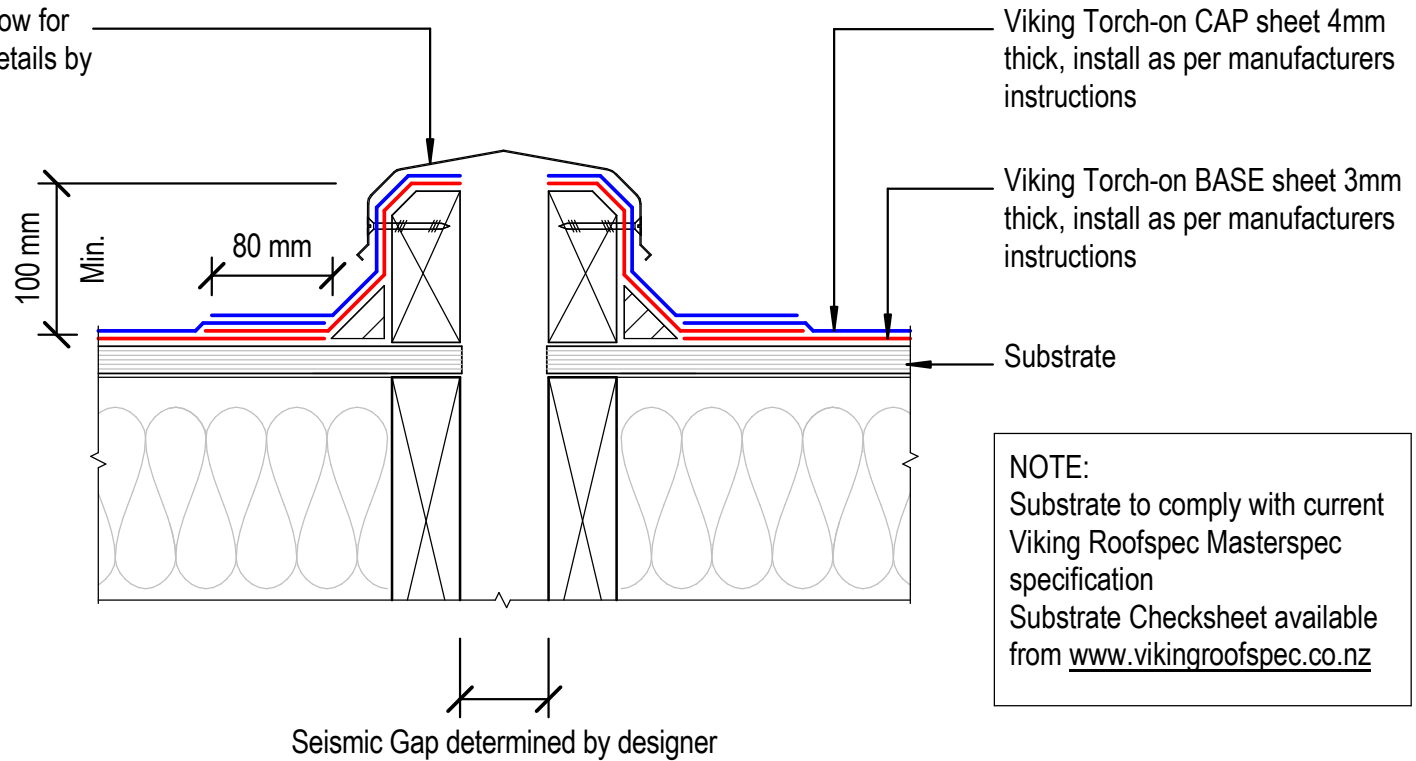

DRAWING TITLE

Viking Torch-On  
Intersection\_Seismic Gap Generic

NOTES:

- Viking Waterproof Membrane as notated can be Viking Gemini, Lybra or Phoenix Super.
- All fixings, cladding and structure are indicative only unless notated.

**CodeMark**

Cert # GM-CMNZ30092

Cert # BV-CMNZ70171

Viking Torch-On systems are CodeMarked

DRAWING

INFORMATION ONLY

Scale:

Not to Scale

Date:

23/11/2020

Drawn:

Viking

Detail Ref:

**VIK\_TOR\_063\_INTSSEIS**

**Viking** Roofspec  
Taking care of detail