

NOTE:
 TPO Weldable Rib to be Welded directly to Enviroclad TPO membrane, with no penetrations. Ribs can be placed at any point along the roof as long as they don't inhibit watershed

NOTE:
 Substrate to comply with current Viking Roofspec Masterspec specification
 Substrate Checksheet available from www.vikingroofspec.co.nz

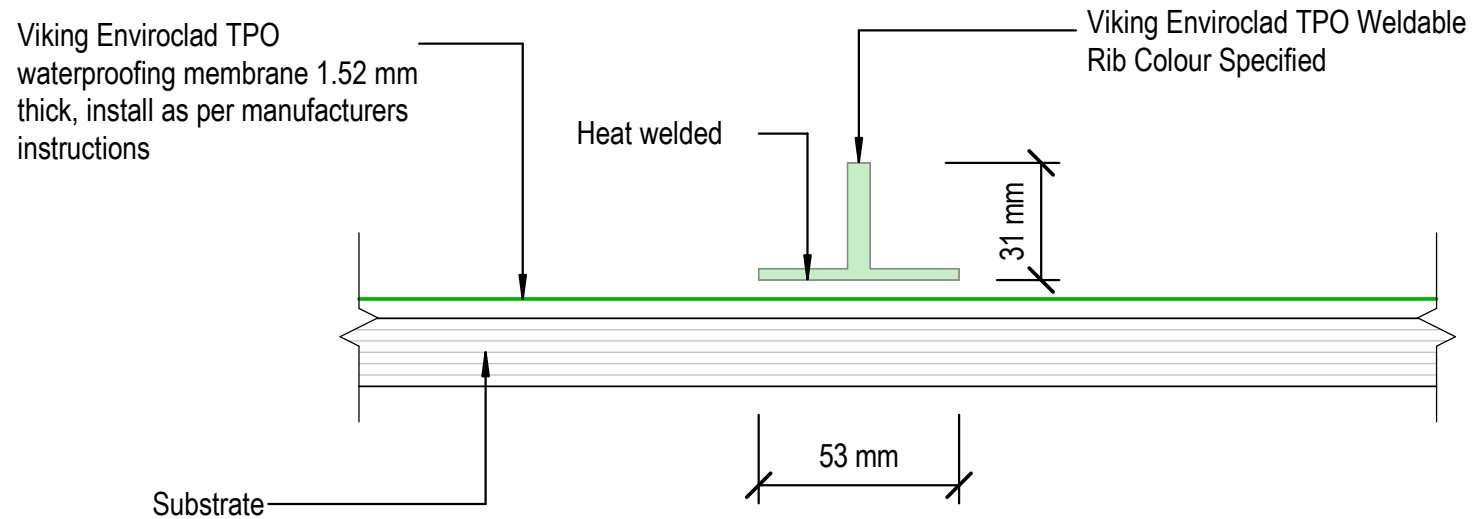

DRAWING TITLE

Viking Enviroclad
 Accessories_Enviroclad TPO Weldable Rib

NOTES:

* Angle fillets are not required at upstands for Enviroclad
 * All fixings, cladding and structure are indicative only unless notated

CodeMark

Cert # GM-CMNZ30058
 Cert # BV-CMNZ70176
 Enviroclad systems are CodeMarked

DRAWING

INFORMATION ONLY

Scale:	Date:	Drawn:	Viking
Not to Scale	23/11/2020		

Detail Ref: **VIK_ENV_120_ACCTPOWR**

Viking Roofspec
 Taking care of detail