

NOTE:  
 Substrate to comply with current Viking  
 Roofspec Masterspec specification  
 Substrate Checksheet available from  
[www.vikingroofspec.co.nz](http://www.vikingroofspec.co.nz)

NOTE:  
 Precast concrete with no voids  
 Blockwork requires a flush finish to side  
 of tanking

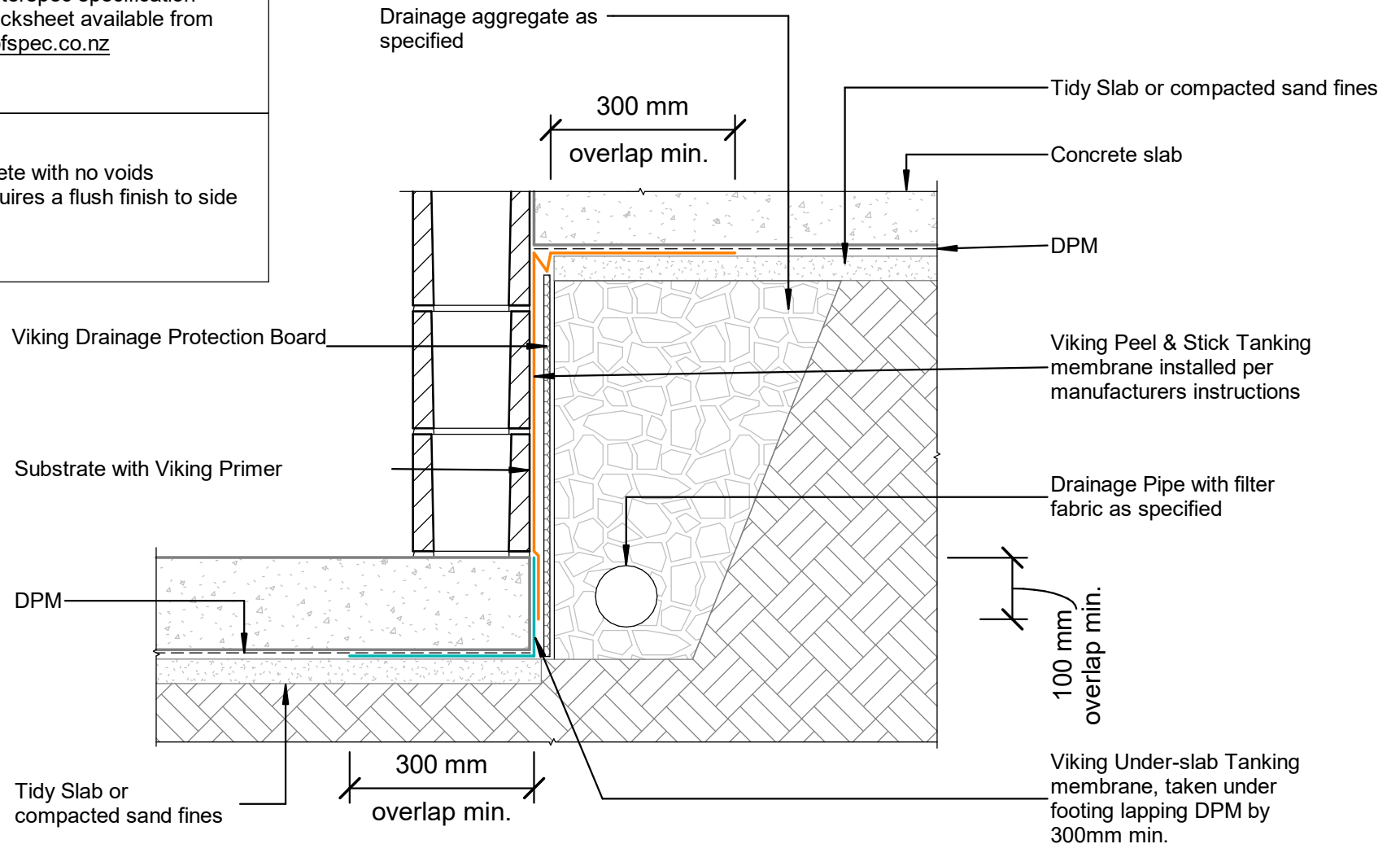

DRAWING TITLE

Viking Tanking - Peel & Stick  
 Junction\_Multi-level Connection

NOTES:

\* All fixings, cladding and structure are  
 indicative only unless notated  
 \* Drawings to be read with Viking  
 Specifications

INFORMATION

Viking Tanking systems are  
 BRANZ Appraised - 826

DRAWING

INFORMATION ONLY

Scale:	Date:	Drawn:	Viking
Not to Scale	01/03/2022		
Detail Ref:			<b>VIK_BGT_PS_04</b>