

Viking Enviroclad TPO waterproofing membrane 1.52 mm thick, install as per manufacturers instructions

Viking 80mmØ clamped drain SDM049 with 304 S/S domed grate, installed as per manufacturers instructions.

Viking 80mmØ clamped overflow drain SDM049 with 304 S/S domed grate, installed as per manufacturers instructions.

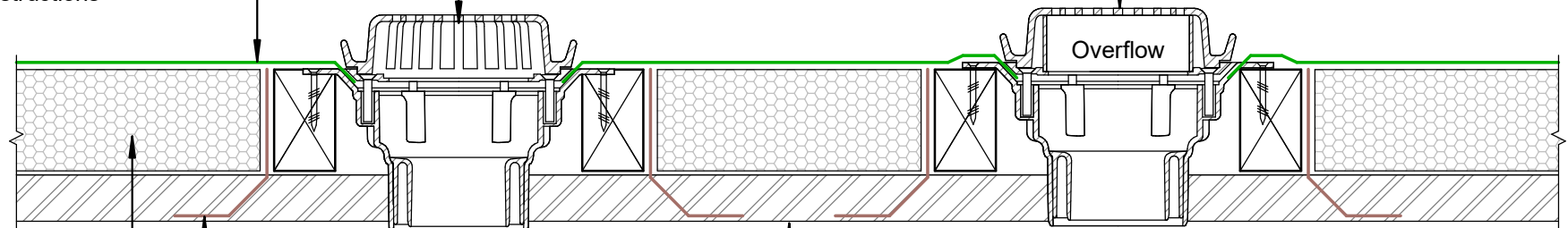

Viking PIR Polyiso Insulation

Substrate

Viking Vapour Barrier, install as per manufacturers instructions

Flange width 230mm
(280mm for 150mm outlet)

NOTE:

- 1/ Overflow to match outlet capacity.
- 2/ Overflow to be plumbed independent of stormwater, through soffit or exterior wall

NOTE:

Substrate to comply with current Viking Roofspec Masterspec specification
Substrate Checksheet available from www.vikingroofspec.co.nz

DRAWING TITLE

Viking WarmSpan - Enviroclad Penetration_Outlet and Overflow

NOTES:

- * Angle fillets are not required at upstands for Enviroclad
- * All fixings, cladding and structure are indicative only unless notated
- * All details to be read in conjunction with Viking Specifications

WarmSpan System is Branz Appraised - 713

DRAWING

INFORMATION ONLY

Scale:	Date:	Drawn:	Viking
Not to Scale	01/03/2022		

Detail Ref: **VIK_WSE_001_PENEOUTL**