

Finish Membrane 100mm
min. up framing at ends.
Width to suit joinery and
cladding. Refer E2/AS1
FIG62(b)(d)

Finished Floor Level

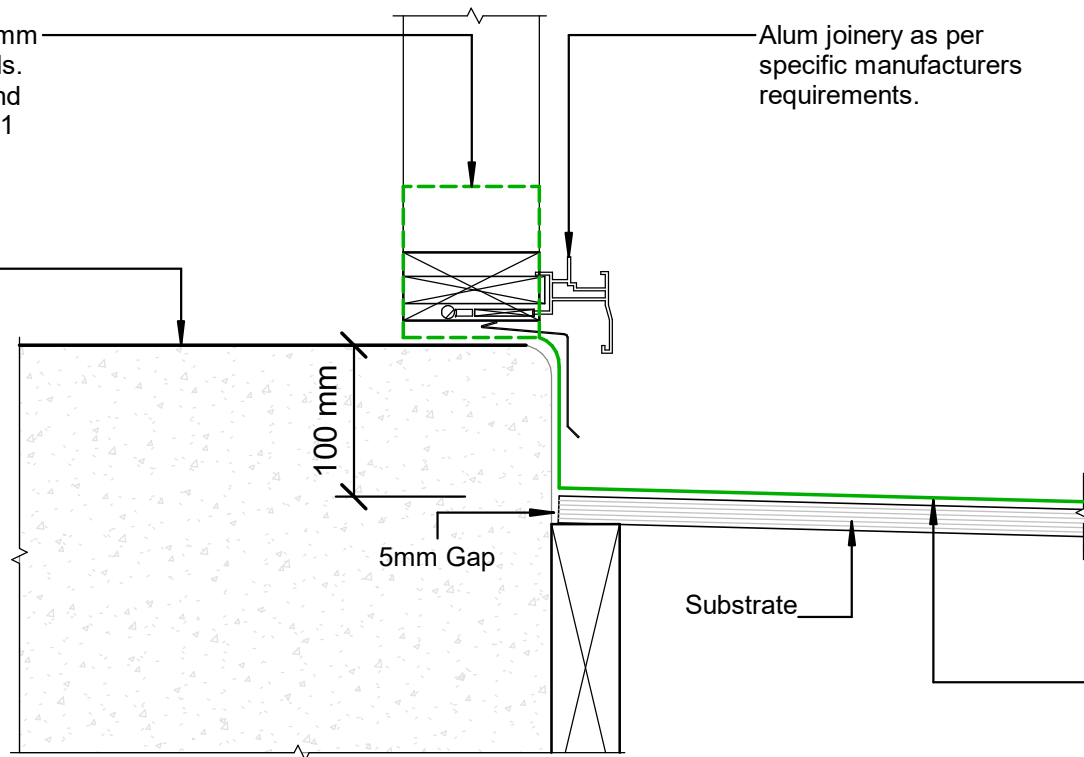

Alum joinery as per
specific manufacturers
requirements.

NOTE:
Substrate to comply with current
Viking Roofspec Masterspec
specification
Substrate Checksheet available
from www.vikingroofspec.co.nz

Viking Enviroclad TPO
waterproofing membrane 1.52
mm thick, install as per
manufacturers instructions

DRAWING TITLE

Viking Enviroclad
Threshold_Door

NOTES:

- * Angle fillets are not required at upstands for Enviroclad
- * All fixings, cladding and structure are indicative only unless notated



Enviroclad
systems are
CodeMarked

DRAWING

INFORMATION ONLY

Scale: Not to Scale	Date: 23/11/2020	Drawn: Viking
------------------------	---------------------	------------------

Detail Ref
VIK_ENV_090_DOORTHRS