

NOTE: How many vents?
Refer Viking Technical Note Venting .

NOTE: Refer TOR_004 for Direction of Plinth to watershed

Viking 215mm high roof vent IMV111 with black dome, installed as per manufacturers instructions.

NOTE: Venting not required if specifying Viking WarmRoof or WarmSpan systems

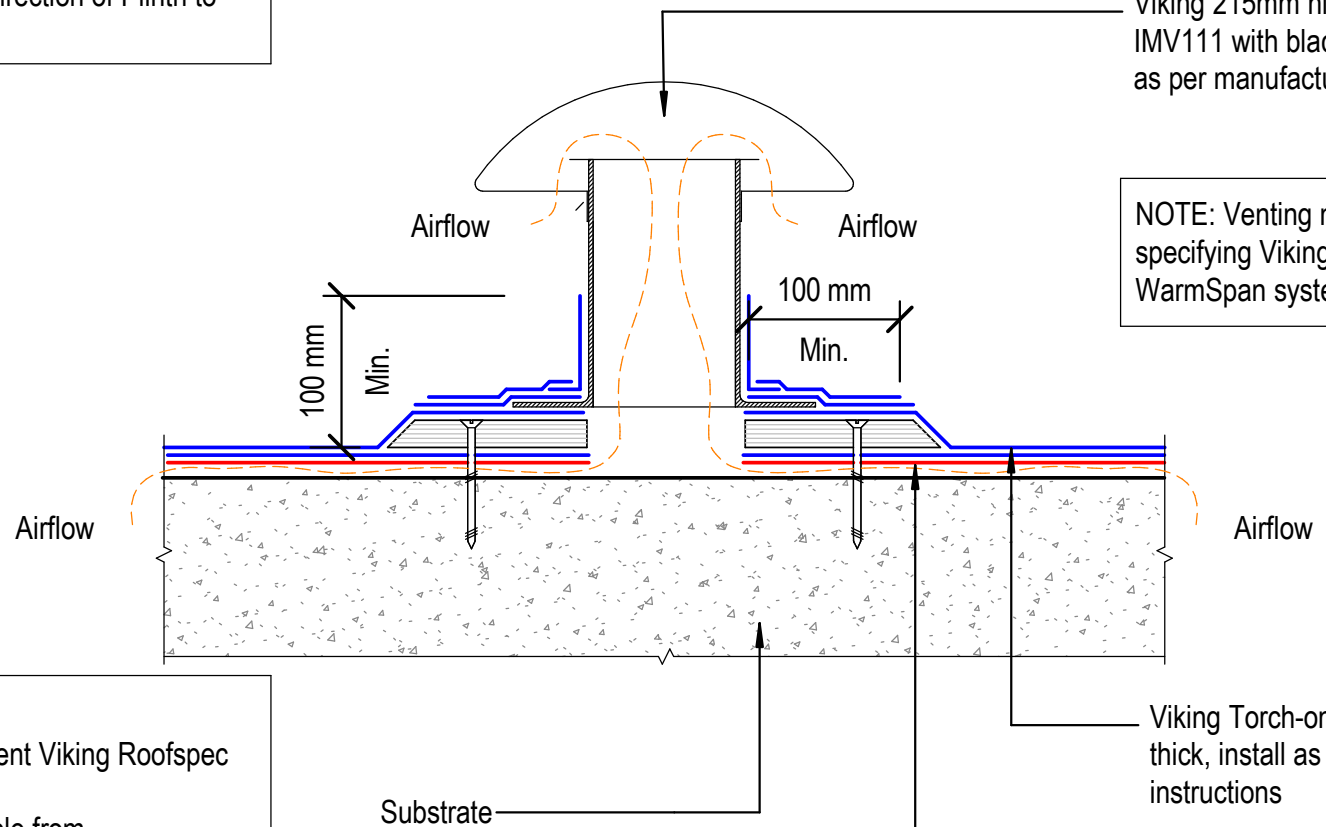

NOTE:
Substrate to comply with current Viking Roofspec Masterspec specification
Substrate Checksheet available from www.vikingroofspec.co.nz

Viking Torch-on CAP sheet 4mm thick, install as per manufacturers instructions

Viking Torch-on Isolink Vented Base Sheet 3mm thick, installed as per manufacturers instructions

DRAWING TITLE

Viking Torch-On
Ventilation_Substrate Roof vent for concrete

NOTES:

- Viking Waterproof Membrane as notated can be Viking Gemini, Lybra or Phoenix Super.
- All fixings, cladding and structure are indicative only unless notated.

CodeMark

Cert # GM-CMNZ30092
Cert # BV-CMNZ70171

Viking Torch-On systems are CodeMarked

DRAWING

INFORMATION ONLY

Scale:	Date:	Drawn:	Viking
Not to Scale	23/11/2020		

Detail Ref: **VIK_TOR_020C_VENTROOF**

Viking Roofspec
Taking care of detail