

NOTE:  
 Substrate to comply with current Viking Roofspec  
 Masterspec specification  
 Substrate Checksheet available from  
[www.vikingroofspec.co.nz](http://www.vikingroofspec.co.nz)

NOTE:  
 A 5° fall is recommended for pipe penetrations

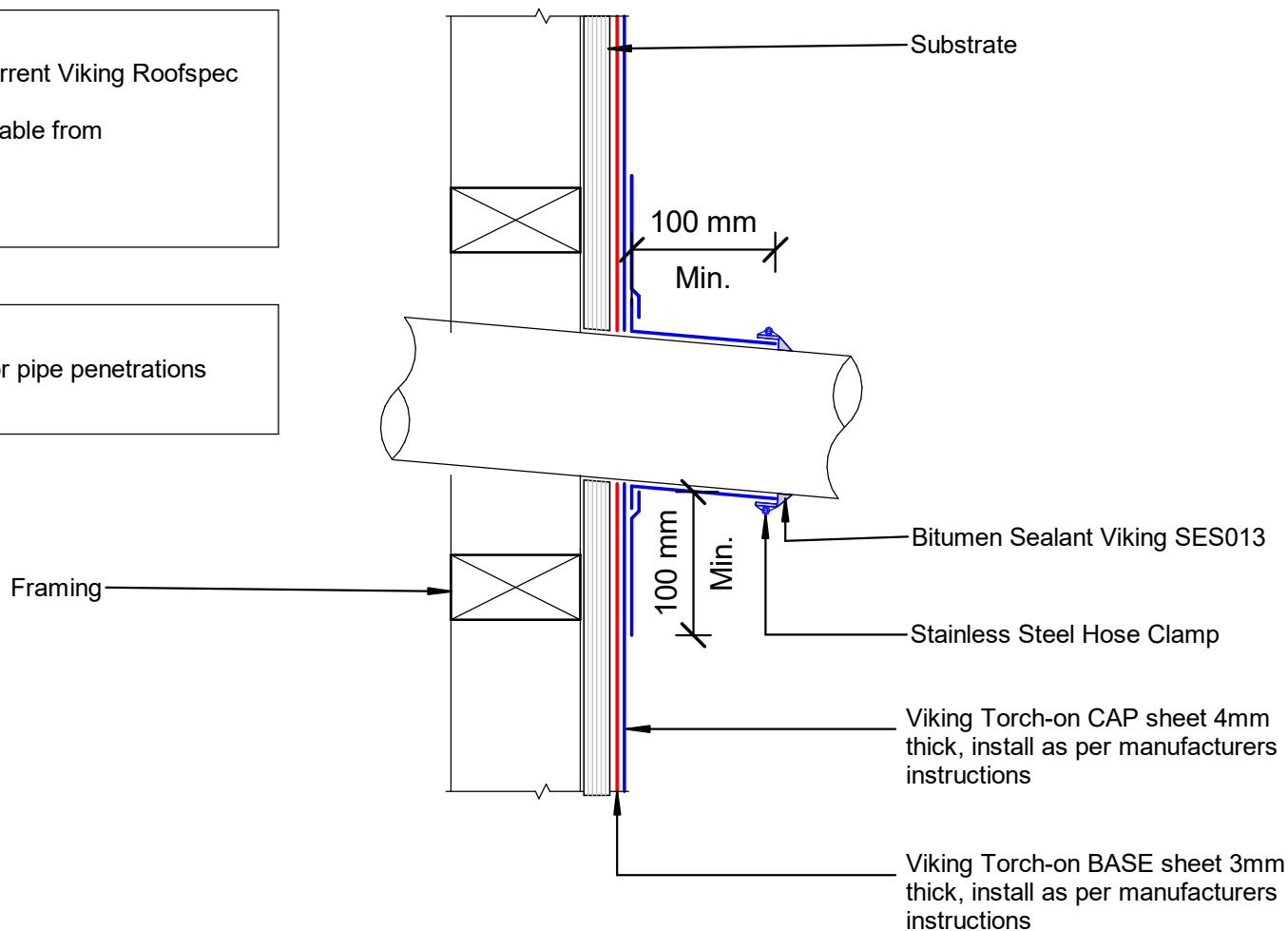

DRAWING TITLE

Viking Torch-On  
 Penetration\_Horizontal pipe

NOTES:

- Viking Waterproof Membrane as notated can be Viking Gemini, Lybra or Phoenix Super.
- All fixings, cladding and structure are indicative only unless notated.



Viking Torch-On  
 systems are  
 CodeMarked

DRAWING

INFORMATION ONLY

Scale:	Date:	Drawn:	Viking
Not to Scale	23/11/2020		
Detail Ref: <b>VIK_TOR_005A_HORPIPE</b>			