

Viking Enviroclad TPO
waterproofing membrane 1.52 mm

Viking Cover Board

Cladding to Overlap
membrane by a minimum
50mm

Overflow level
(Max.high-point of deck)

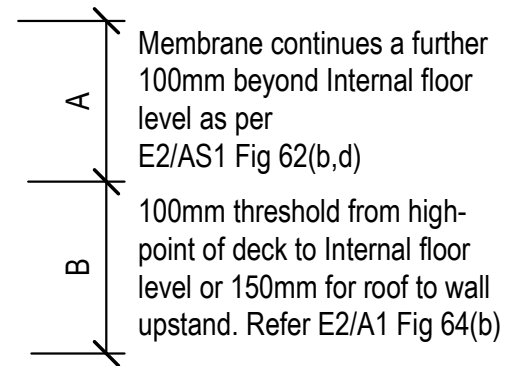

NOTE:
Substrate to comply with
current Viking Roofspec
Masterspec specification
Substrate Checksheet
available from
www.vikingroofspec.co.nz

Viking Insulation Plug and Fixing

Substrate as specified

Viking PIR Polyiso Insulation

Viking Vapour Barrier

Viking 80mmØ clamped drain
SDM049 with 304 S/S domed
grate

DRAWING TITLE

Viking WS2 - Enviroclad
Internal Gutter_to Wall

NOTES:

- * Angle fillets are not required at upstands for Enviroclad
- * All fixings, cladding and structure are indicative only unless notated
- * All details to be read in conjunction with Viking Specifications

Substrate and structure are
indicative only

DRAWING STATUS

INFORMATION ONLY

Scale: Not to Scale	Date: 01/10/2022	Drawn: Viking
Detail Ref: VIK_WS2_ENV_051_GUTTWALL		

