

NOTE:
 Substrate to comply with current
 Viking Roofspec Masterspec
 specification
 Substrate Checksheet available
 from www.vikingroofspec.co.nz

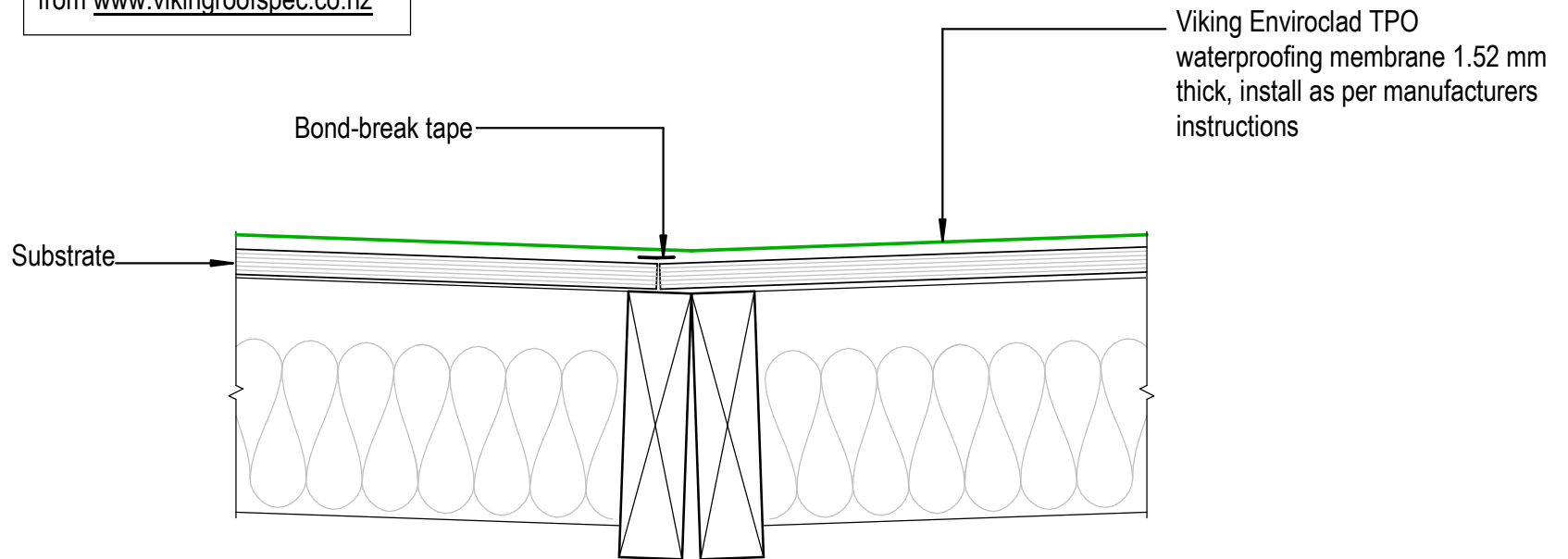

DRAWING TITLE

Viking Enviroclad
 Intersection_Valley

NOTES:

- * Angle fillets are not required at upstands for Enviroclad
- * All fixings, cladding and structure are indicative only unless notated

CodeMark

Cert # GM-CMNZ30058
 Cert # BV-CMNZ70176
 Enviroclad systems are CodeMarked

DRAWING

INFORMATION ONLY

Scale:	Date:	Drawn:	Viking
Not to Scale	23/11/2020		

Detail Ref: **VIK_ENV_065_INTSVALL**

Viking Roofspec
 Taking care of detail