

Viking Enviroclad TPO
waterproofing membrane 1.52 mm

Substrate as specified

Engineered Plant Mount
support Brackets
fixed to round posts above
waterproofing.

Viking Enviroclad TPO
waterproofing membrane 1.52 mm

Viking Insulation Plug and Fixing

Viking PIR Polyiso Insulation

Viking Vapour Barrier

Substrate as specified

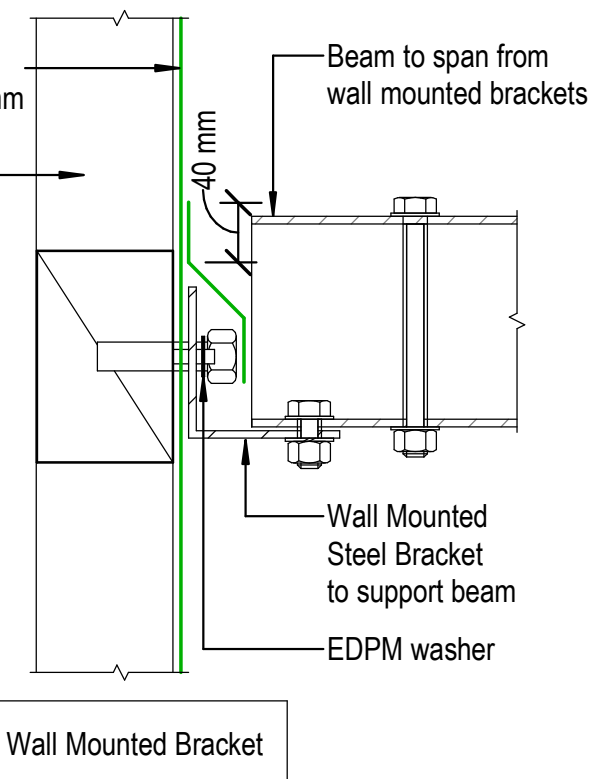

NOTE:
Post and Brackets are SED.
Spaced according to weight and beam spanning abilities.
Not supplied by Viking Roofspec.

DRAWING TITLE

Viking WS2 - Enviroclad
Penetration_Post or Rail for Plant Room equipment

NOTES:

- * Angle fillets are not required at upstands for Enviroclad
- * All fixings, cladding and structure are indicative only unless noted
- * All details to be read in conjunction with Viking Specifications

Substrate and structure are
indicative only

DRAWING STATUS

INFORMATION ONLY

Scale:
Not to Scale

Date:
01/10/2022

Drawn: Viking

Detail Ref: **VIK_WS2_ENV_011_PENEPOST**