

NOTE:
 Substrate to comply with current Viking Roofspec Masterspec specification
 Substrate Checksheet available from www.vikingroofspec.co.nz

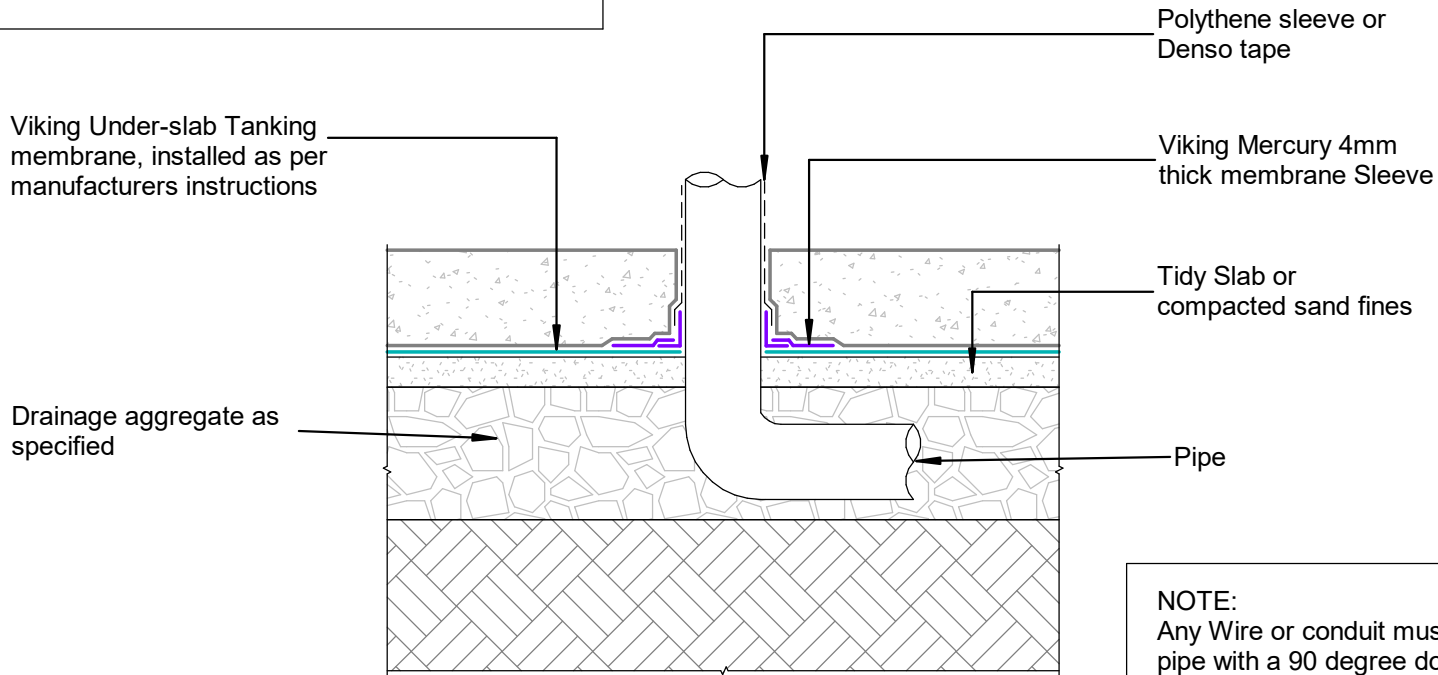

NOTE:
 Any Wire or conduit must be feed through a PVC pipe with a 90 degree downturn

NOTE:
 Pipe work must be firmly supported to the substrate prior to tanking commencing



DRAWING TITLE
Viking Below Ground Tanking - Torch -On Penetration_Pipe through Slab

NOTES:
* All fixings, cladding and structure are indicative only unless notated
* Drawings to be read with Viking Specifications

INFORMATION
Viking Tanking systems are BRANZ Appraised - 864

DRAWING INFORMATION ONLY			
Scale:	Date:	Drawn:	Viking
Not to Scale	01/03/2022		
Detail Ref:			VIK_BGT_TO_21