

DRAWING TITLE
Viking CertainTeed Shingles General Roof details

NOTES:
Substrate Indicative Only

DRAWING STATUS			
INFORMATION ONLY			
Not to Scale	DATE 17/11/2016	Detail Ref:	ISSUE
DRAWN	Viking	Details	A

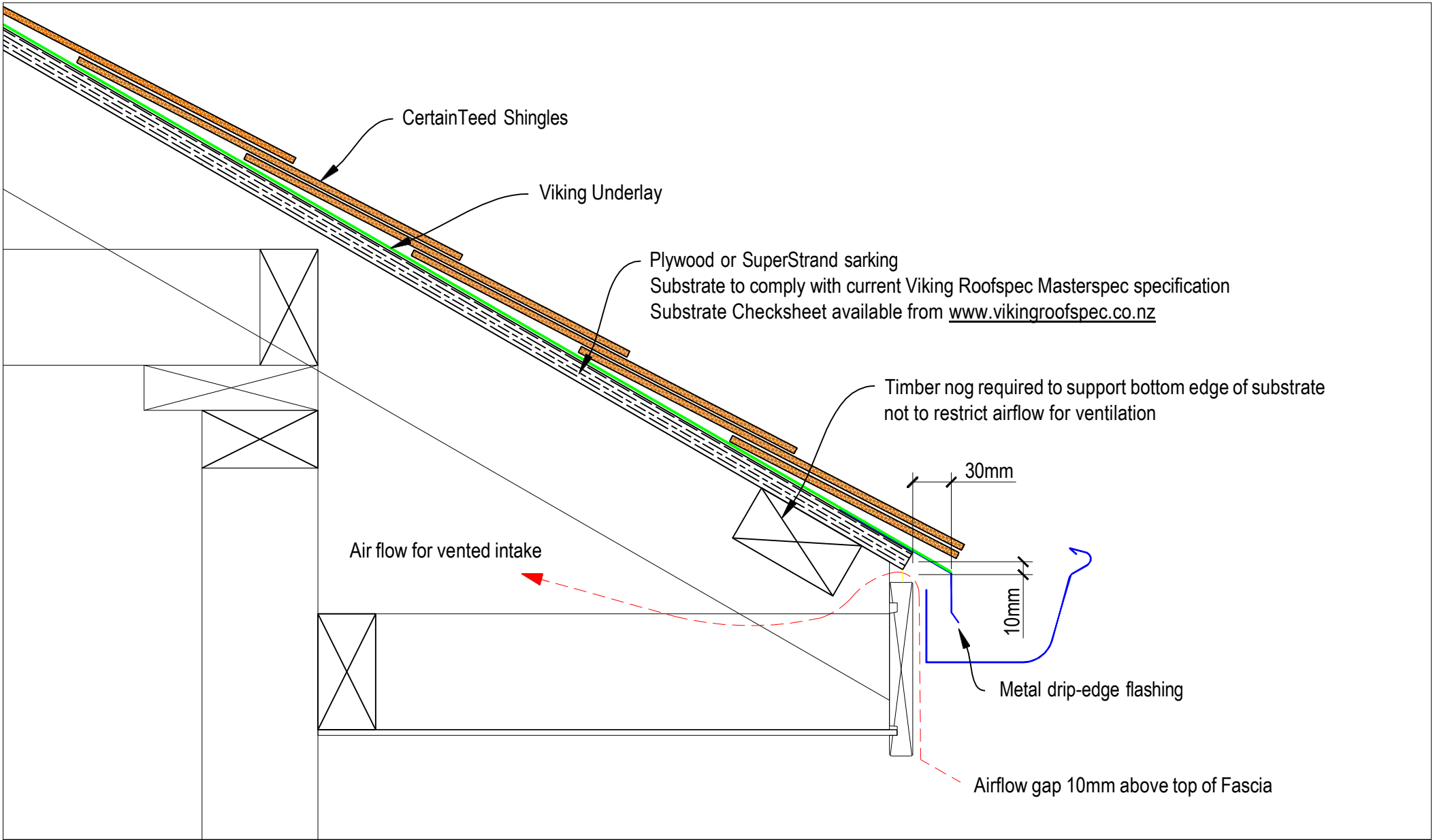

DRAWING TITLE
Viking CertainTeed Shingles Vented Drip-edge Detail CT01

NOTES:
Substrate Indicative Only

DRAWING STATUS			
INFORMATION ONLY			
Not to Scale	DATE 17/11/2016	Detail Ref.	ISSUE
DRAWN	Viking	CT01	A

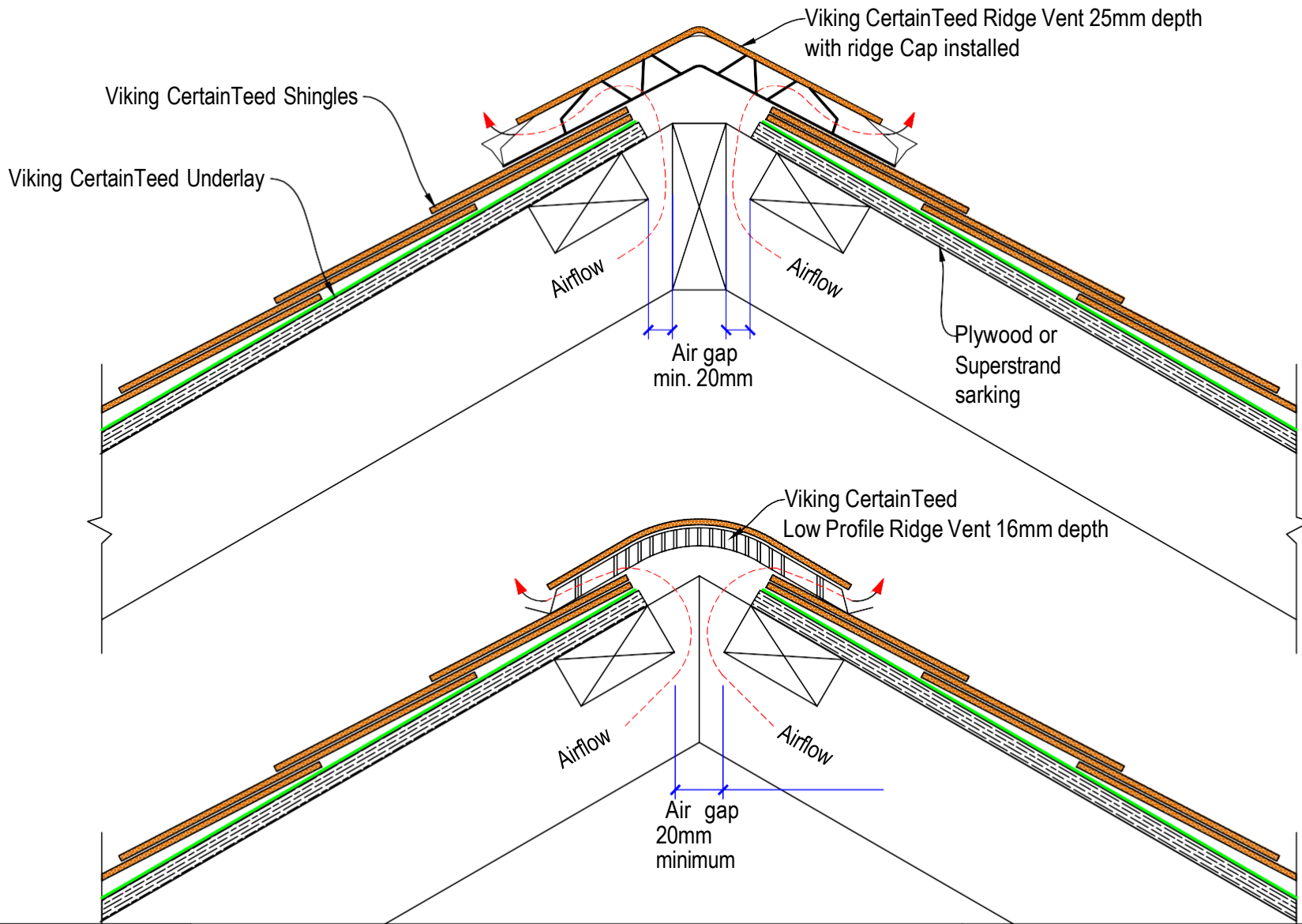

DRAWING TITLE  
**Viking CertainTeed Shingles  
 Ridge Vent Detail CT02**

NOTES:  
**Substrate Indicative Only**

DRAWING STATUS			
INFORMATION ONLY			
Not to Scale	DATE 17/11/2016	Detail Ref.	ISSUE
DRAWN	Viking	CT02	A

NOTE: Min. shingle roof pitch is 9°

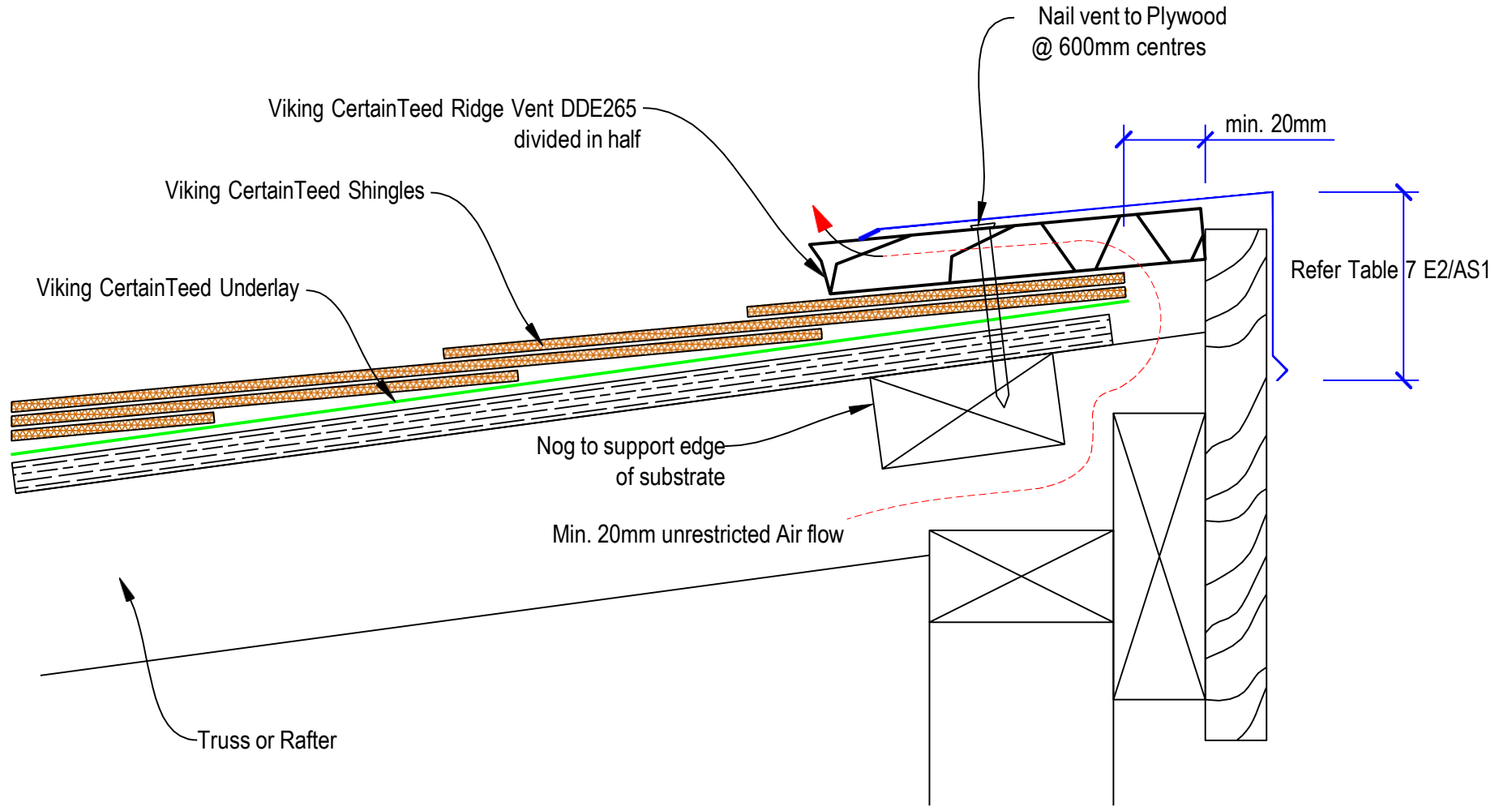

DRAWING TITLE
Viking CertainTeed Shingles Monopitch Ridge Vent Detail CT03

NOTES:
Substrate Indicative Only

DRAWING STATUS			
INFORMATION ONLY			
Not to Scale	DATE 17/11/2016	Detail Ref:	ISSUE
DRAWN	Viking	CT03	A

\* Alternative ventilation consider venting through the membrane roof area if roof structure allows good unrestricted airflow. Allow additional cavity vent for every 50m2 pitched roof area

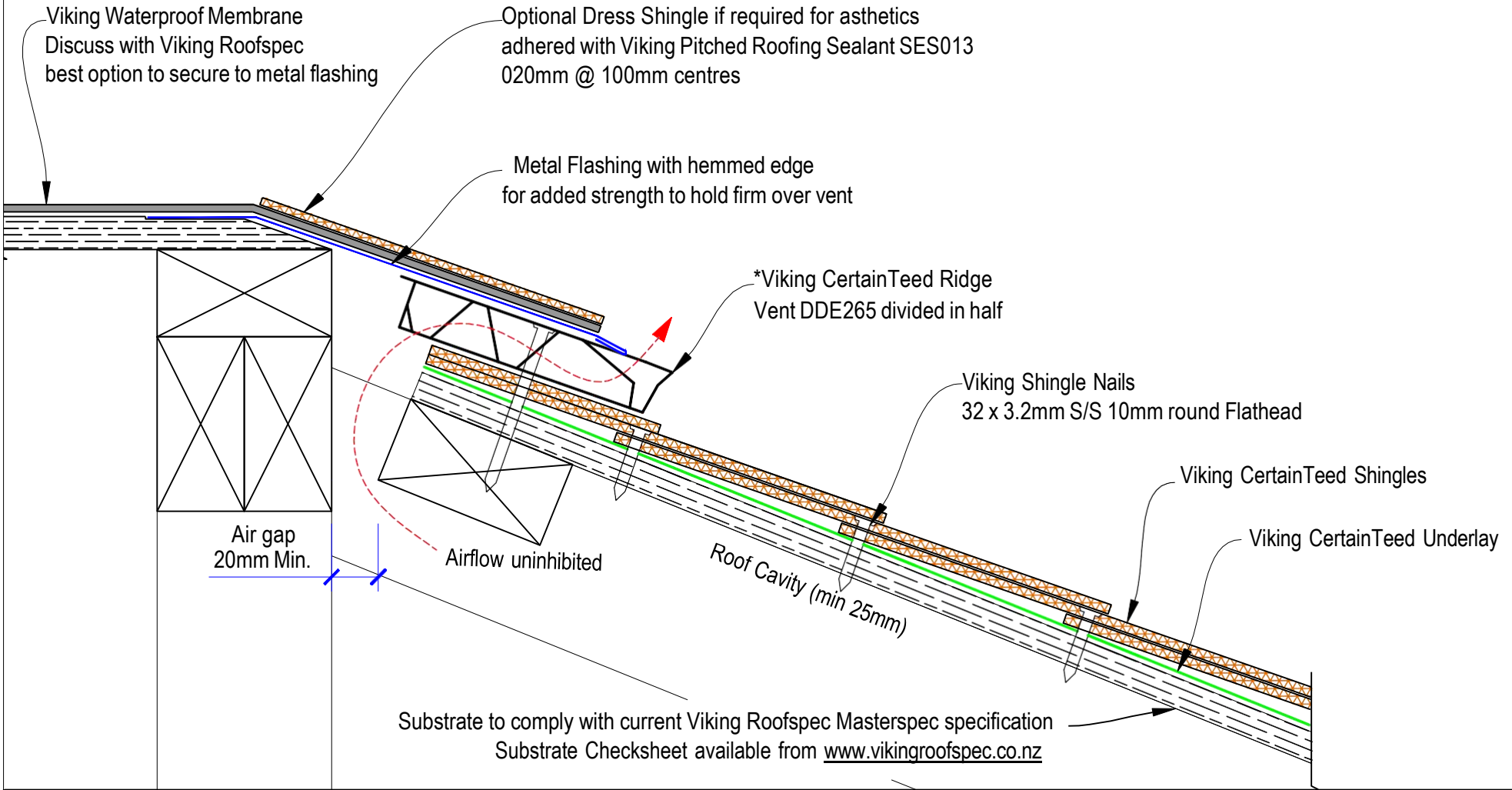

DRAWING TITLE
Viking CertainTeed Shingles Mansard Vented edge Detail CT04

NOTES:
Substrate Indicative Only

DRAWING STATUS			
INFORMATION ONLY			
Not to Scale	DATE 17/11/2016	Detail Ref:	ISSUE
DRAWN Viking	CT04	A	

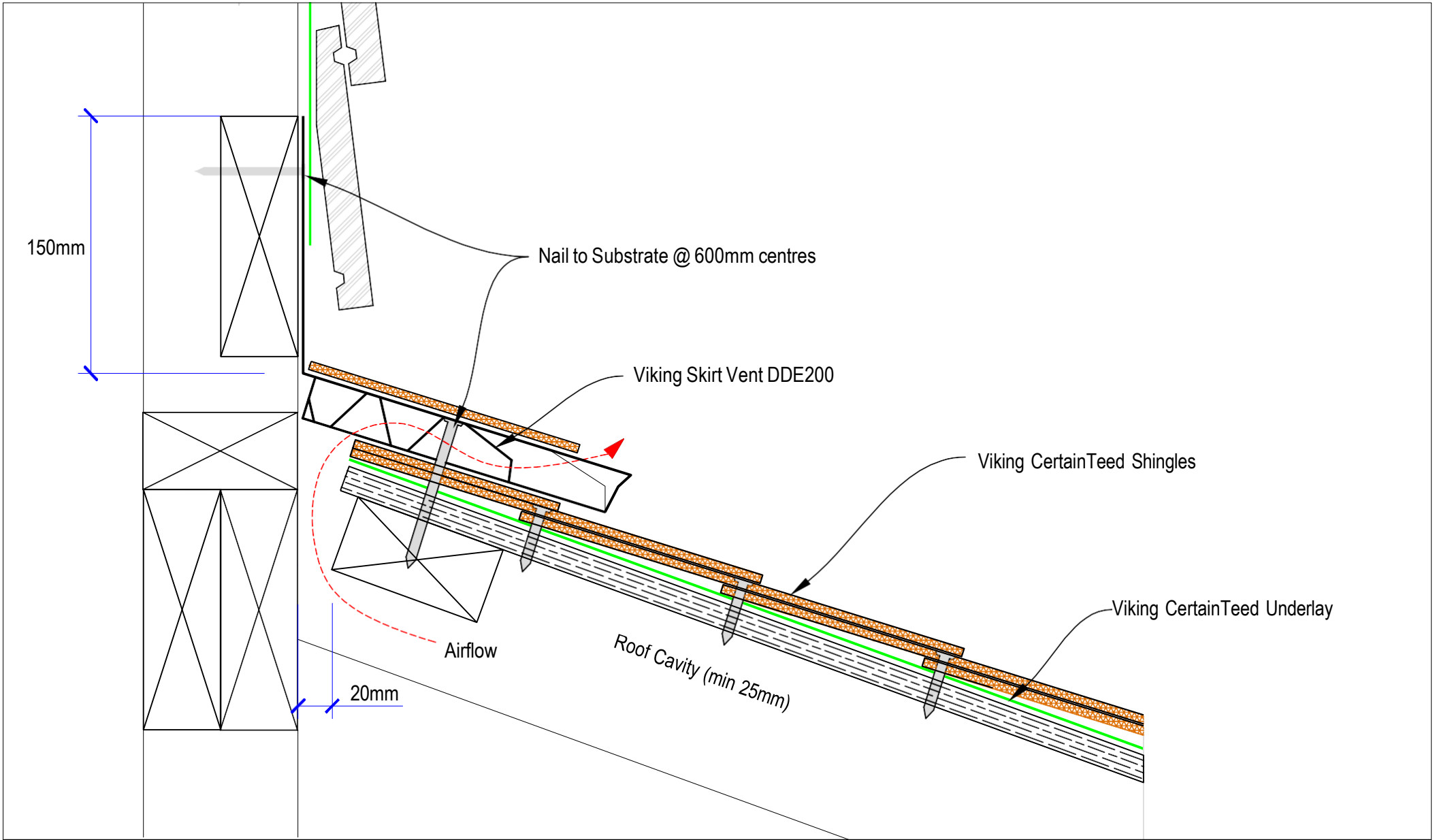

DRAWING TITLE

Viking CertainTeed Shingles  
Lower Vented Roof Detail CT05

NOTES:

Substrate Indicative Only

DRAWING STATUS

INFORMATION ONLY

Not to Scale	DATE 17/11/2016	Detail Ref.	ISSUE
DRAWN Viking		CT05	A



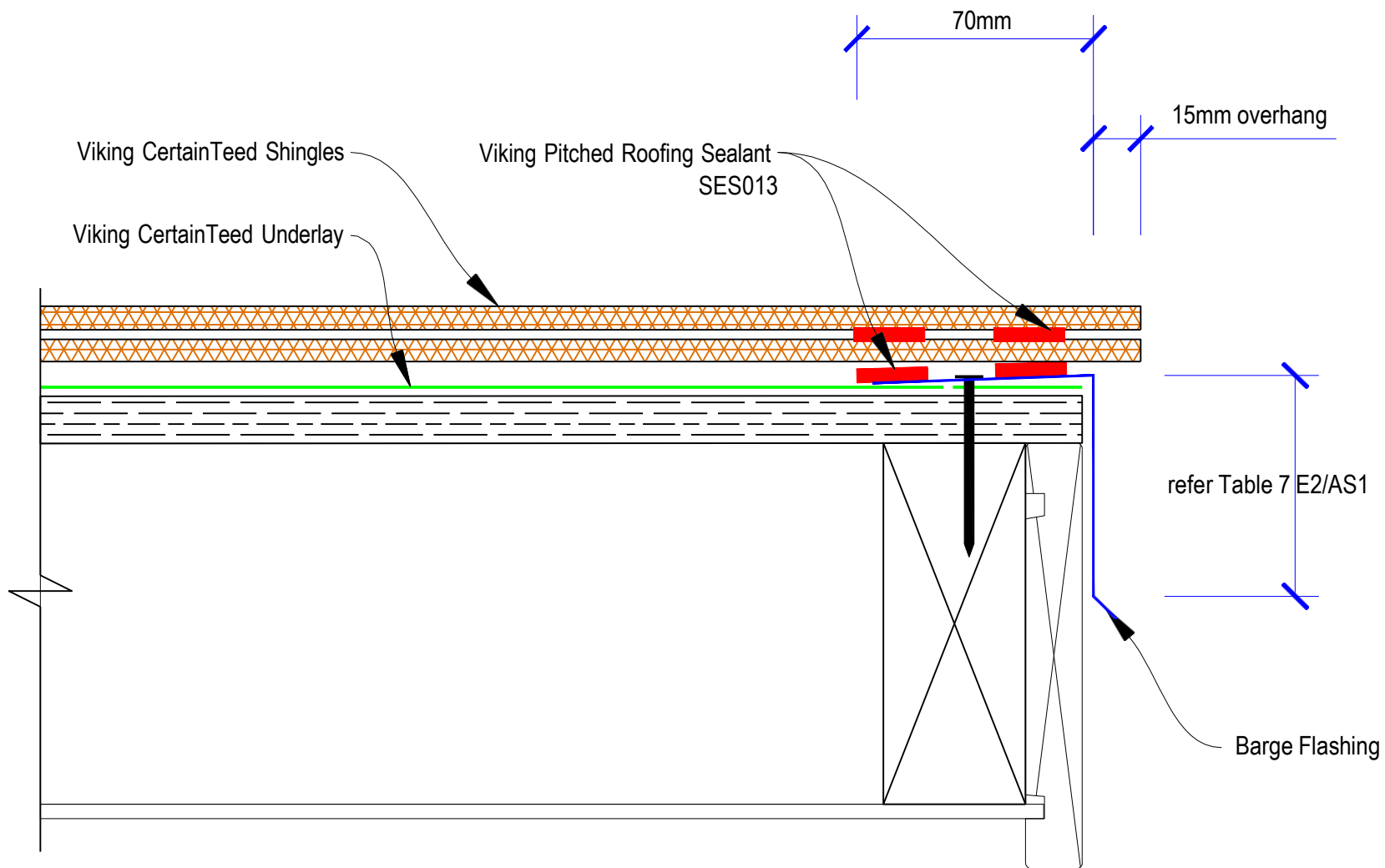

DRAWING TITLE
Viking CertainTeed Shingles Barge edge Detail CT06

NOTES:
Substrate Indicative Only

DRAWING STATUS			
INFORMATION ONLY			
Not to Scale	DATE 17/11/2016	Detail Ref:	ISSUE
DRAWN	Viking	CT06	A

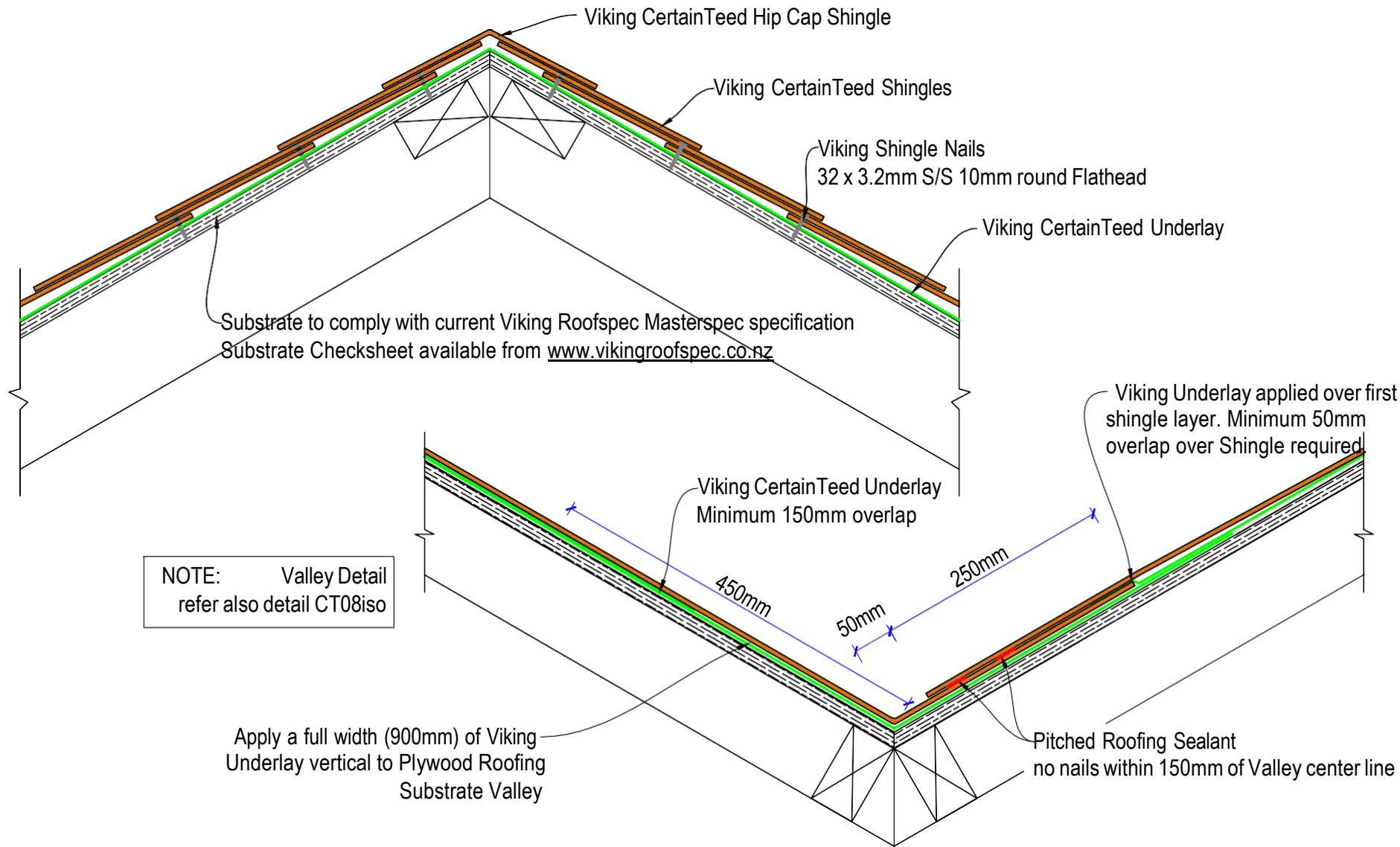

DRAWING TITLE
Viking CertainTeed Shingles Hip & Valley Detail CT07

NOTES:
Substrate Indicative Only

DRAWING STATUS			
INFORMATION ONLY			
Not to Scale	DATE 17/11/2016	Detail Ref:	ISSUE
DRAWN	Viking	CT07	A

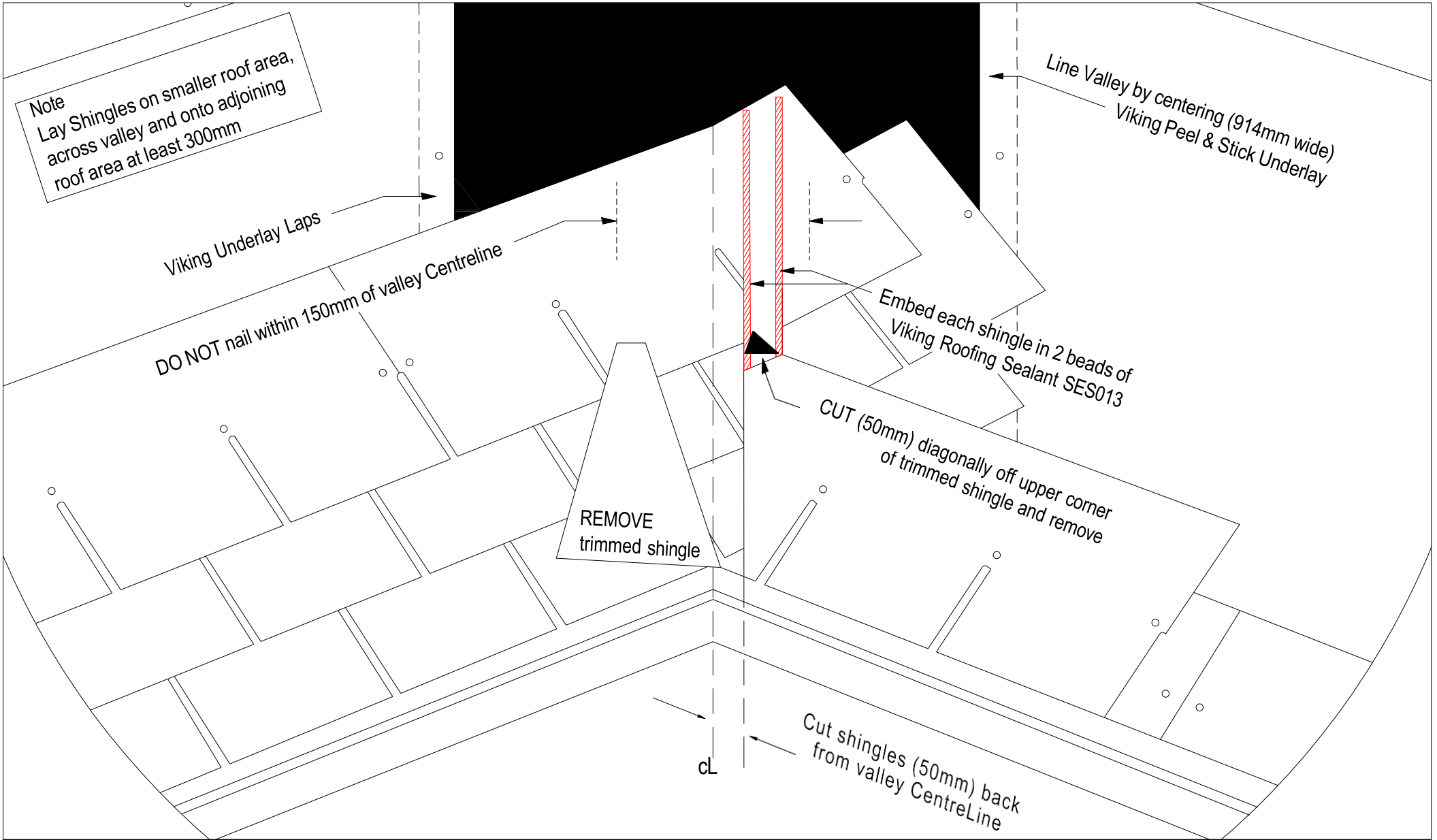

DRAWING TITLE
Viking CertainTeed Shingles Isometric Valley Detail CT08iso

NOTES:
Substrate Indicative Only

DRAWING STATUS			
INFORMATION ONLY			
Not to Scale	DATE 17/11/2016	Detail Ref.	ISSUE
DRAWN	Viking	CT08iso	A

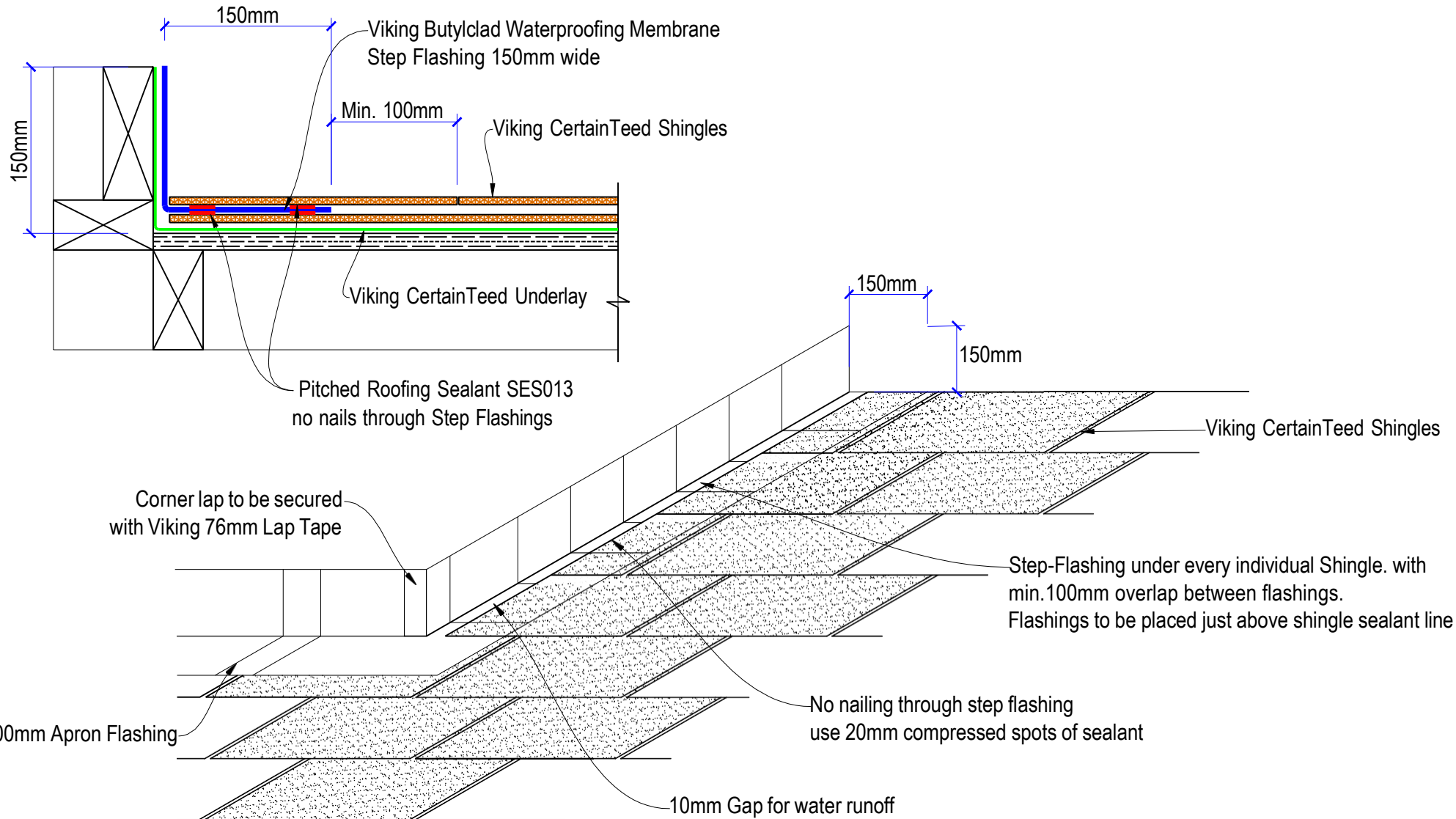

DRAWING TITLE
Viking CertainTeed Shingles Upstand with Step Flashing Detail CT09

NOTES:
Substrate Indicative Only

DRAWING STATUS			
INFORMATION ONLY			
Not to Scale	DATE 17/11/2016	Detail Ref:	ISSUE
DRAWN	Viking	CT09	A

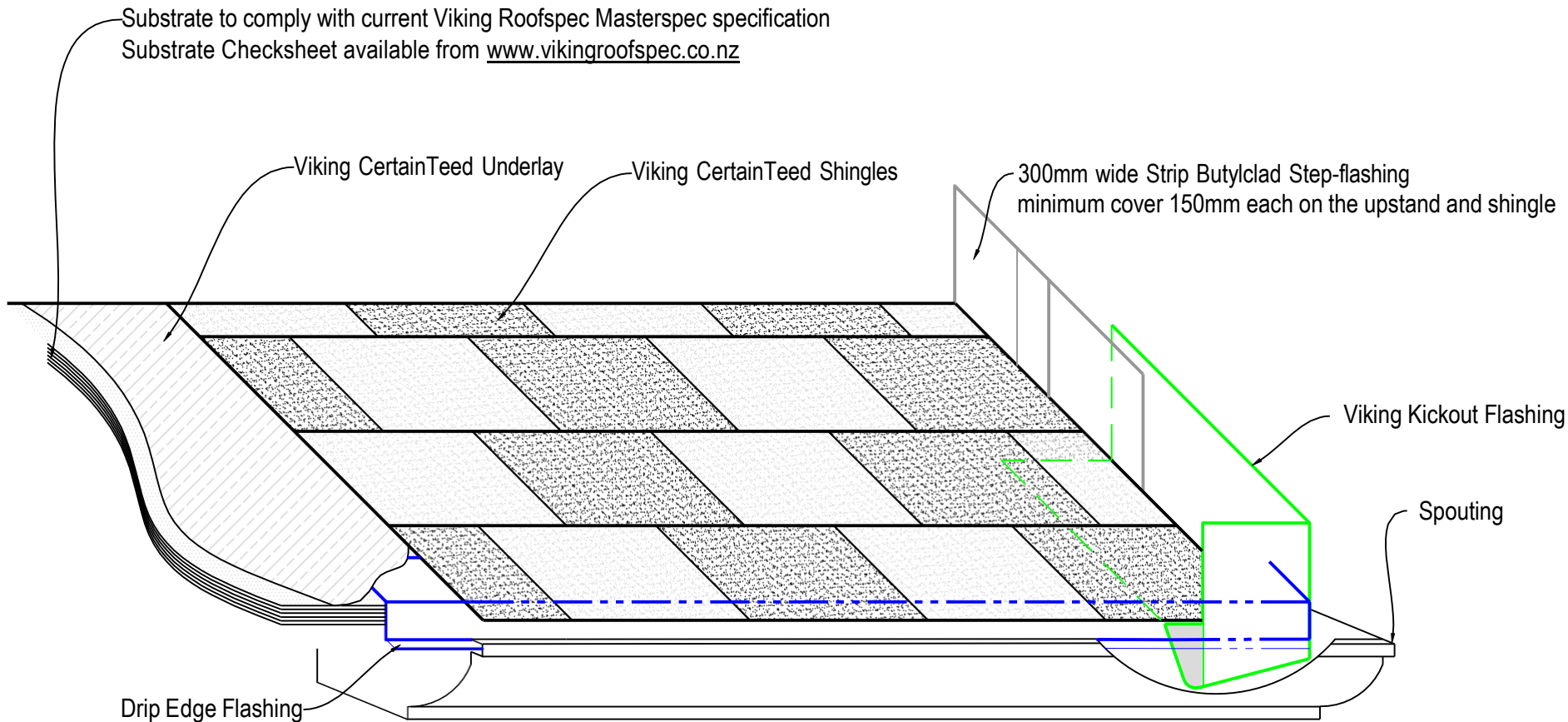

DRAWING TITLE
Viking CertainTeed Shingles Drip-edge with Diverter Detail CT10

NOTES:
Substrate Indicative Only

DRAWING STATUS			
INFORMATION ONLY			
Not to Scale	DATE 17/11/2016	Detail Ref:	ISSUE
DRAWN	Viking	CT10	A

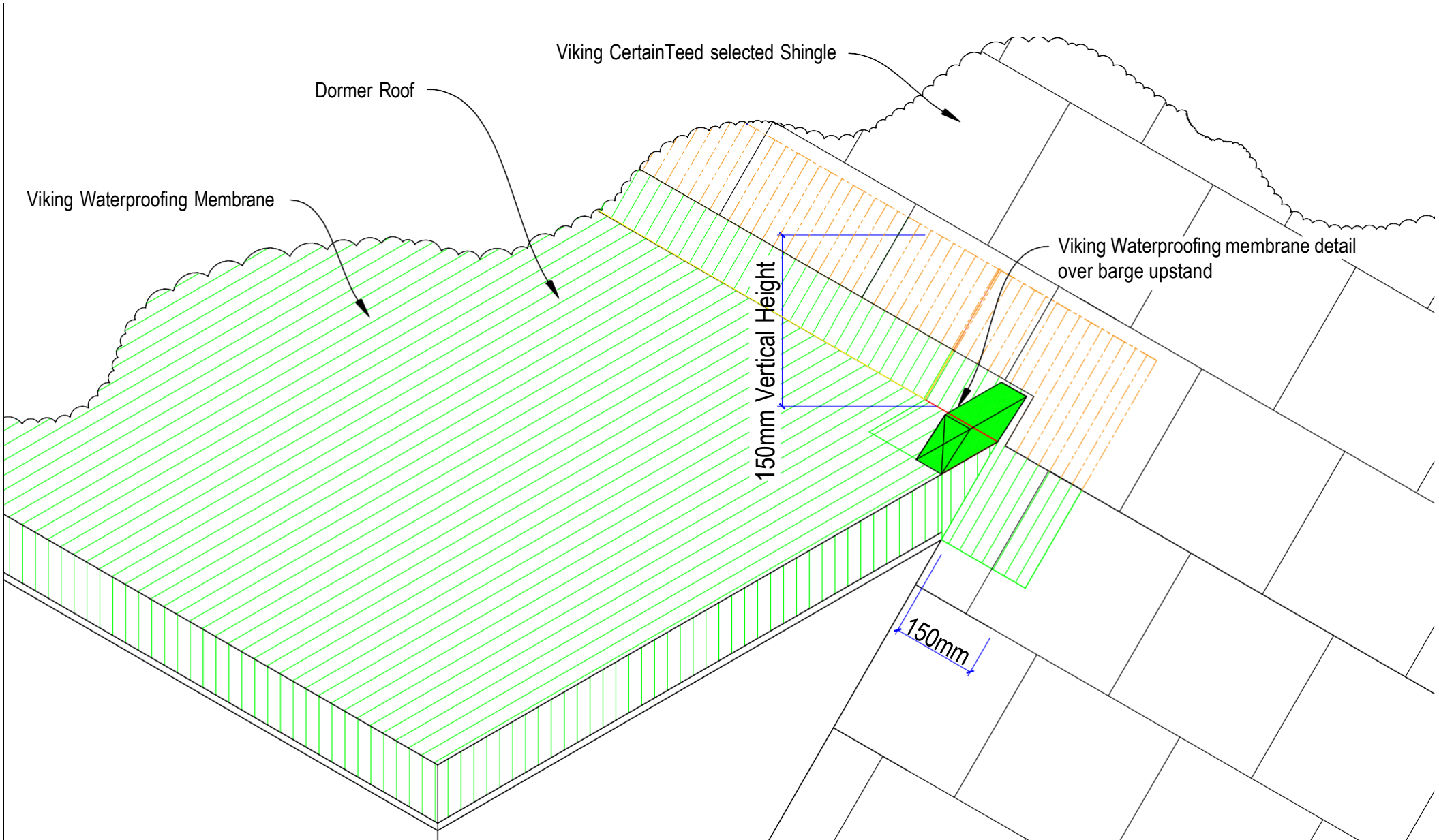

DRAWING TITLE
Viking CertainTeed Shingles Dormer to shingle junction Detail CT11

NOTES:
Substrate Indicative Only

DRAWING STATUS			
INFORMATION ONLY			
Not to Scale	DATE 17/11/2016	Detail Ref:	ISSUE
DRAWN	Viking	CT11	A

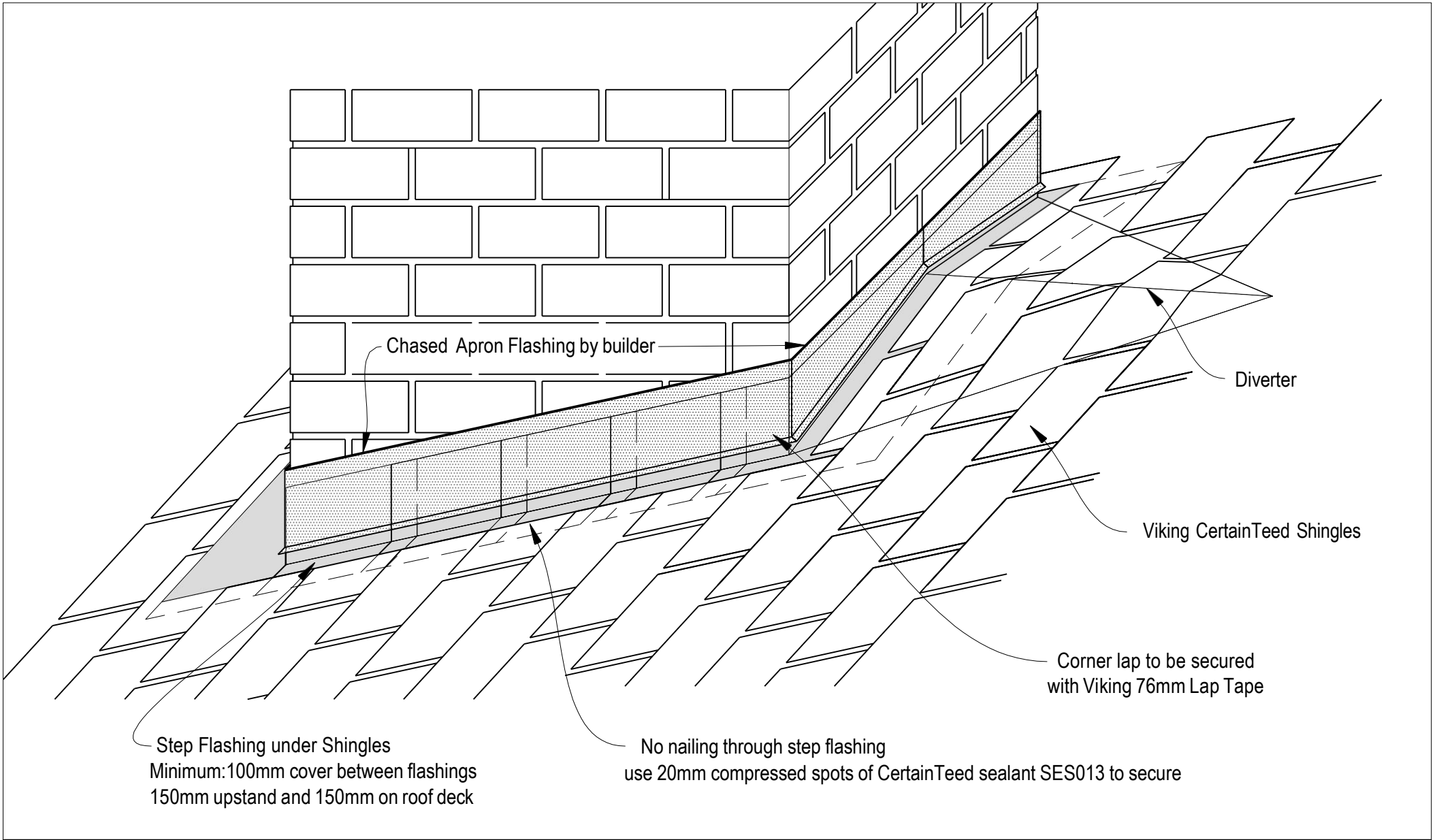

DRAWING TITLE	
Viking CertainTeed Shingles Chimney and Chase Flashing Detail CT12	
DRAWN	

NOTES:
Substrate Indicative Only

DRAWING STATUS			
INFORMATION ONLY			
Not to Scale	DATE	Detail Ref.	ISSUE
	17/11/2016	CT12	A
DRAWN	Viking		
	DATE	7/11/2016	Vikin

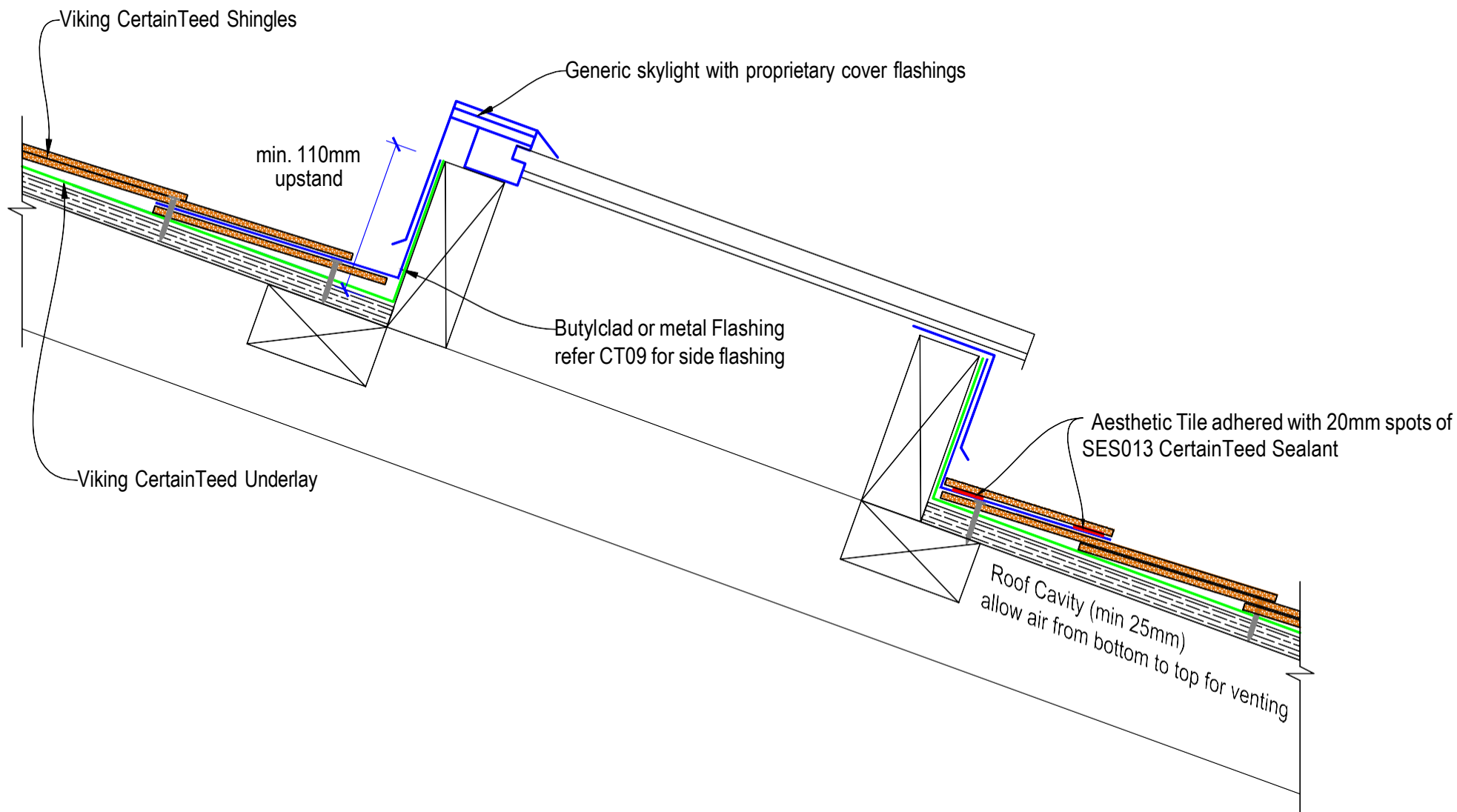

DRAWING TITLE
Viking CertainTeed Shingles Skylight Detail CT13

NOTES:
Substrate Indicative Only

DRAWING STATUS			
<b>INFORMATION ONLY</b>			
Not to Scale	DATE 17/11/2016	Detail Ref:	ISSUE
DRAWN	Viking	CT13	A

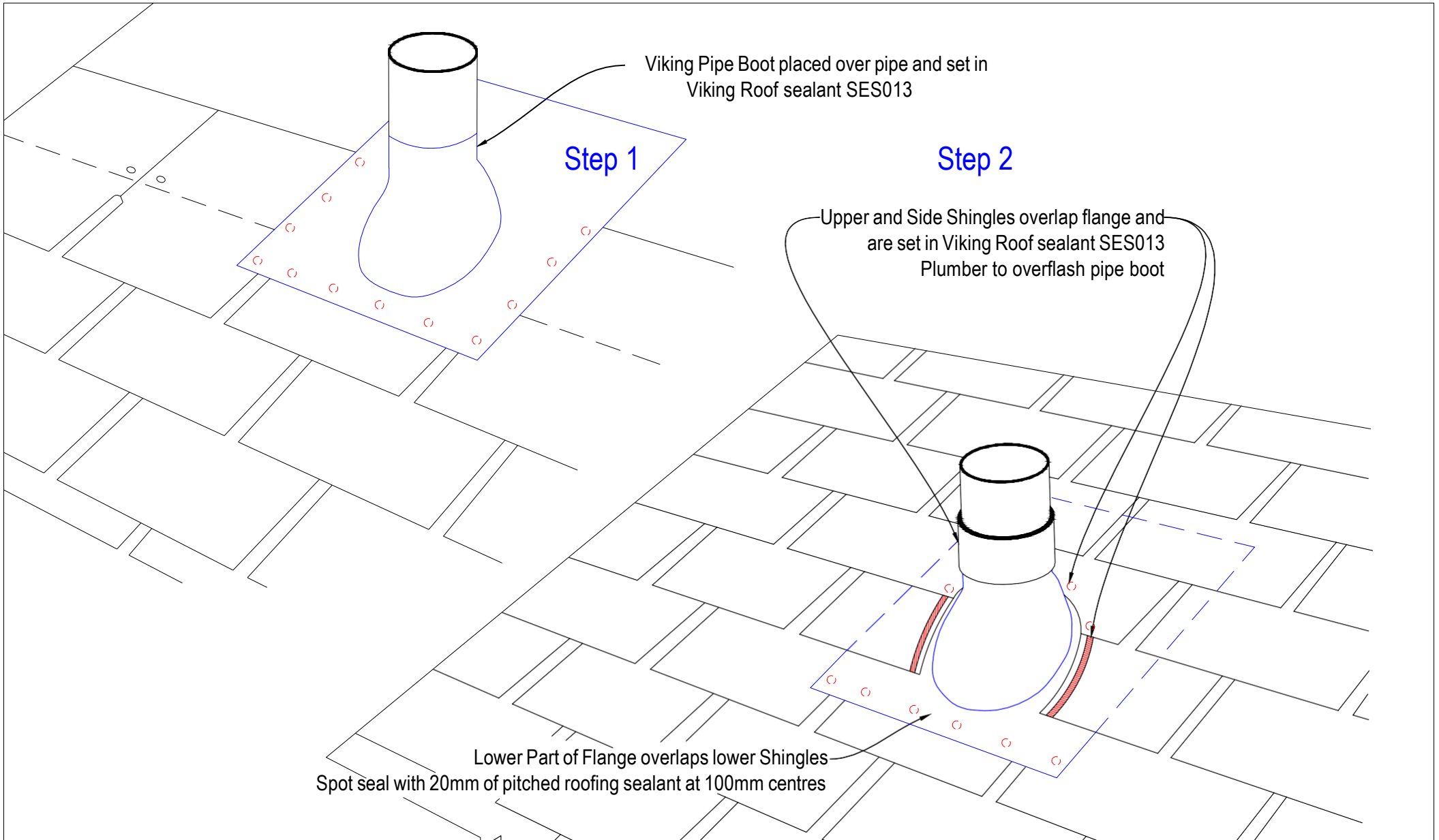

DRAWING TITLE
Viking CertainTeed Shingles Pipe Penetration Detail CT15

NOTES:
Substrate Indicative Only

DRAWING STATUS			
<b>INFORMATION ONLY</b>			
Not to Scale	DATE 17/11/2016	Detail Ref:	ISSUE
DRAWN Viking	CT15		A

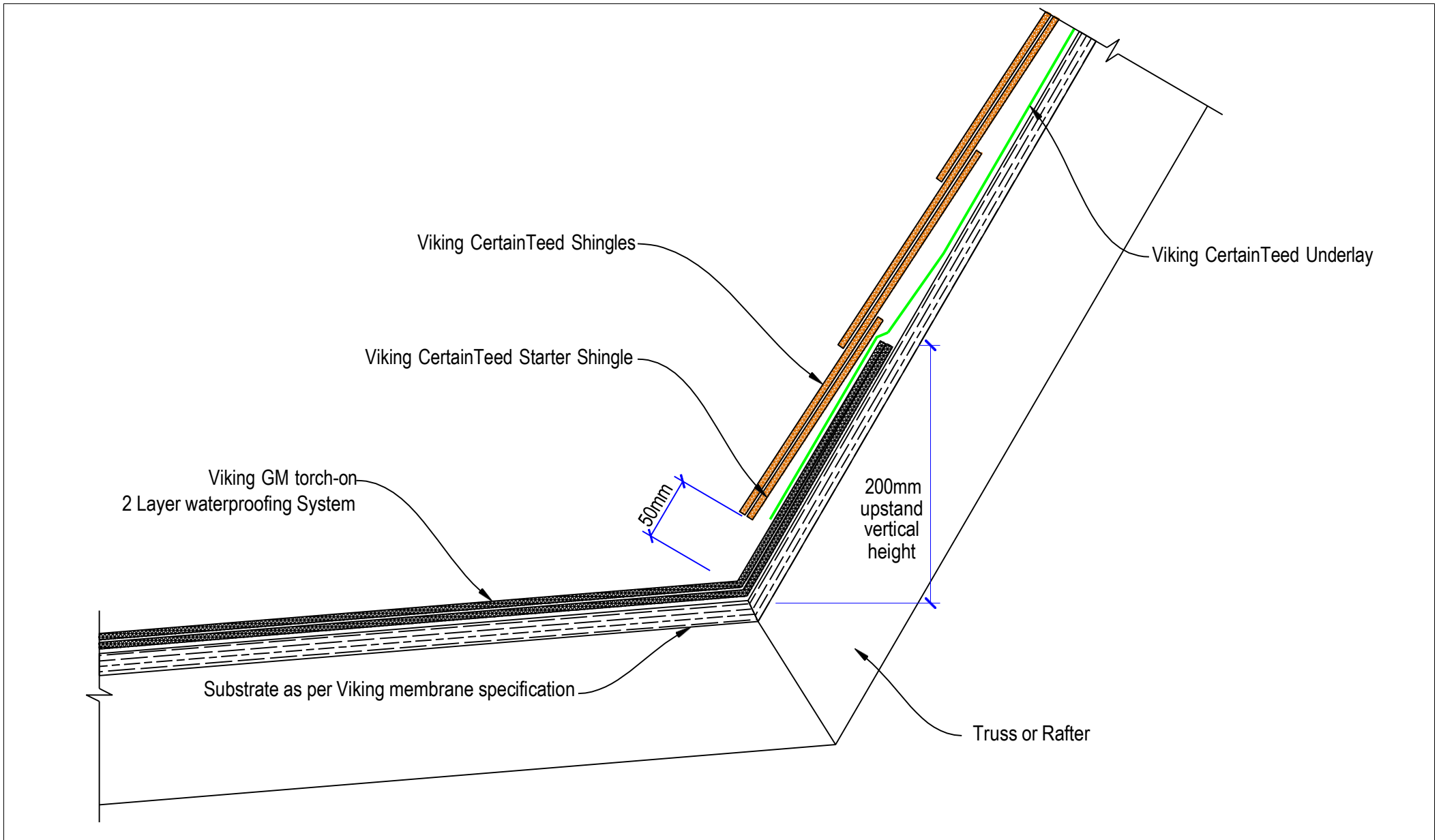

DRAWING TITLE
Viking CertainTeed Shingles Membrane roof to Pitched roof CT16

NOTES:
Substrate Indicative Only

DRAWING STATUS			
INFORMATION ONLY			
Not to Scale	DATE 17/11/2016	Detail Ref:	ISSUE
DRAWN	Viking	CT16	A

- \* Roof pitch 9° - 12° use only Viking Peel & Stick underlay.
- Roof Pitch 12° - 18° use either Viking Peel & Stick or double layer of Viking Synthetic Underlay
- Roof Pitch 18° + single layer of Viking Synthetic Underlay is suitable

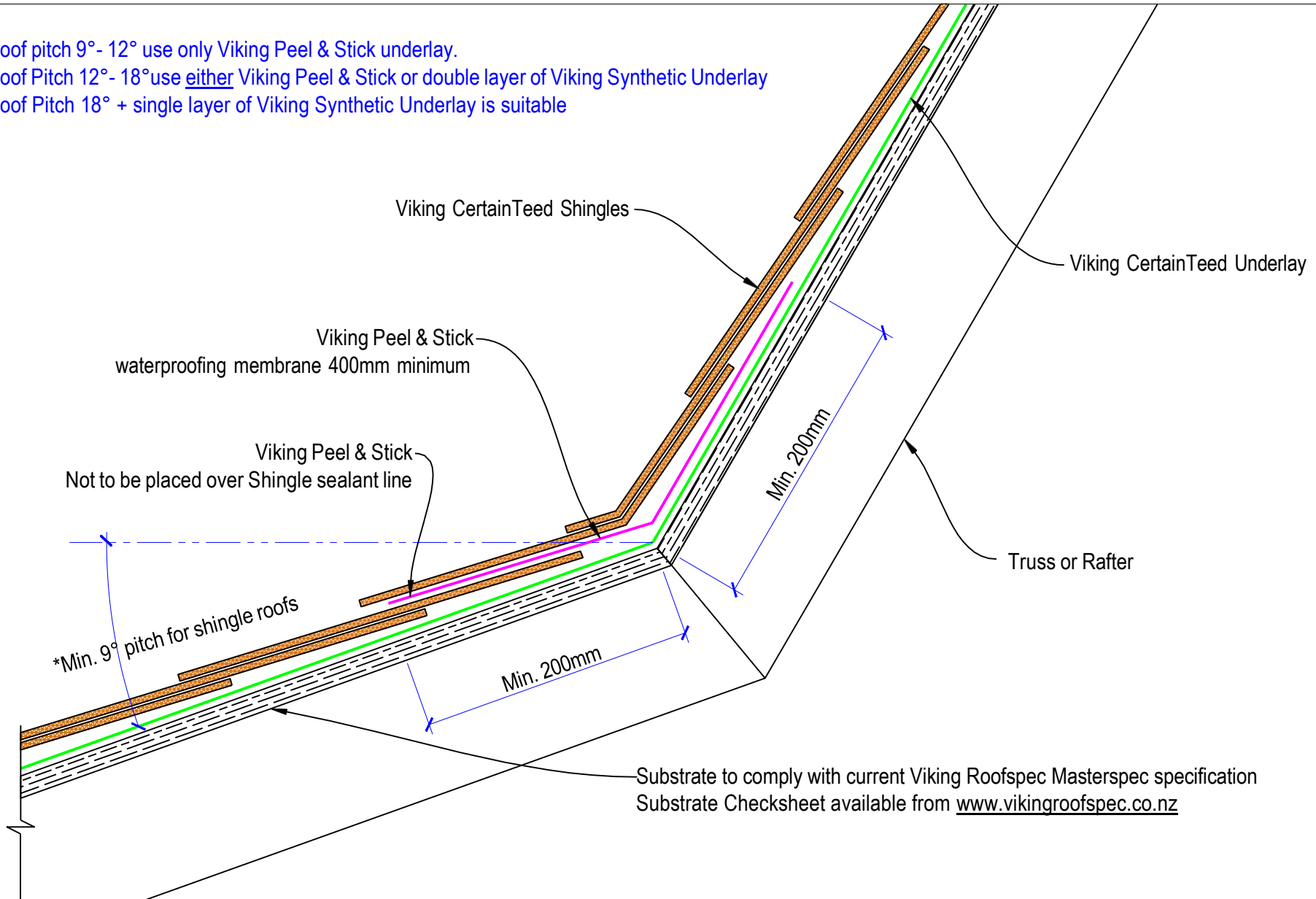

	DRAWING TITLE	NOTES:	DRAWING STATUS		
	Viking CertainTeed Shingles Shingle Change in Pitch Detail CT17	Substrate Indicative Only	INFORMATION ONLY		
			Not to Scale	DATE 17/11/2016	Detail Ref: CT17
			DRAWN Viking		

- \* Roof pitch 9° - 12° use only Viking Peel & Stick underlay.
- Roof Pitch 12° - 18° use either Viking Peel & Stick or double layer of Viking Synthetic Underlay
- Roof Pitch 18° + single layer of Viking Synthetic Underlay is suitable

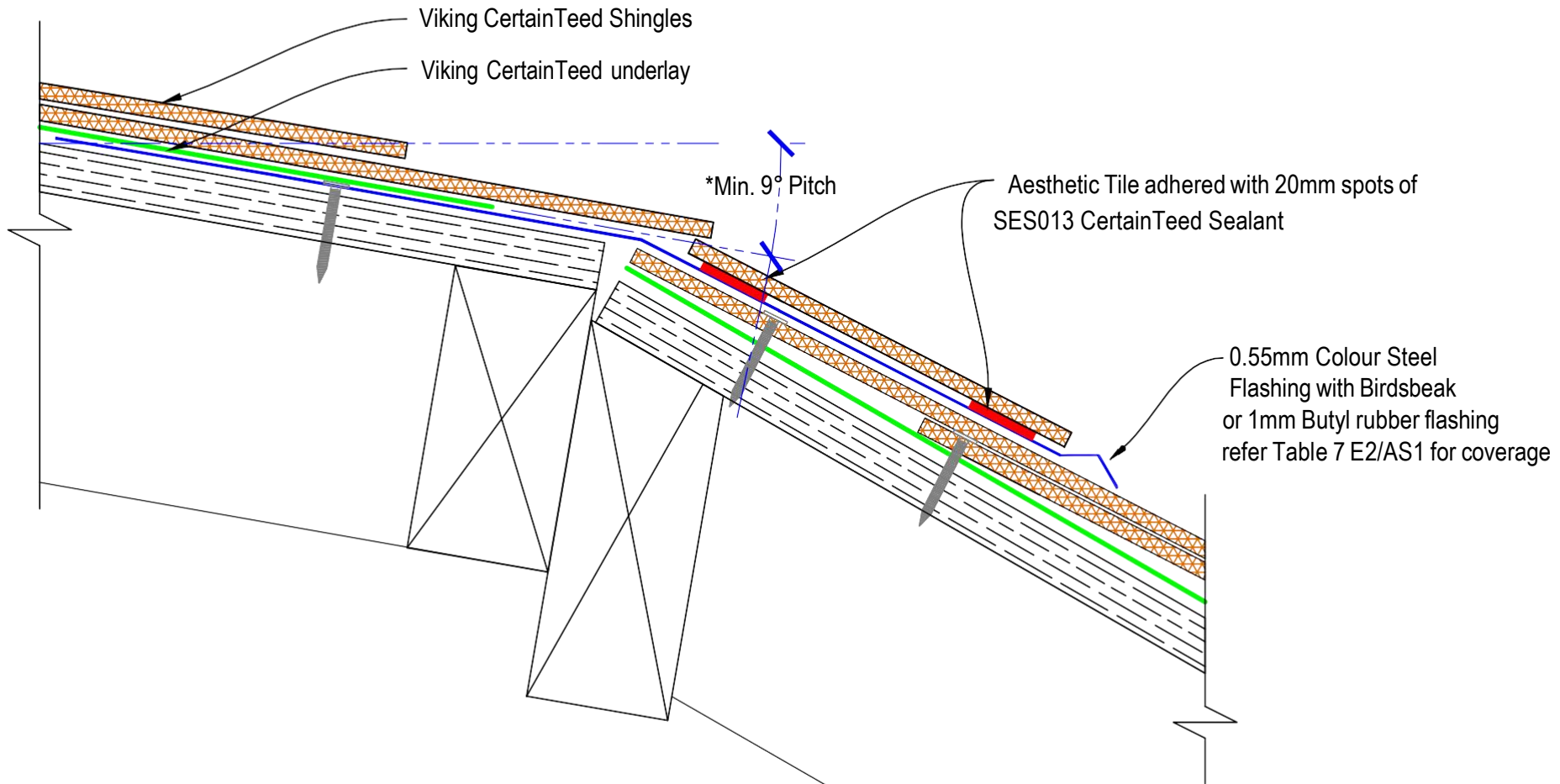

DRAWING TITLE	
Viking CertainTeed Shingles Non-Vented Mansard / Change in Pitch CT18	

NOTES:
Substrate Indicative Only

DRAWING STATUS			
INFORMATION ONLY			
Not to Scale	DATE	Detail Ref	ISSUE
	17/11/2016		
DRAWN	Viking	CT18	A

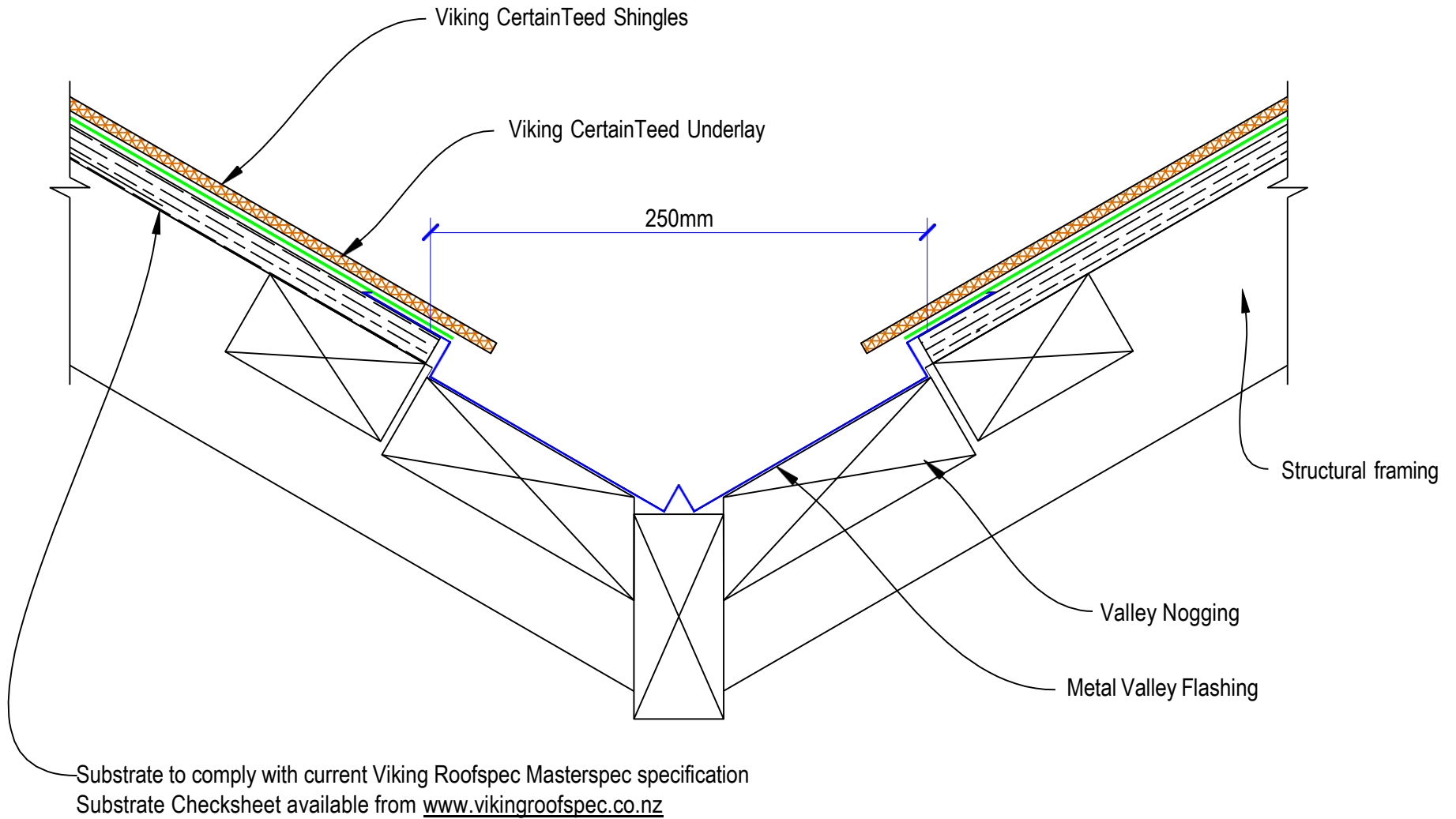

DRAWING TITLE
Viking CertainTeed Shingles Alternative Open Valley Detail CT19

NOTES:
Substrate Indicative Only

DRAWING STATUS			
INFORMATION ONLY			
Not to Scale	DATE 17/11/2016	Detail Ref:	ISSUE
DRAWN	Viking	CT19	A

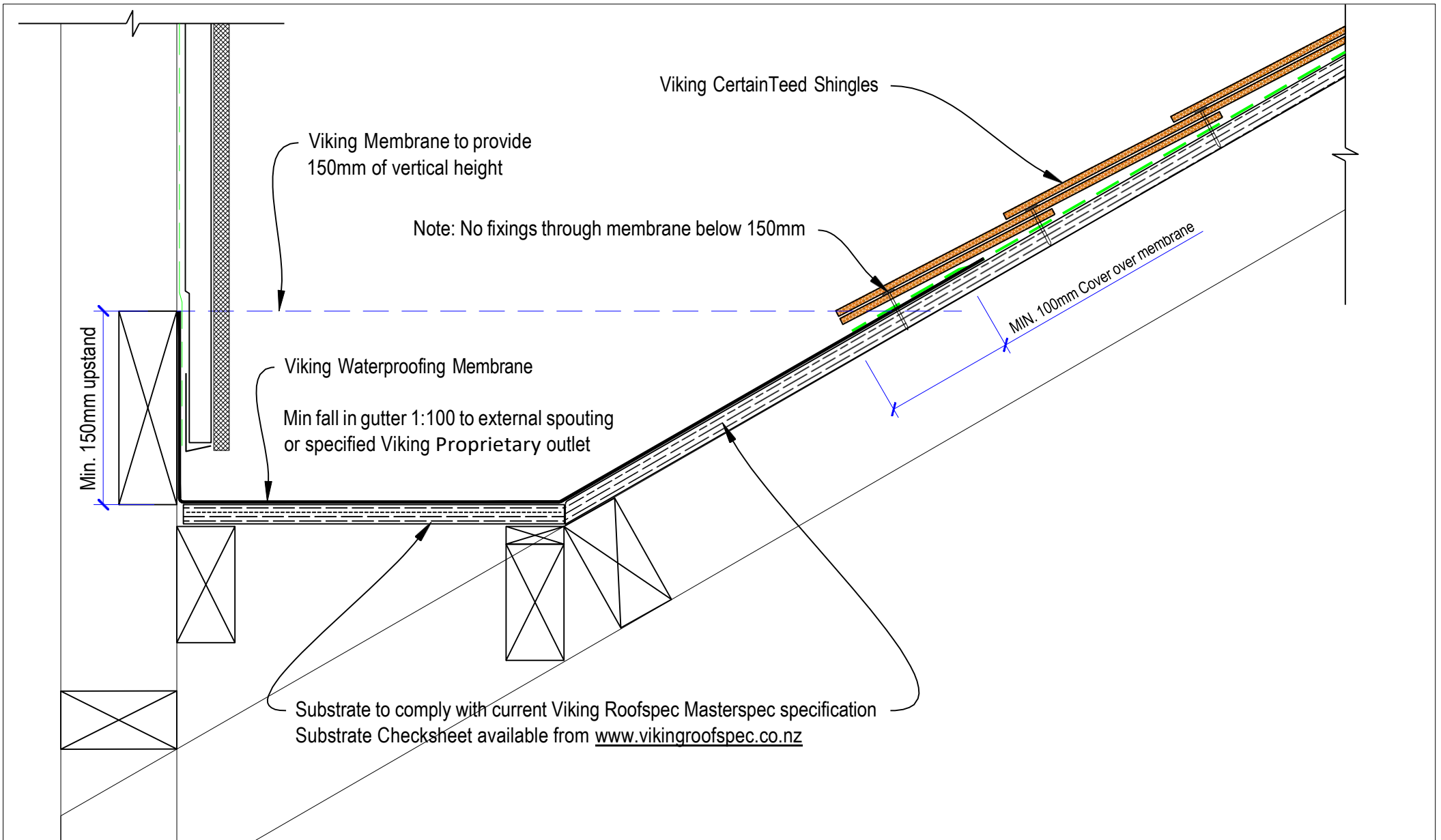

	DRAWING TITLE	NOTES:	DRAWING STATUS		
	Viking CertainTeed Shingles Internal Gutter CT20	Substrate Indicative Only	INFORMATION ONLY		
			Not to Scale	DATE 17/11/2016	Detail Ref. CT20
			DRAWN Viking		

**NOTE:**  
 This detail is to show a methodology for Saddle-flashings and kick-out diverters at junctions.  
 These Saddle-flashings are not supplied by Viking Roofspec as they are fabricated for specific junctions by others to fit various junctions and cladding needs.

**NOTE: 2**  
 Refer Viking Typical details for vented apron details etc.

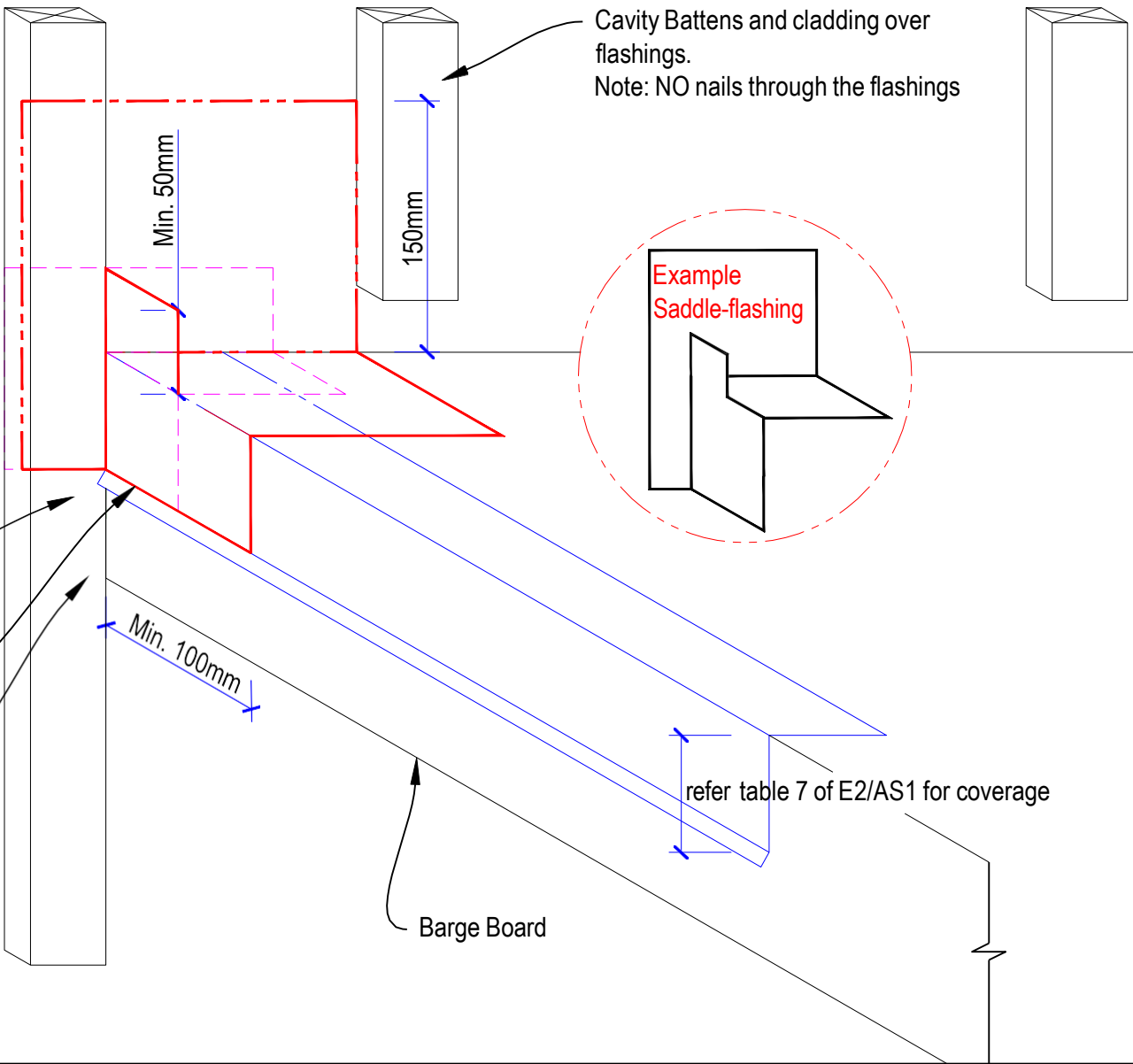

Stage 1 Flexible Flashing tape adhered to wall underlay at rear of cavity minimum 50mm to all surfaces

Barge Flashing

Step 3  
 Fabricated Saddle-flashing fitted over flexible flashing tape behind the cavity.  
 Size & depth of diverter to suit specified cladding preventing water ingress entering behind cladding and cavity

Cavity Battens and cladding over flashings.  
 Note: NO nails through the flashings

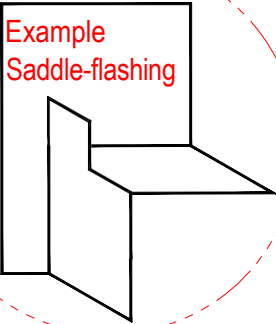

refer table 7 of E2/AS1 for coverage

Barge Board



DRAWING TITLE	
Viking CertainTeed Shingles Saddle-flashing Methodology CT21	

NOTES:
Substrate Indicative Only

DRAWING STATUS			
INFORMATION ONLY			
Not to Scale	DATE	Detail Ref:	ISSUE
	17/11/2016	CT21	A
DRAWN	Viking		