

Viking Enviroclad TPO
waterproofing membrane 1.52 mm

Viking Cover Board

Viking 80mmØ clamped drain
SDM049 with 304 S/S domed
grate

Viking 80mmØ clamped overflow
drain SDM049 with 304 S/S
domed grate

Viking Vapour Barrier

Substrate as specified

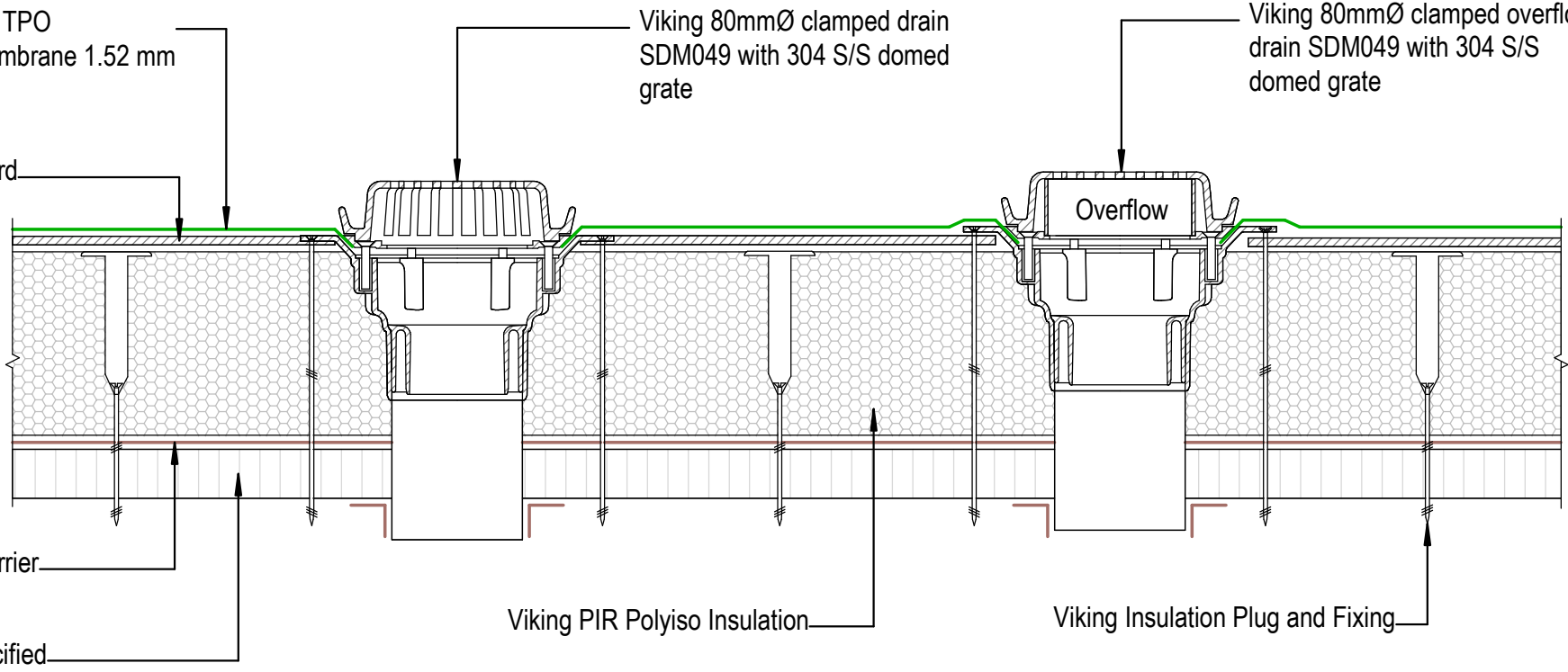

Viking PIR Polyiso Insulation

Viking Insulation Plug and Fixing

NOTE:

Substrate to comply with current Viking Roofspec
Masterspec specification
Substrate Checksheet available from
www.vikingroofspec.co.nz

NOTE:

1/ Overflow to match outlet capacity.
2/ Overflow to be plumbed independent of
stormwater, through soffit or exterior wall

DRAWING TITLE

Viking WS2 - Enviroclad
Penetration_Outlet and Overflow

NOTES:

- * Angle fillets are not required at upstands for Enviroclad
- * All fixings, cladding and structure are indicative only unless noted
- * All details to be read in conjunction with Viking Specifications

Substrate and structure are
indicative only

DRAWING STATUS

INFORMATION ONLY

Scale: Not to Scale	Date: 01/10/2022	Drawn:	Viking
Detail Ref: VIK_WS2_ENV_001_PENEOUTL			